

SITE PLAN AS BUILT

1388110. OFFICE OF COUNTY RECORDS STATE OF MINNESOTA, COUNTY OF ANOKA I hereby certify that the within instrument was filed in this office for record on the 24th day of NOVEMBER, 1998 at 3:10 o'clock P.M., and was duly recorded in book 2 CIV page 44 Edward M. Treska County Recorder JAM Deputy

CIC NUMBER 38 RIVER VILLAGE ESTATES CONDOMINIUM FOURTH SUPPLEMENTAL CIC PLAT

This FOURTH SUPPLEMENTAL CIC PLAT is part of the declaration recorded as Doc. No. \_\_\_\_\_ on the \_\_\_\_\_ day of \_\_\_\_\_, 1998

CITY OF COON RAPIDS COUNTY OF ANOKA

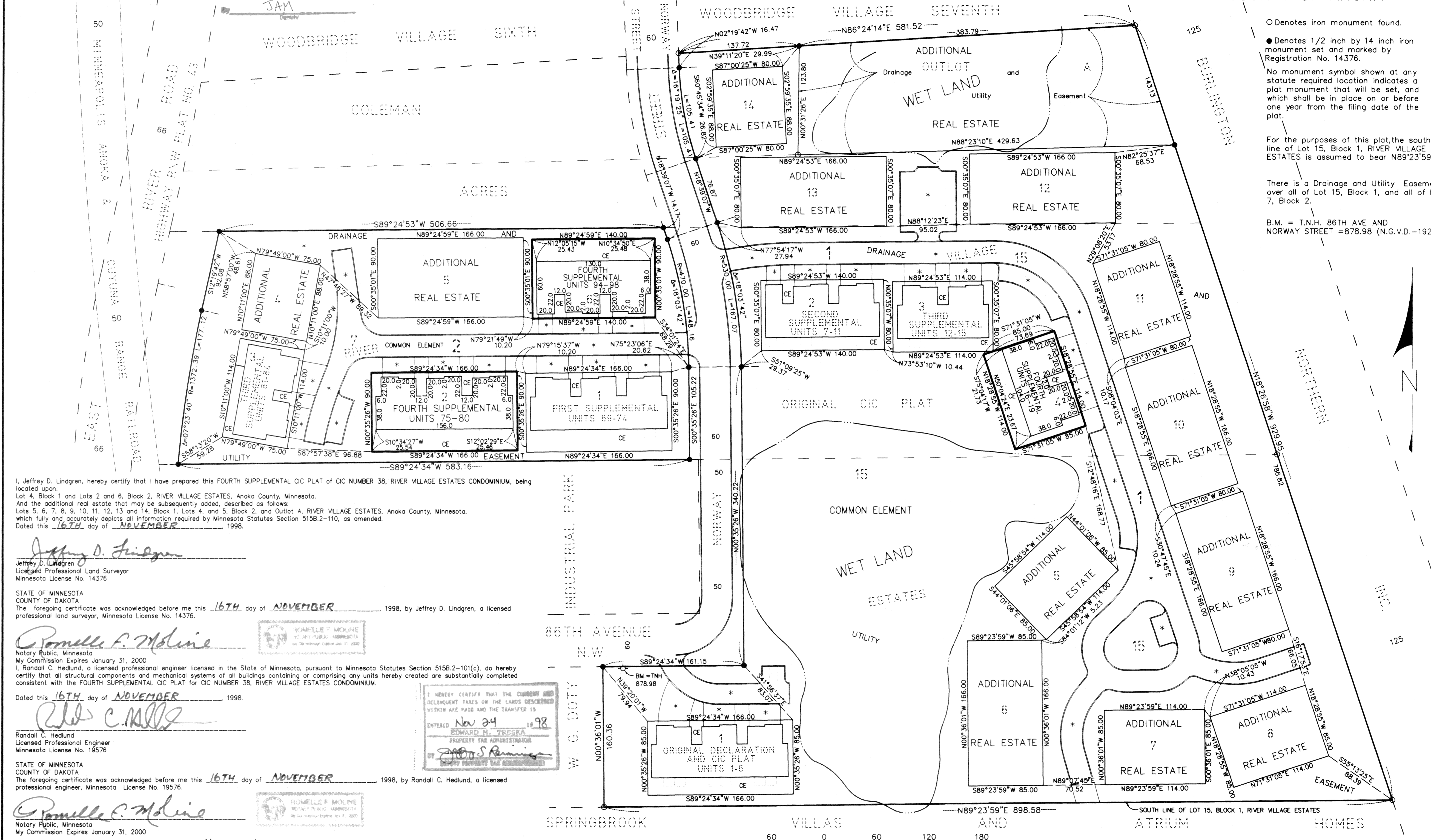

○ Denotes iron monument found. ● Denotes 1/2 inch by 14 inch iron monument set and marked by Registration No. 14376. No monument symbol shown at any statute required location indicates a plat monument that will be set, and which shall be in place on or before one year from the filing date of the plat.

For the purposes of this plat, the south line of Lot 15, Block 1, RIVER VILLAGE ESTATES is assumed to bear N89°23'59"E

There is a Drainage and Utility Easement over all of Lot 15, Block 1, and all of Lot 7, Block 2.

B.M. = T.N.H. 86TH AVE AND NORWAY STREET = 878.98 (N.G.V.D. - 1929)

I, Jeffrey D. Lindgren, hereby certify that I have prepared this FOURTH SUPPLEMENTAL CIC PLAT of CIC NUMBER 38, RIVER VILLAGE ESTATES CONDOMINIUM, being located upon Lot 4, Block 1 and Lots 2 and 6, Block 2, RIVER VILLAGE ESTATES, Anoka County, Minnesota. And the additional real estate that may be subsequently added, described as follows: Lots 5, 6, 7, 8, 9, 10, 11, 12, 13 and 14, Block 1, Lots 4, and 5, Block 2, and Outlot A, RIVER VILLAGE ESTATES, Anoka County, Minnesota, which fully and accurately depicts all information required by Minnesota Statutes Section 515B.2-110, as amended. Dated this 16TH day of NOVEMBER 1998.

Jeffrey D. Lindgren Licensed Professional Land Surveyor Minnesota License No. 14376

STATE OF MINNESOTA COUNTY OF DAKOTA The foregoing certificate was acknowledged before me this 16TH day of NOVEMBER 1998, by Jeffrey D. Lindgren, a licensed professional land surveyor, Minnesota License No. 14376.

Ronelle F. Moline Notary Public, Minnesota My Commission Expires January 31, 2000

I, Randall C. Hedlund, a licensed professional engineer licensed in the State of Minnesota, pursuant to Minnesota Statutes Section 515B.2-101(c), do hereby certify that all structural components and mechanical systems of all buildings containing or comprising any units hereby created are substantially completed consistent with the FOURTH SUPPLEMENTAL CIC PLAT for CIC NUMBER 38, RIVER VILLAGE ESTATES CONDOMINIUM. Dated this 16TH day of NOVEMBER 1998.

Randall C. Hedlund Licensed Professional Engineer Minnesota License No. 19576

STATE OF MINNESOTA COUNTY OF DAKOTA The foregoing certificate was acknowledged before me this 16TH day of NOVEMBER 1998, by Randall C. Hedlund, a licensed professional engineer, Minnesota License No. 19576.

Ronelle F. Moline Notary Public, Minnesota My Commission Expires January 31, 2000

This CIC plat has been checked and approved this 24TH day of NOVEMBER 1998.

By: Larry D. ... Anoka County Surveyor

I HEREBY CERTIFY THAT THE CURRENT AND DELINQUENT TAXES ON THE LANDS DESCRIBED WITHIN ARE PAID AND THE TRANSFER IS ENTERED Nov 24 1998 EDWARD M. TRESKA PROPERTY TAX ADMINISTRATOR

- DENOTES CONCRETE CURB (MUST BE BUILT). \* DENOTES BITUMINOUS SURFACE (MUST BE BUILT). CE DENOTES COMMON ELEMENT

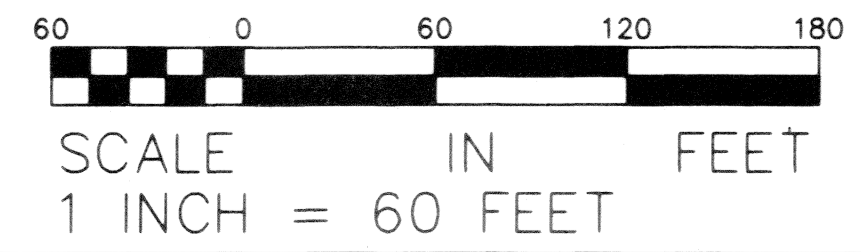

HEDLUND PLANNING ENGINEERING SURVEYING

Receipt # 98115082 \$366.50

# CIC NUMBER 38 RIVER VILLAGE ESTATES CONDOMINIUM FOURTH SUPPLEMENTAL CIC PLAT

COMMON ELEMENT

MAIN LEVEL

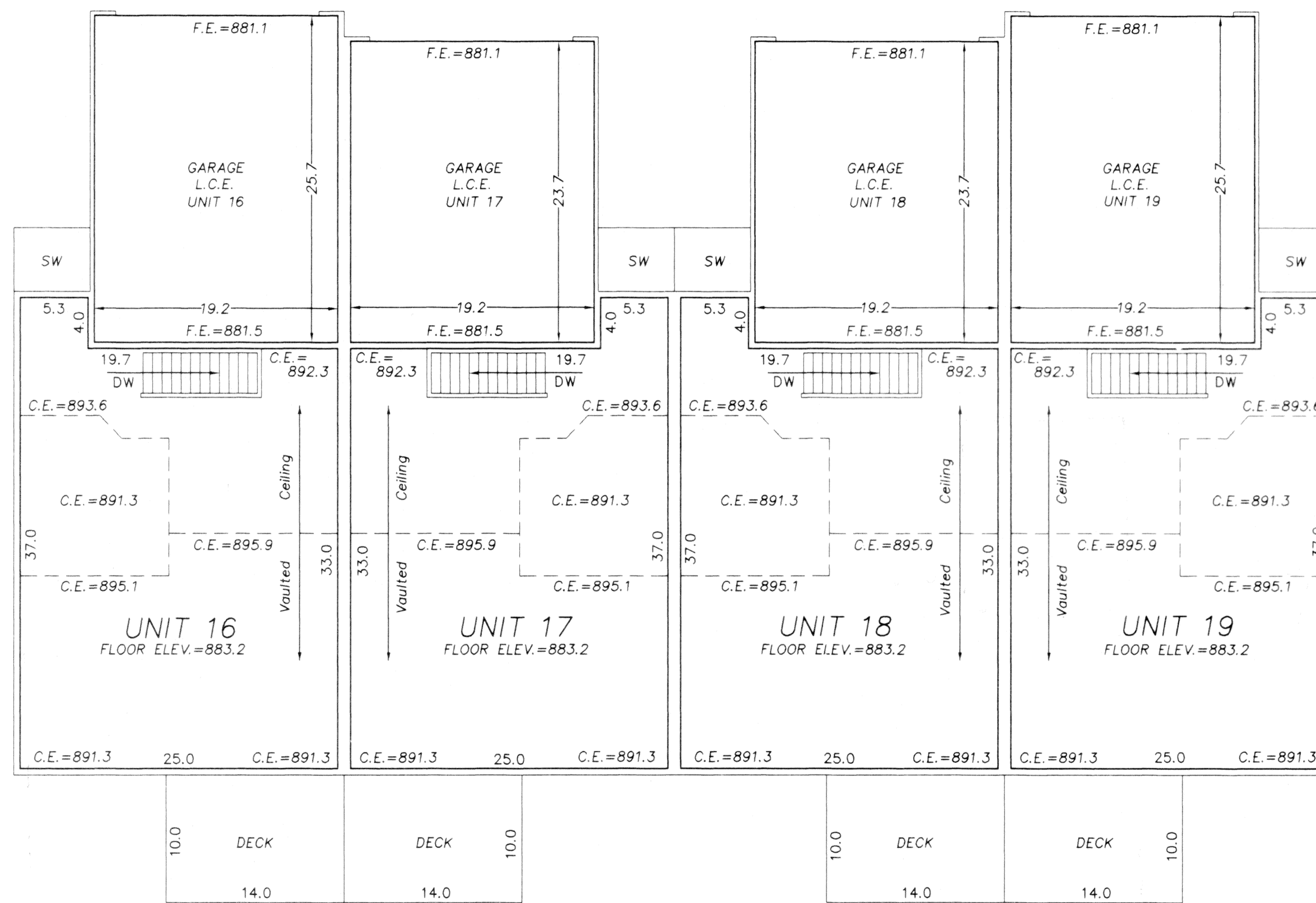

COMMON ELEMENT

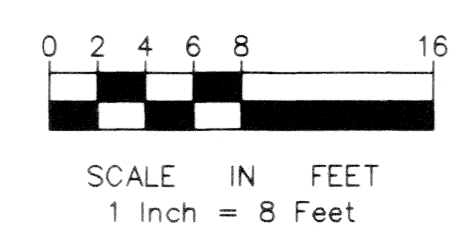
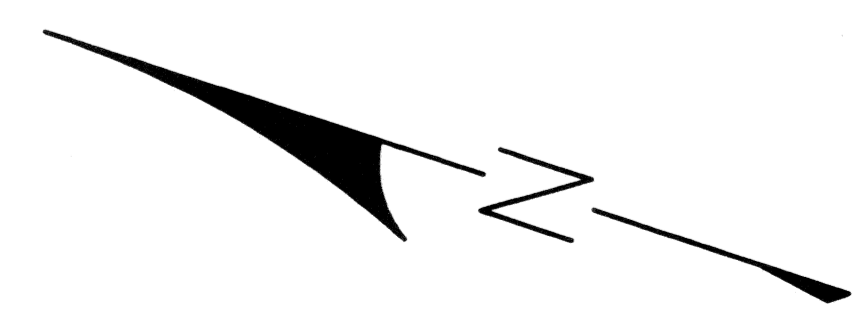

- \* All Sidewalks, Decks and Patios are LIMITED COMMON ELEMENTS assigned to the UNIT adjoining thereto.
- \* L.C.E.- Denotes Limited Common Element
- \* Elevations shown are referenced to a bench mark as denoted on Sheet 1 of 3 Sheets.
- \* All inside finished surface to inside finished surface dimensions and elevations are shown in feet and tenths of a foot.
- \* SW - Denotes Sidewalk
- \* C.E. - Denotes Ceiling Elevation
- \* F.E. - Denotes Floor Elevation

# CIC NUMBER 38 RIVER VILLAGE ESTATES CONDOMINIUM FOURTH SUPPLEMENTAL CIC PLAT

COMMON ELEMENT

LOWER LEVEL

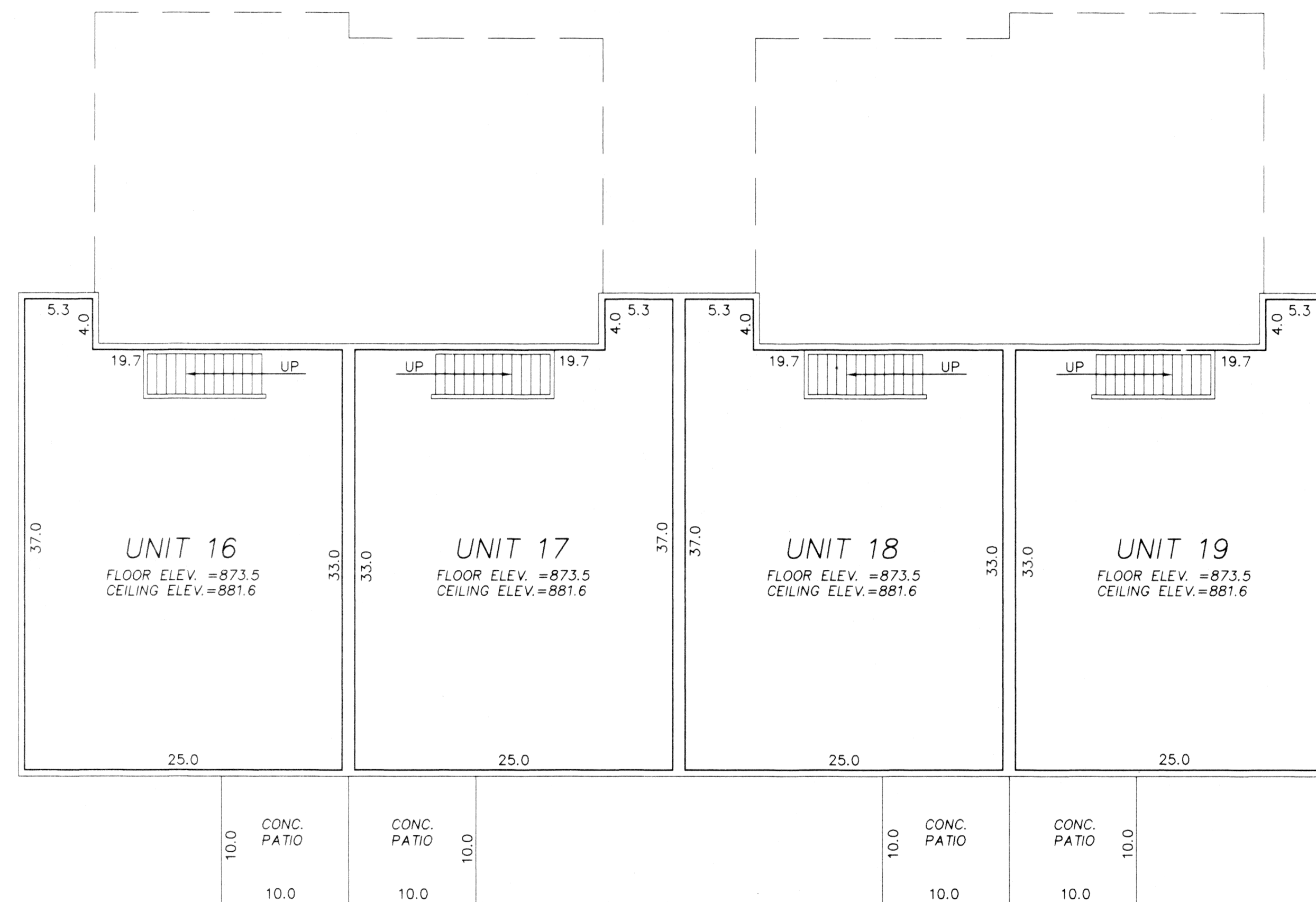

COMMON ELEMENT

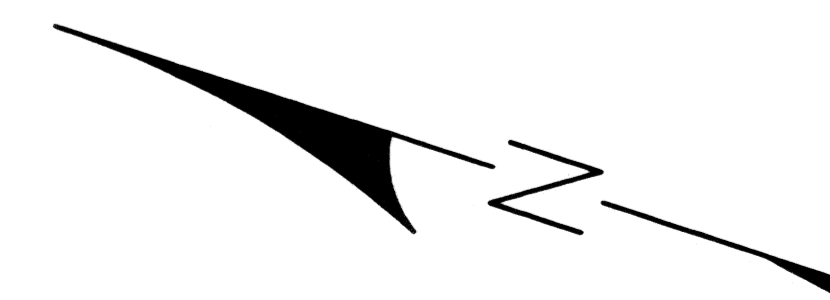

- \* All Sidewalks, Decks and Patios are LIMITED COMMON ELEMENTS assigned to the UNIT adjoining thereto.
- \* L.C.E.- Denotes Limited Common Element
- \* Elevations shown are referenced to a bench mark as denoted on Sheet 1 of 3 Sheets.
- \* All inside finished surface to inside finished surface dimensions and elevations are shown in feet and tenths of a foot.
- \* SW - Denotes Sidewalk
- \* C.E. - Denotes Ceiling Elevation
- \* F.E. - Denotes Floor Elevation

# CIC NUMBER 38 RIVER VILLAGE ESTATES CONDOMINIUM FOURTH SUPPLEMENTAL CIC PLAT

COMMON ELEMENT

MAIN LEVEL

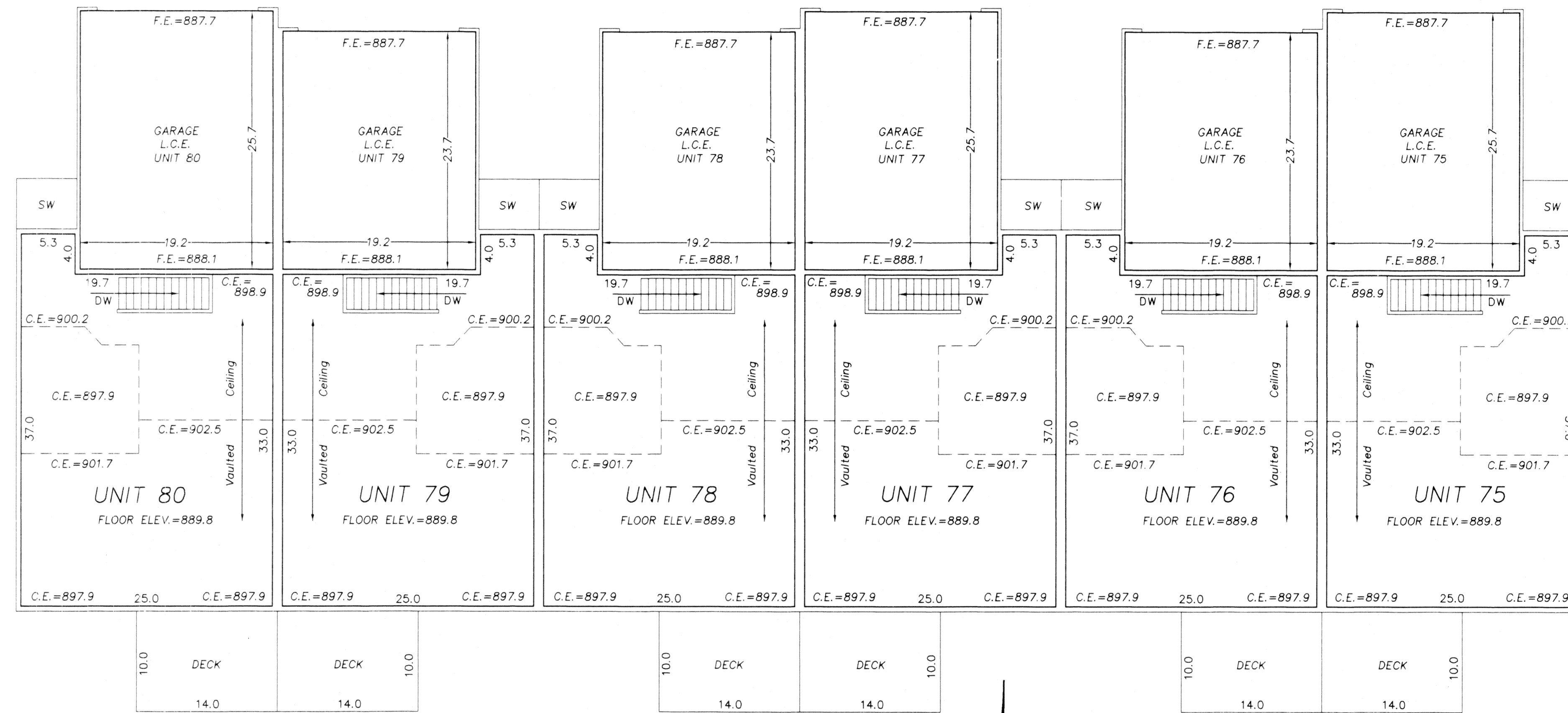

COMMON ELEMENT

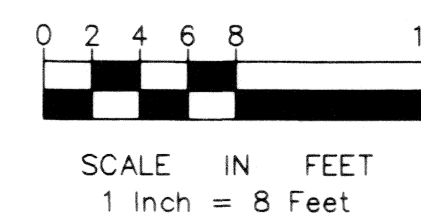

- \* All Sidewalks, Decks and Patios are LIMITED COMMON ELEMENTS assigned to the UNIT adjoining thereto.
- \* L.C.E.- Denotes Limited Common Element
- \* Elevations shown are referenced to a bench mark as denoted on Sheet 1 of 3 Sheets.
- \* All inside finished surface to inside finished surface dimensions and elevations are shown in feet and tenths of a foot.
- \* SW - Denotes Sidewalk
- \* C.E. - Denotes Ceiling Elevation
- \* F.E. - Denotes Floor Elevation

# CIC NUMBER 38 RIVER VILLAGE ESTATES CONDOMINIUM FOURTH SUPPLEMENTAL CIC PLAT

COMMON ELEMENT

LOWER LEVEL

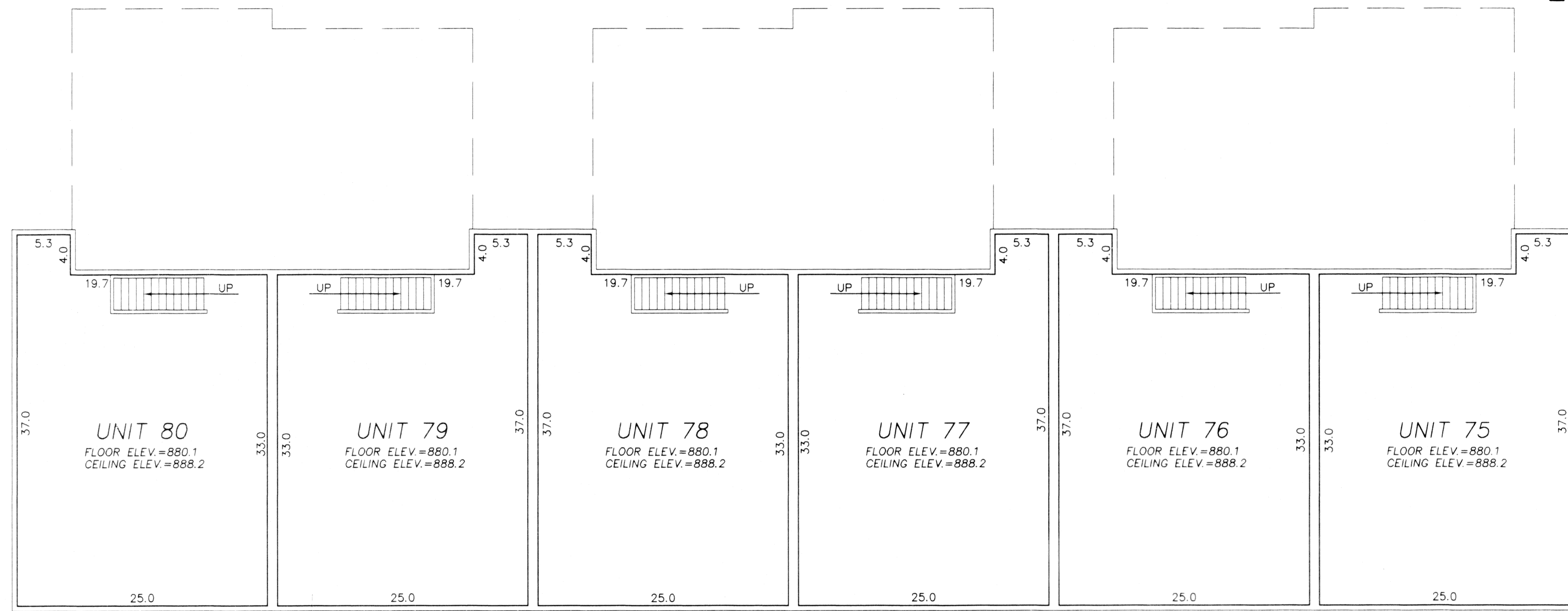

COMMON ELEMENT

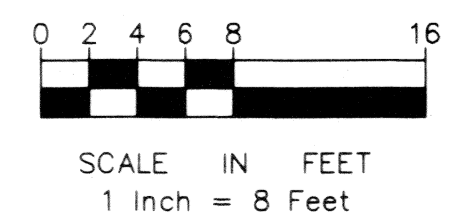

- \* All Sidewalks, Decks and Patios are LIMITED COMMON ELEMENTS assigned to the UNIT adjoining thereto.
- \* L.C.E. - Denotes Limited Common Element
- \* Elevations shown are referenced to a bench mark as denoted on Sheet 1 of 3 Sheets.
- \* All inside finished surface to inside finished surface dimensions and elevations are shown in feet and tenths of a foot.
- \* SW - Denotes Sidewalk
- \* C.E. - Denotes Ceiling Elevation
- \* F.E. - Denotes Floor Elevation

# CIC NUMBER 38 RIVER VILLAGE ESTATES CONDOMINIUM FOURTH SUPPLEMENTAL CIC PLAT

COMMON ELEMENT

MAIN LEVEL

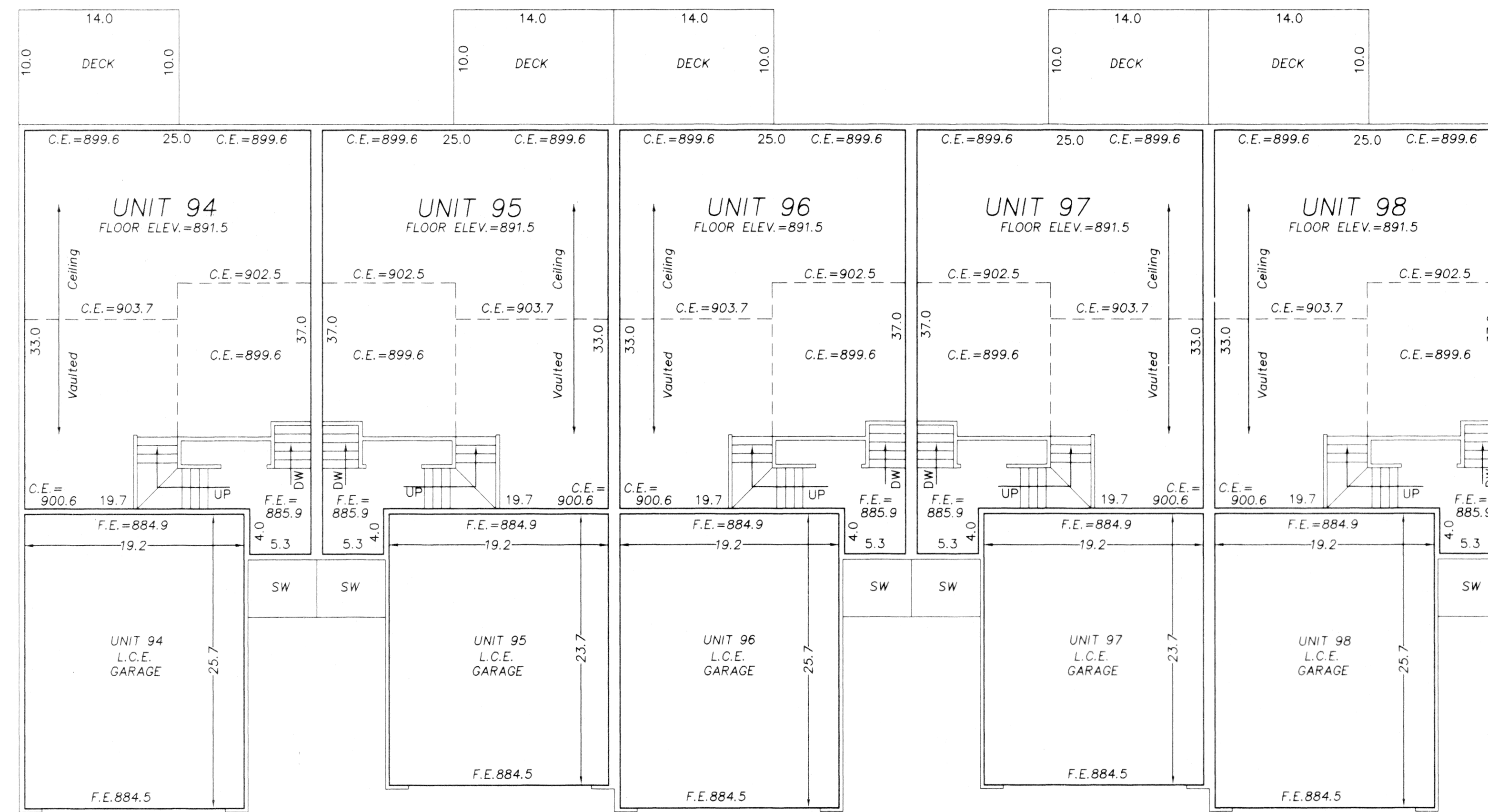

COMMON ELEMENT

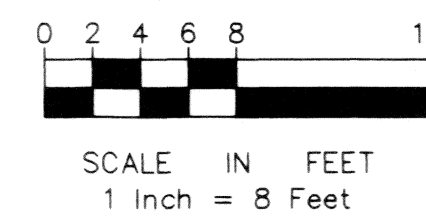

- \* All Sidewalks, Decks and Patios are LIMITED COMMON ELEMENTS assigned to the UNIT adjoining thereto.
- \* L.C.E.- Denotes Limited Common Element
- \* Elevations shown are referenced to a bench mark as denoted on Sheet 1 of 3 Sheets.
- \* All inside finished surface to inside finished surface dimensions and elevations are shown in feet and tenths of a foot.
- \* SW - Denotes Sidewalk
- \* C.E. - Denotes Ceiling Elevation
- \* F.E. - Denotes Floor Elevation

# CIC NUMBER 38 RIVER VILLAGE ESTATES CONDOMINIUM FOURTH SUPPLEMENTAL CIC PLAT

COMMON ELEMENT

LOWER LEVEL

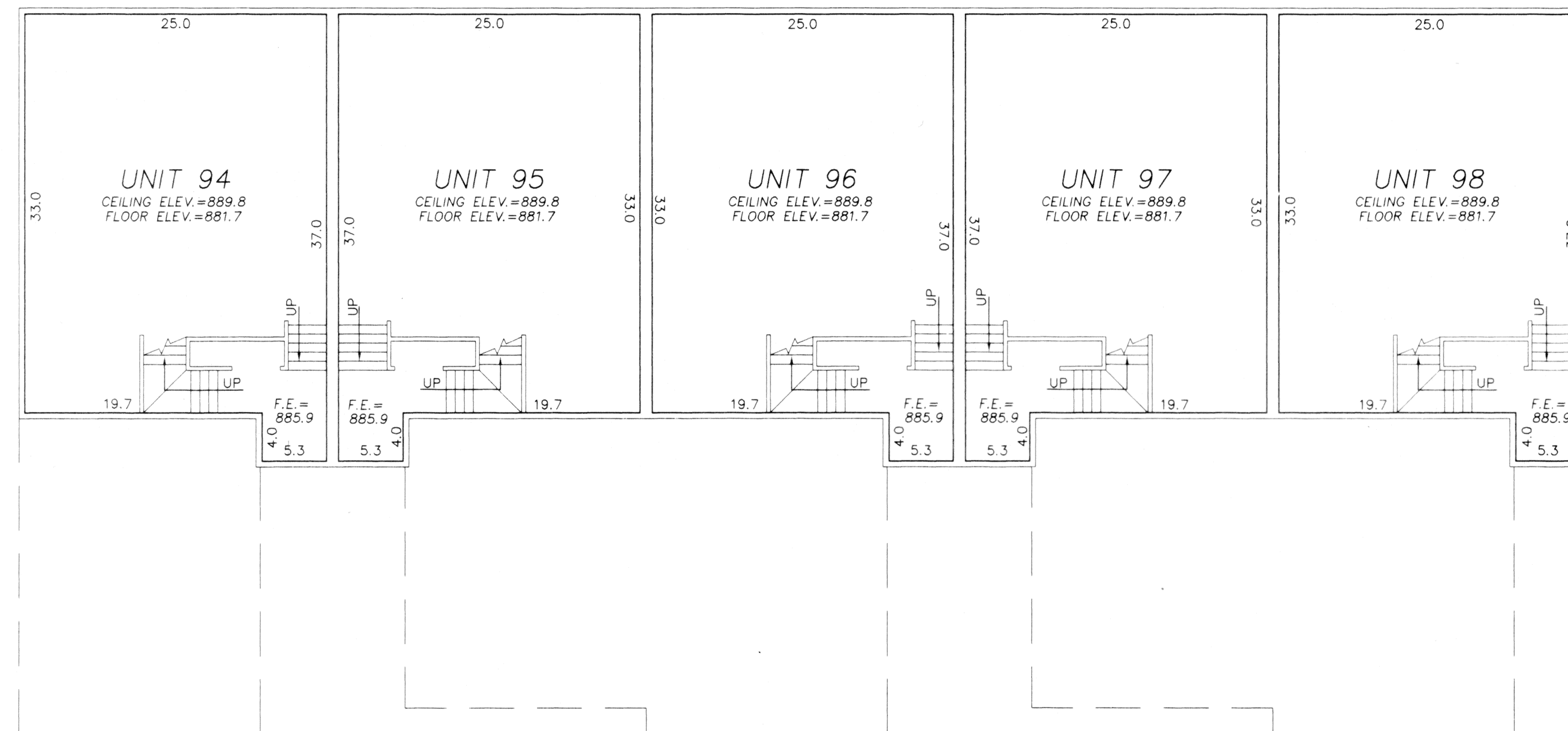

COMMON ELEMENT

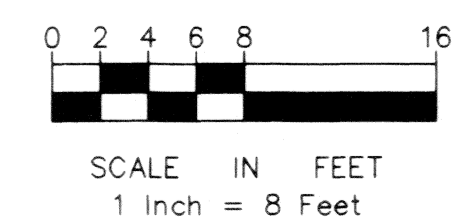

- \* All Sidewalks, Decks and Patios are LIMITED COMMON ELEMENTS assigned to the UNIT adjoining thereto.
- \* L.C.E.- Denotes Limited Common Element
- \* Elevations shown are referenced to a bench mark as denoted on Sheet 1 of 3 Sheets.
- \* All inside finished surface to inside finished surface dimensions and elevations are shown in feet and tenths of a foot.
- \* SW - Denotes Sidewalk
- \* C.E. - Denotes Ceiling Elevation
- \* F.E. - Denotes Floor Elevation