

CIC NUMBER 38 RIVER VILLAGE ESTATES CONDOMINIUM SEVENTH SUPPLEMENTAL CIC PLAT

This SEVENTH SUPPLEMENTAL CIC PLAT is part of the declaration recorded as Doc. No. 1462595 on the 13th day of October, 1999

SITE PLAN
AS BUILT

I HEREBY CERTIFY THAT THE CURRENT AND DELINQUENT TAXES ON THE LANDS DESCRIBED WITHIN ARE PAID AND THE TRANSFER IS ENTERED
Oct 13 1999
EDWARD M. TRASKA
COUNTY RECORDER
DEPUTY PROPERTY TAX ADMINISTRATOR

CITY OF COON RAPIDS
COUNTY OF ANOKA
BOOK 4 OF CIC PAGE 18

O Denotes iron monument found.
● Denotes 1/2 inch by 14 inch iron monument set and marked by Registration No. 14376.

No monument symbol shown at any statute required location indicates a plat monument that will be set, and which shall be in place on or before one year from the filing date of the plat.

For the purposes of this plat, the south line of Lot 15, Block 1, RIVER VILLAGE ESTATES is assumed to bear N89°23'59"E

There is a Drainage and Utility Easement over all of Lot 15, Block 1, and all of Lot 7, Block 2.

B.M. = T.N.H. 86TH AVE AND NORWAY STREET = 878.98 (N.G.V.D. -1929)

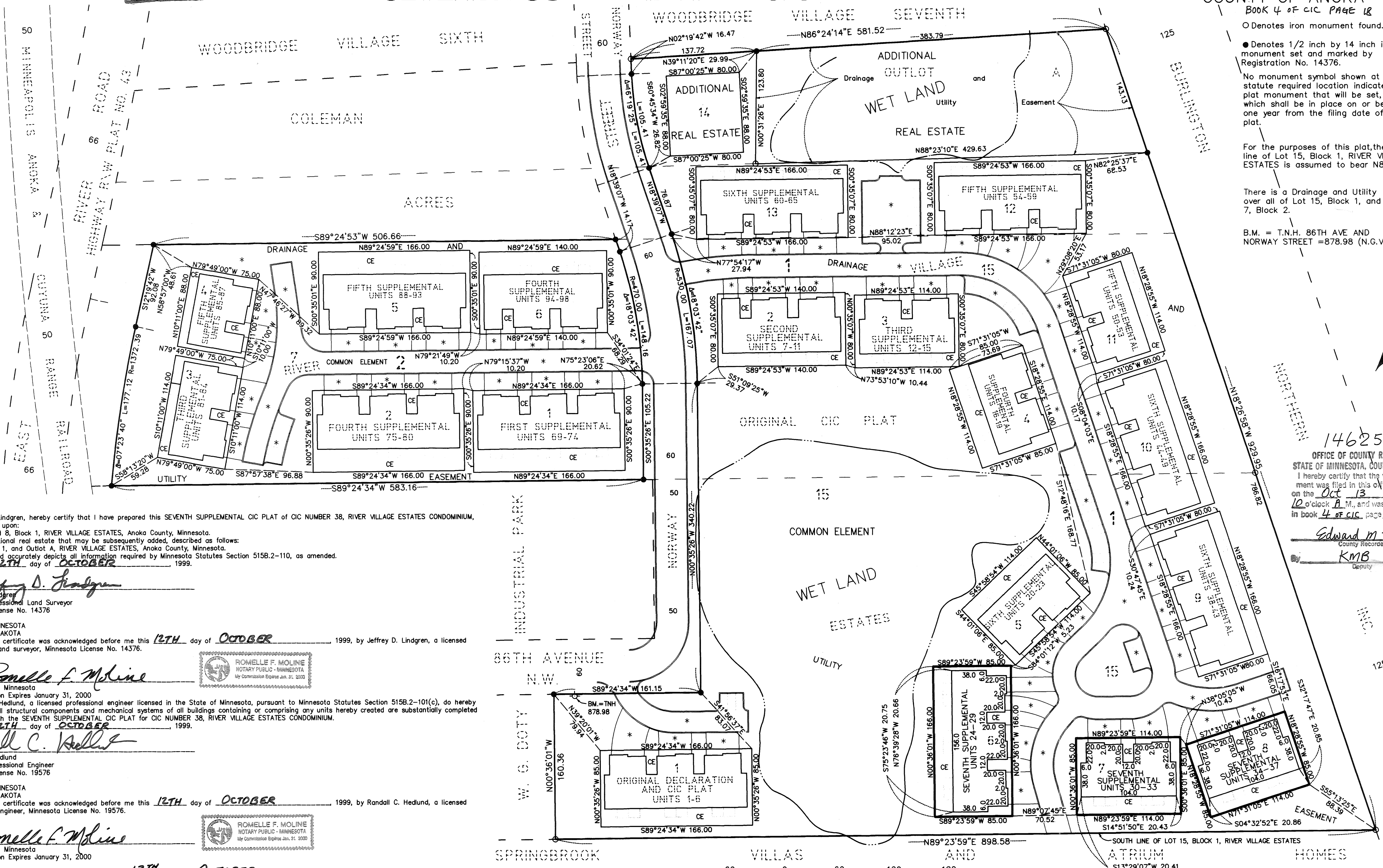

I, Jeffrey D. Lindgren, hereby certify that I have prepared this SEVENTH SUPPLEMENTAL CIC PLAT OF CIC NUMBER 38, RIVER VILLAGE ESTATES CONDOMINIUM, being located upon:
Lots 6, 7 and 8, Block 1, RIVER VILLAGE ESTATES, Anoka County, Minnesota.
And the additional real estate that may be subsequently added, described as follows:
Lot 14, Block 1, and Outlot A, RIVER VILLAGE ESTATES, Anoka County, Minnesota,
which fully and accurately depicts all information required by Minnesota Statutes Section 515B.2-110, as amended.
Dated this 12TH day of OCTOBER, 1999.

Jeffrey D. Lindgren
Jeffrey D. Lindgren
Licensed Professional Land Surveyor
Minnesota License No. 14376

STATE OF MINNESOTA
COUNTY OF DAKOTA
The foregoing certificate was acknowledged before me this 12TH day of OCTOBER, 1999, by Jeffrey D. Lindgren, a licensed professional land surveyor, Minnesota License No. 14376.

Romelle F. Moline
Romelle F. Moline
Notary Public, Minnesota
My Commission Expires January 31, 2000

I, Randall C. Hedlund, a licensed professional engineer licensed in the State of Minnesota, pursuant to Minnesota Statutes Section 515B.2-101(c), do hereby certify that all structural components and mechanical systems of all buildings containing or comprising any units hereby created are substantially completed consistent with the SEVENTH SUPPLEMENTAL CIC PLAT for CIC NUMBER 38, RIVER VILLAGE ESTATES CONDOMINIUM.
Dated this 12TH day of OCTOBER, 1999.

Randall C. Hedlund
Randall C. Hedlund
Licensed Professional Engineer
Minnesota License No. 19576

STATE OF MINNESOTA
COUNTY OF DAKOTA
The foregoing certificate was acknowledged before me this 12TH day of OCTOBER, 1999, by Randall C. Hedlund, a licensed professional engineer, Minnesota License No. 19576.

Romelle F. Moline
Romelle F. Moline
Notary Public, Minnesota
My Commission Expires January 31, 2000

This CIC plat has been checked and approved this 13TH day of OCTOBER, 1999.

By: *Larry D. Shin*
Larry D. Shin
Anoka County Surveyor

1462595
OFFICE OF COUNTY RECORDER
STATE OF MINNESOTA, COUNTY OF ANOKA
I hereby certify that the within instrument was filed in this office for record on the Oct 13 A.D., 1999 at 10 o'clock A.M., and was duly recorded in book 4 of CIC page 18

Edward M. Traska
Edward M. Traska
County Recorder
KMB
Deputy

- DENOTES CONCRETE CURB (MUST BE BUILT).
- * DENOTES BITUMINOUS SURFACE (MUST BE BUILT).
- CE DENOTES COMMON ELEMENT

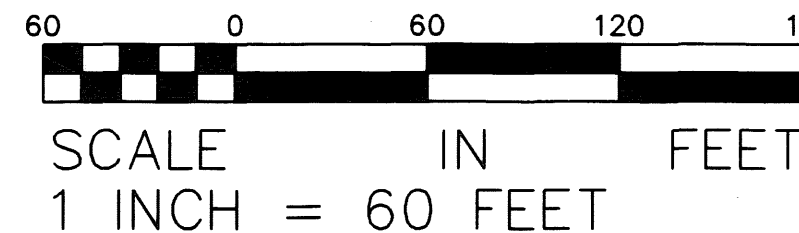

Receipt no. 1999109457 \$537.50

HEDLUND
PLANNING ENGINEERING SURVEYING

CIC NUMBER 38 RIVER VILLAGE ESTATES CONDOMINIUM SEVENTH SUPPLEMENTAL CIC PLAT

COMMON ELEMENT

LOWER LEVEL

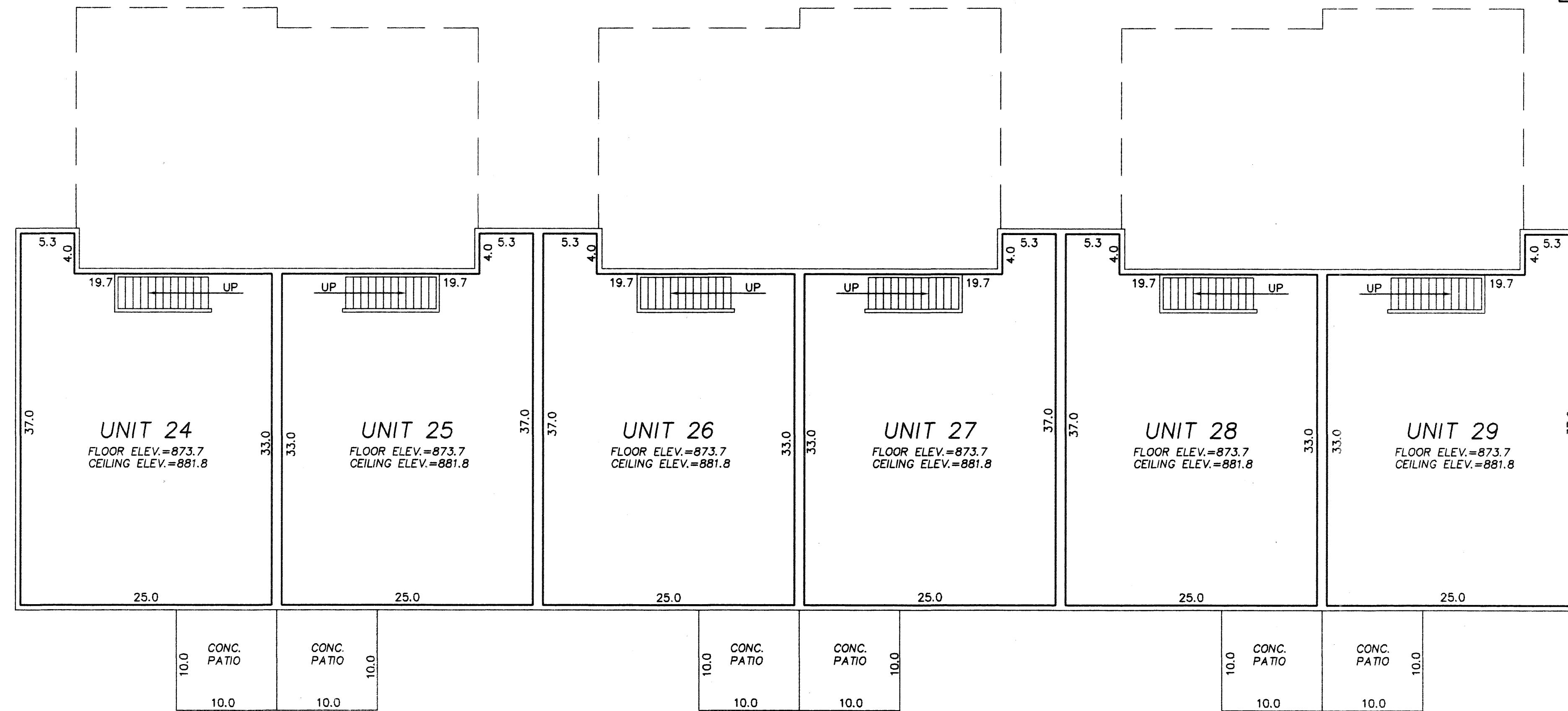

COMMON ELEMENT

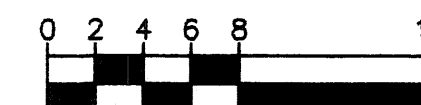

SCALE IN FEET
1 Inch = 8 Feet

- * All Sidewalks, Decks and Patios are LIMITED COMMON ELEMENTS assigned to the UNIT adjoining thereto.
- * L.C.E.- Denotes Limited Common Element
- * Elevations shown are referenced to a bench mark as denoted on Sheet 1 of 7 Sheets.
- * All inside finished surface to inside finished surface dimensions and elevations are shown in feet and tenths of a foot.
- * SW - Denotes Sidewalk
- * C.E. - Denotes Ceiling Elevation
- * F.E. - Denotes Floor Elevation

CIC NUMBER 38 RIVER VILLAGE ESTATES CONDOMINIUM SEVENTH SUPPLEMENTAL CIC PLAT

COMMON ELEMENT

MAIN LEVEL

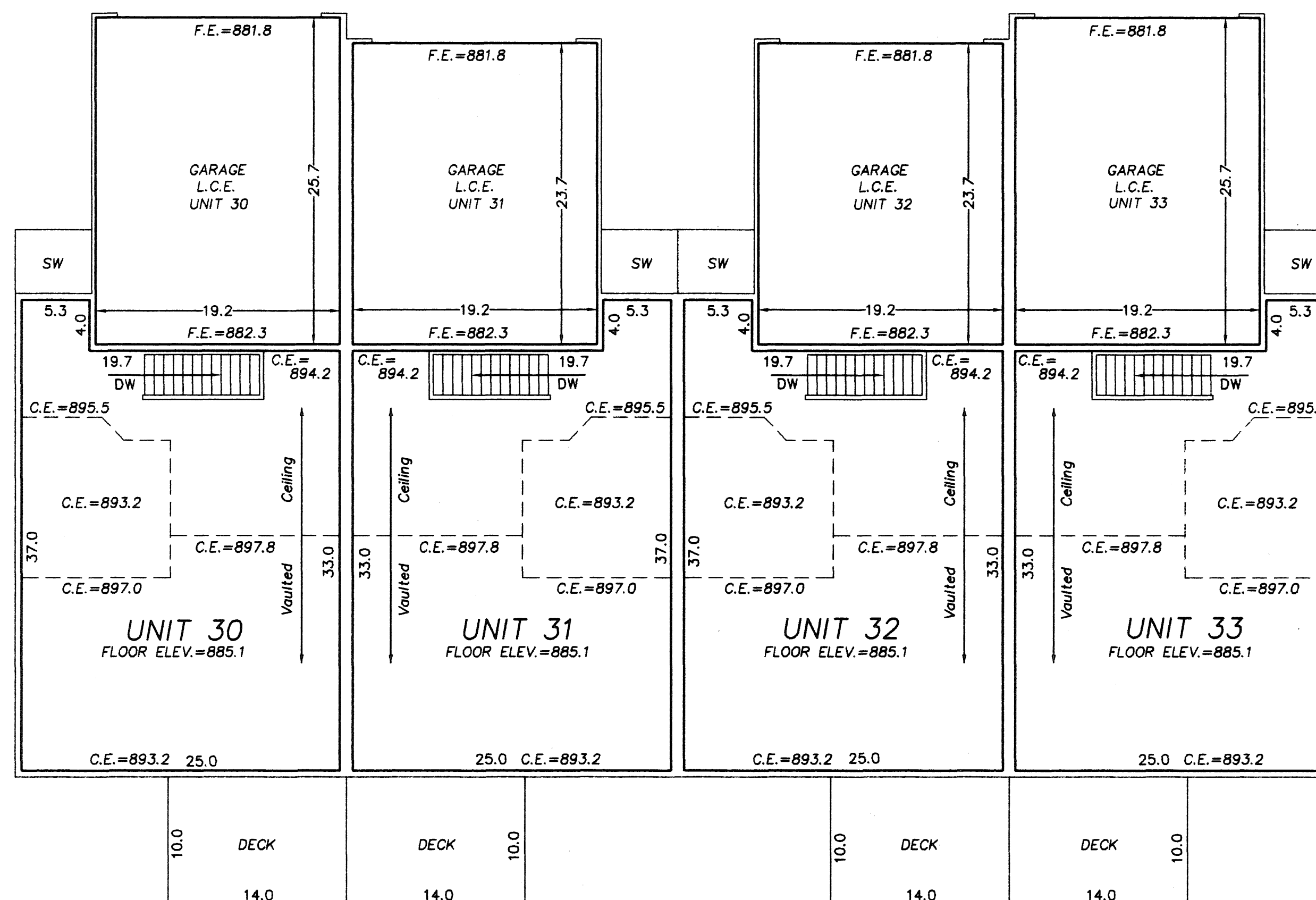

COMMON ELEMENT

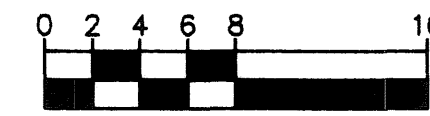

SCALE IN FEET
1 Inch = 8 Feet

HEDLUND
PLANNING ENGINEERING SURVEYING

- * All Sidewalks, Decks and Patios are LIMITED COMMON ELEMENTS assigned to the UNIT adjoining thereto.
- * L.C.E.- Denotes Limited Common Element
- * Elevations shown are referenced to a bench mark as denoted on Sheet 1 of 7 Sheets.
- * All inside finished surface to inside finished surface dimensions and elevations are shown in feet and tenths of a foot.
- * SW - Denotes Sidewalk
- * C.E. - Denotes Ceiling Elevation
- * F.E. - Denotes Floor Elevation

CIC NUMBER 38 RIVER VILLAGE ESTATES CONDOMINIUM SEVENTH SUPPLEMENTAL CIC PLAT

COMMON ELEMENT

LOWER LEVEL

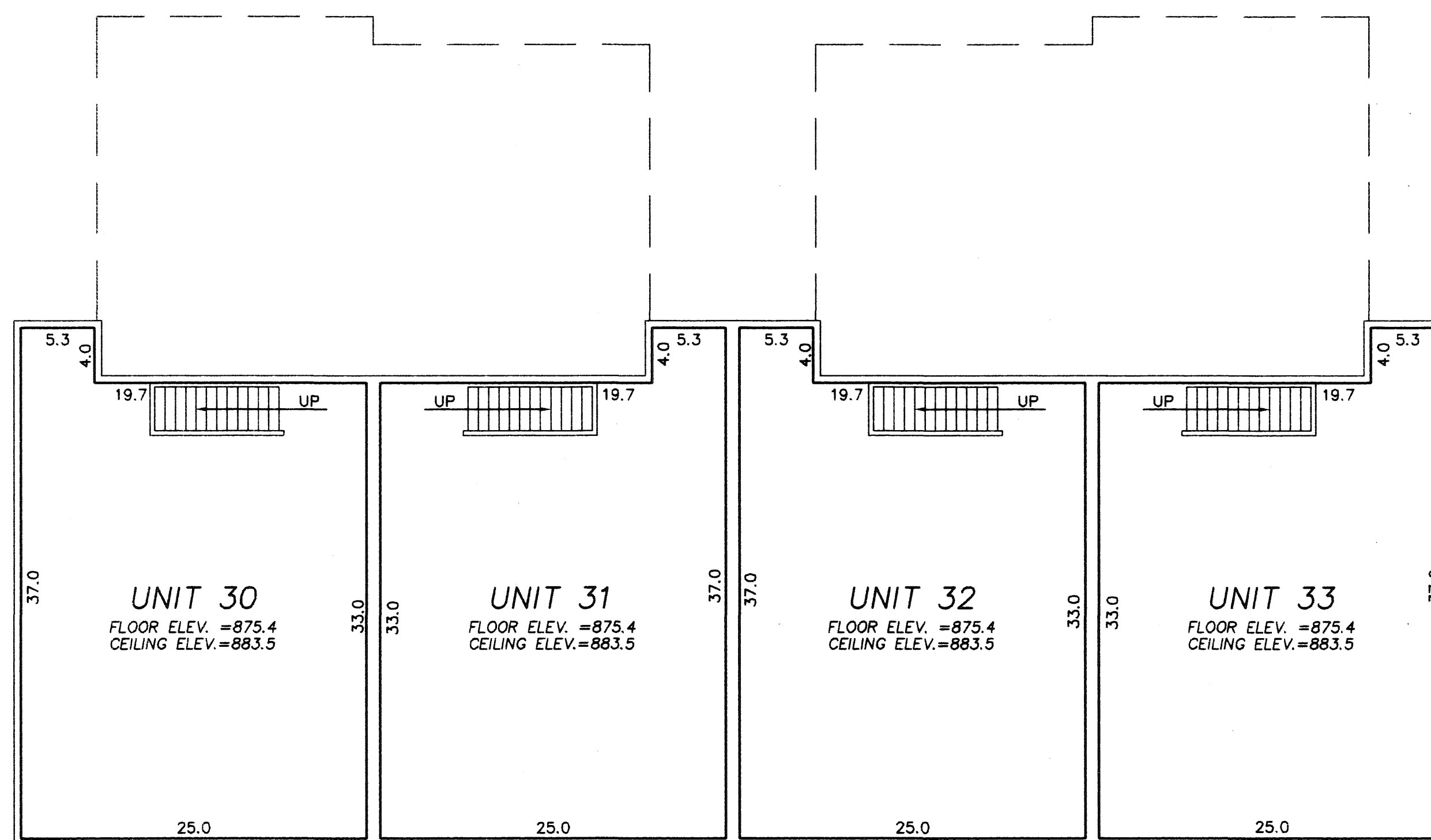

COMMON ELEMENT

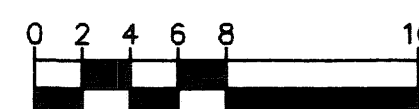

SCALE IN FEET
1 Inch = 8 Feet

- * All Sidewalks, Decks and Patios are LIMITED COMMON ELEMENTS assigned to the UNIT adjoining thereto.
- * L.C.E.- Denotes Limited Common Element
- * Elevations shown are referenced to a bench mark as denoted on Sheet 1 of 7 Sheets.
- * All inside finished surface to inside finished surface dimensions and elevations are shown in feet and tenths of a foot.
- * SW - Denotes Sidewalk
- * C.E. - Denotes Ceiling Elevation
- * F.E. - Denotes Floor Elevation

CIC NUMBER 38 RIVER VILLAGE ESTATES CONDOMINIUM SEVENTH SUPPLEMENTAL CIC PLAT

COMMON ELEMENT

MAIN LEVEL

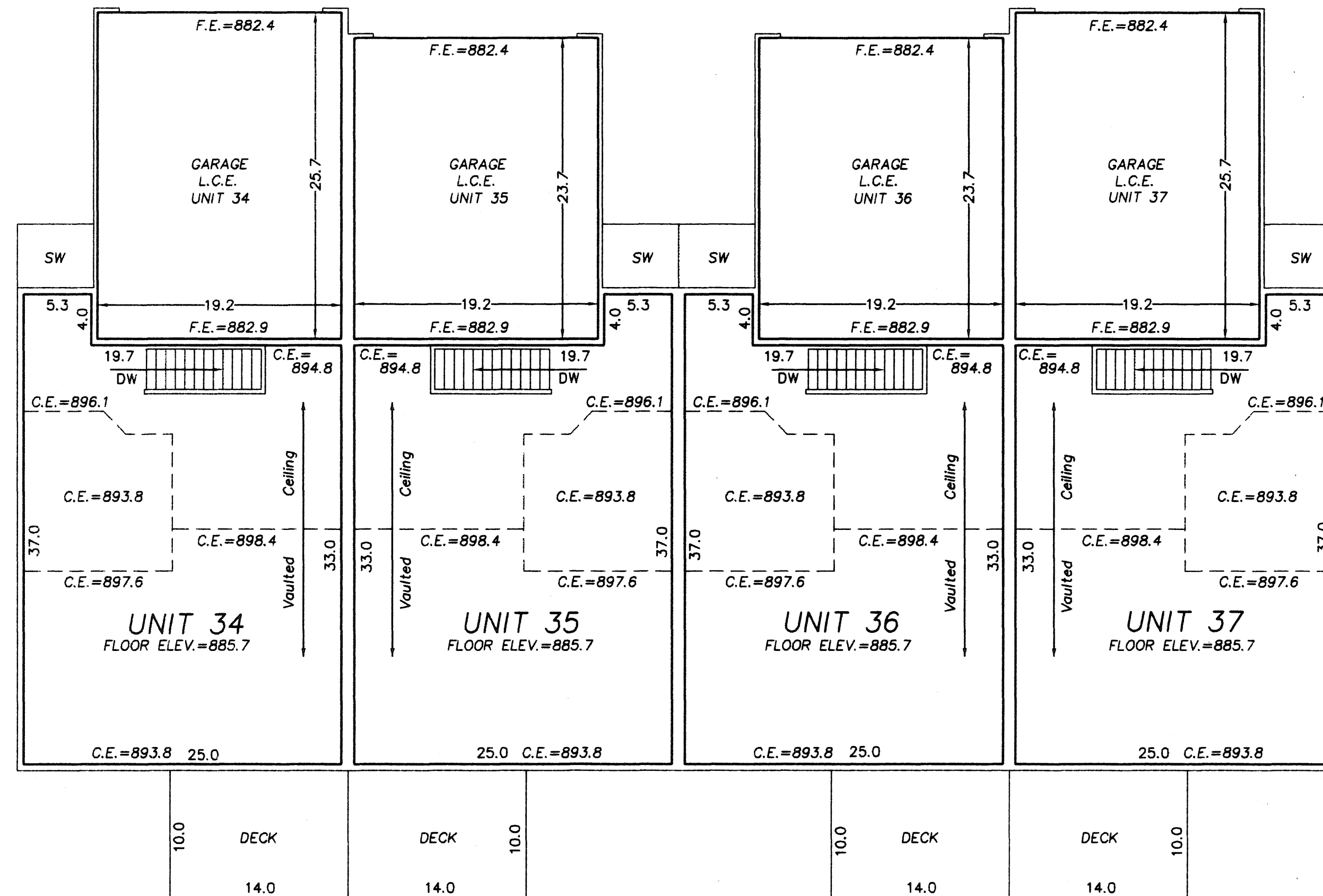

COMMON ELEMENT

HEDLUND
PLANNING ENGINEERING SURVEYING

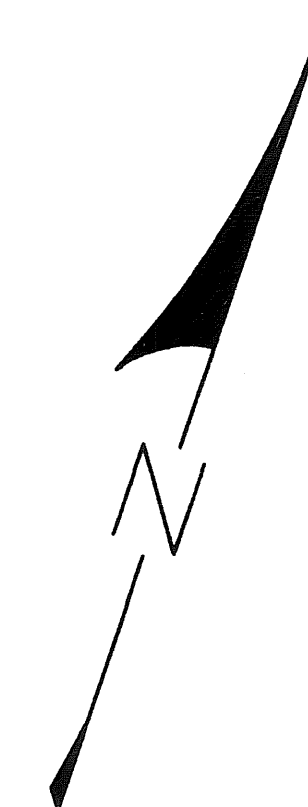
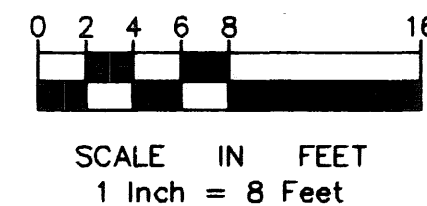

- * All Sidewalks, Decks and Patios are LIMITED COMMON ELEMENTS assigned to the UNIT adjoining thereto.
- * L.C.E.- Denotes Limited Common Element
- * Elevations shown are referenced to a bench mark as denoted on Sheet 1 of 7 Sheets.
- * All inside finished surface to inside finished surface dimensions and elevations are shown in feet and tenths of a foot.
- * SW - Denotes Sidewalk
- * C.E. - Denotes Ceiling Elevation
- * F.E. - Denotes Floor Elevation

CIC NUMBER 38 RIVER VILLAGE ESTATES CONDOMINIUM SEVENTH SUPPLEMENTAL CIC PLAT

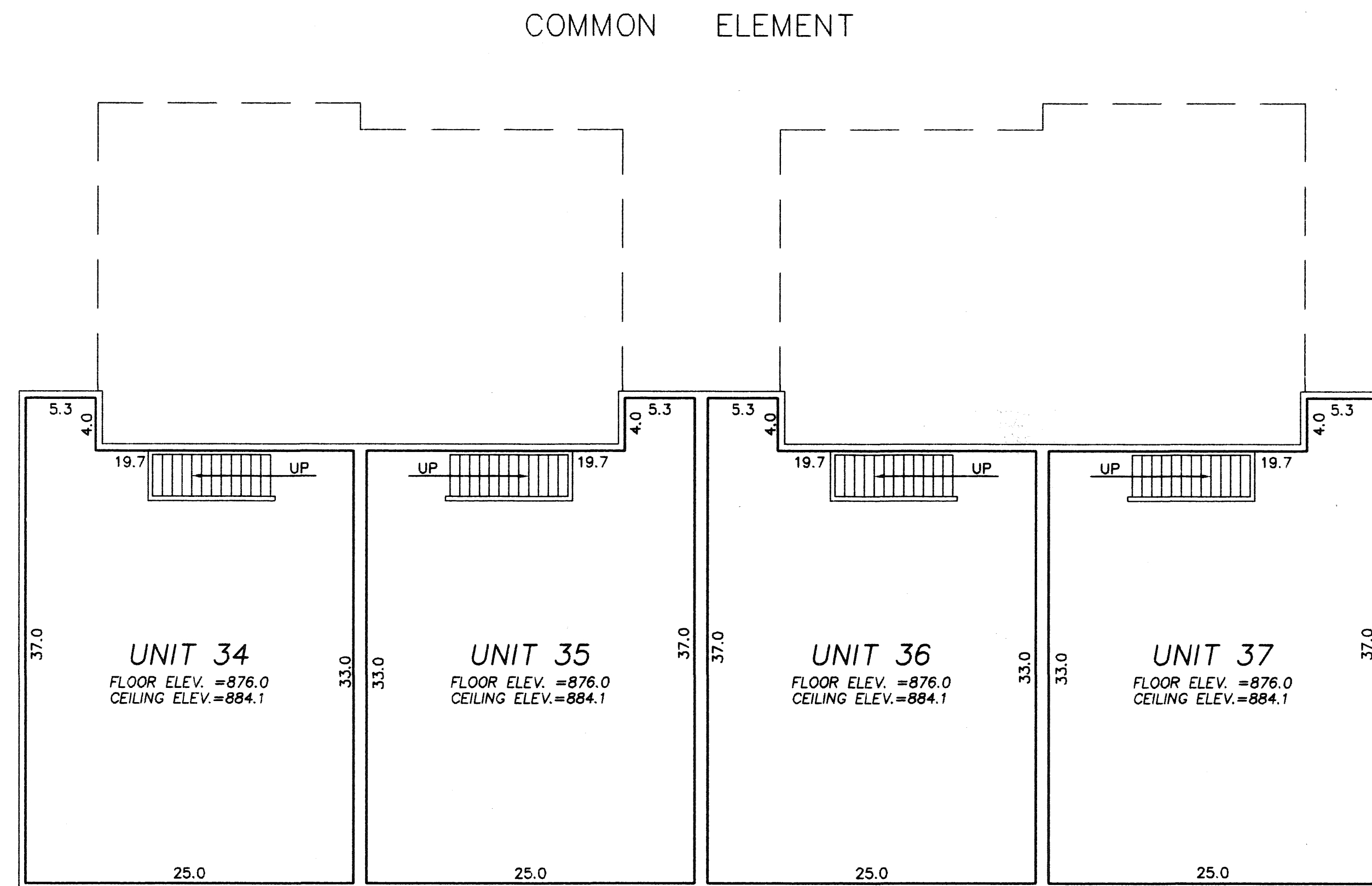

COMMON ELEMENT

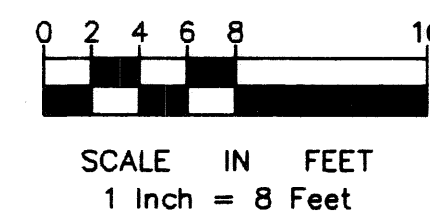
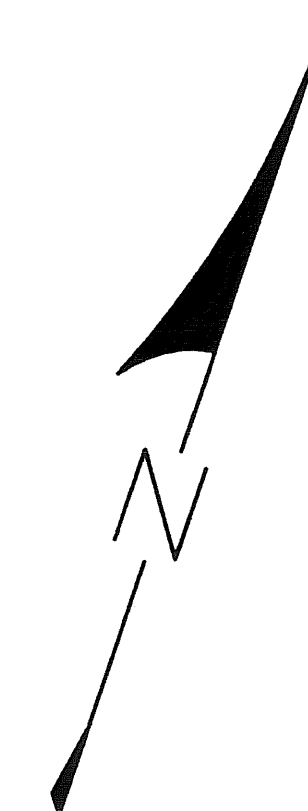

HEDLUND
PLANNING ENGINEERING SURVEYING

- * All Sidewalks, Decks and Patios are LIMITED COMMON ELEMENTS assigned to the UNIT adjoining thereto.
- * L.C.E.- Denotes Limited Common Element
- * Elevations shown are referenced to a bench mark as denoted on Sheet 1 of 7 Sheets.
- * All inside finished surface to inside finished surface dimensions and elevations are shown in feet and tenths of a foot.
- * SW - Denotes Sidewalk
- * C.E. - Denotes Ceiling Elevation
- * F.E. - Denotes Floor Elevation