

SITE PLAN
AS BUILT

CIC NUMBER 67 RIVER VILLAGE ESTATES 2ND ADDITION CONDOMINIUM ORIGINAL CIC PLAT

This CIC PLAT is part of the declaration recorded as Doc. No. 1471724 on the 29th day of November, 1999.

CITY OF COON RAPIDS
COUNTY OF ANOKA
S-36, T-31, R-24

○ Denotes iron monument found.
● Denotes 1/2 inch by 14 inch iron monument set and marked by Registration No. 14376.

All monuments required by Minnesota Statute, and not shown on this plat, will be set within one year of the recording date of this plat, and shall be evidenced by a 1/2 inch by 14 inch iron pipe marked by RLS No. 14376.

For the purposes of this plat, the south line of Lot 4, Block 1, RIVER VILLAGE ESTATES 2ND ADDITION is assumed to bear N89°24'34"E

There is a Drainage and Utility Easement over all of Lot 4, Block 1.

B.M. = T.N.H. 86TH AVE AND NORWAY STREET = 878.98 (N.G.V.D.-1929)

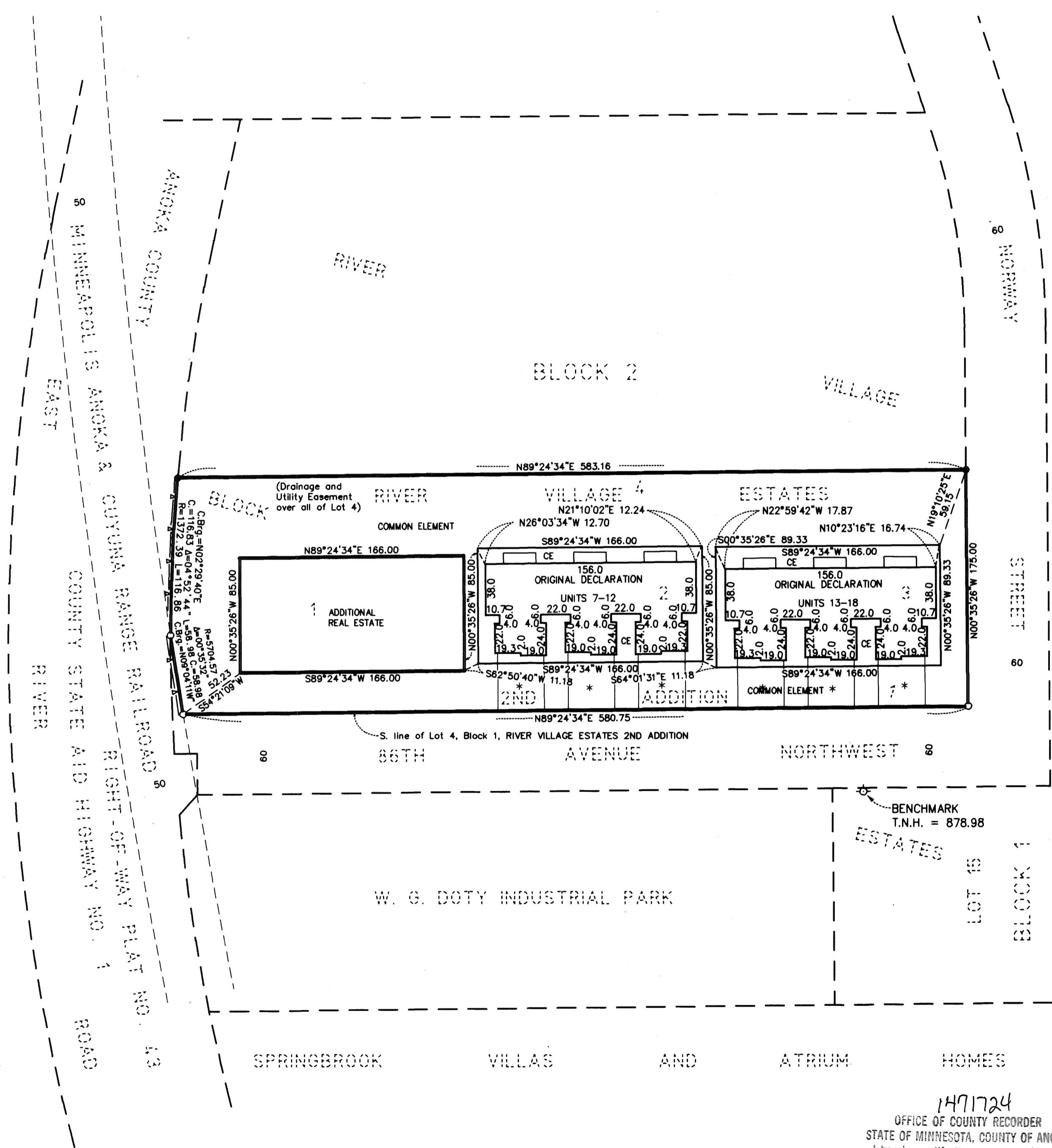

I, Jeffrey D. Lindgren, hereby certify that I have prepared this Original CIC plat of CIC NUMBER 67, RIVER VILLAGE ESTATES 2ND ADDITION CONDOMINIUM, being located upon:

Lots 2, 3 and 4, Block 1, RIVER VILLAGE ESTATES 2ND ADDITION, Anoka County, Minnesota.

And the additional real estate that may be subsequently added, described as follows:
Lot 1, Block 1, RIVER VILLAGE ESTATES 2ND ADDITION, Anoka County, Minnesota.

which fully and accurately depicts all information required by Minnesota Statutes Section 515B.2-110, as amended.
Dated this 23RD day of NOVEMBER, 1999.

Jeffrey D. Lindgren
Jeffrey D. Lindgren
Licensed Professional Land Surveyor
Minnesota License No. 14376

STATE OF MINNESOTA
COUNTY OF HENNEPIN
The foregoing certificate was acknowledged before me this 23RD day of NOVEMBER, 1999, by Jeffrey D. Lindgren, a licensed professional land surveyor, Minnesota License No. 14376.

Romelle F. Molino
Romelle F. Molino
Notary Public, Minnesota
My Commission Expires 1-31-2000

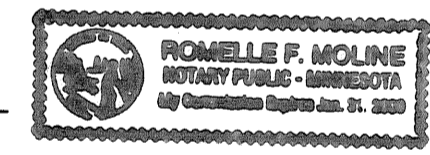

I, Randall C. Hedlund, a licensed professional engineer licensed in the State of Minnesota, pursuant to Minnesota Statutes Section 515B.2-101(c), do hereby certify that all structural components and mechanical systems of all buildings containing or comprising any units hereby created are substantially completed consistent with the CIC Plat for CIC NUMBER 67, RIVER VILLAGE ESTATES 2ND ADDITION CONDOMINIUM.

Dated this 23RD day of NOVEMBER, 1999.

Randall C. Hedlund
Randall C. Hedlund
Licensed Professional Engineer
Minnesota License No. 19576

STATE OF MINNESOTA
COUNTY OF HENNEPIN
The foregoing certificate was acknowledged before me this 23RD day of NOVEMBER, 1999, by Randall C. Hedlund, a licensed professional engineer, Minnesota License No. 19576.

Romelle F. Molino
Romelle F. Molino
Notary Public, Minnesota
My Commission Expires 1-31-2000



This CIC plat has been checked and approved this 29th day of November, 1999.

By: *Larry P. Hovin*
Larry P. Hovin
Anoka County Surveyor

1471724
OFFICE OF COUNTY RECORDER
STATE OF MINNESOTA, COUNTY OF ANOKA
I hereby certify that the within instrument was filed in this office for record on the 29th day of November, A.D., 1999.
at 8:46 o'clock A.M., and was duly recorded in book CIC 4, page 20.
Edward M. Teska
County Recorder
By: *Rebecca A. Pierson*
Deputy

I HEREBY CERTIFY THAT THE CHANGES AND RELAYMENT TABBED ON THE LATER DECEASED WITHIN ARE PAID AND THE TRANSFER IS
DATED November 29, 1999
Edward M. Teska
COUNTY RECORDER
By: *Rebecca A. Pierson*
DEPUTY

* DENOTES BITUMINOUS SURFACE (MUST BE BUILT).
CE DENOTES COMMON ELEMENT

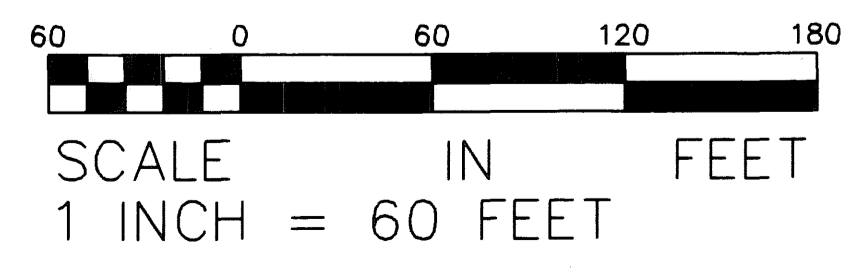

1999121311 / \$ 489.50

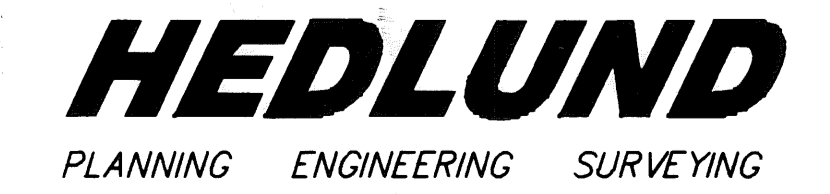

CIC NUMBER 67 RIVER VILLAGE ESTATES 2ND ADDITION CONDOMINIUM ORIGINAL CIC PLAT

UPPER LEVEL

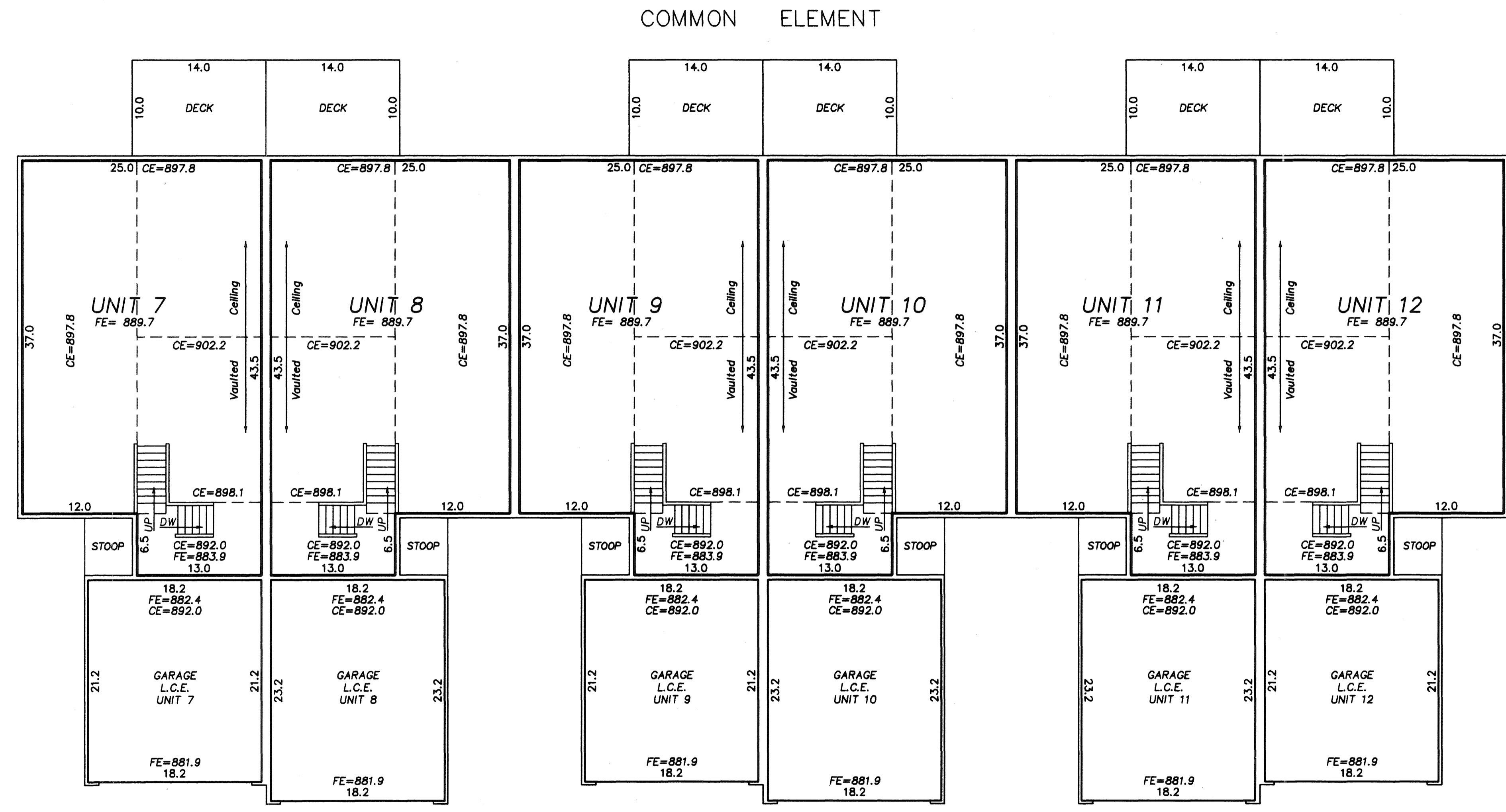

COMMON ELEMENT

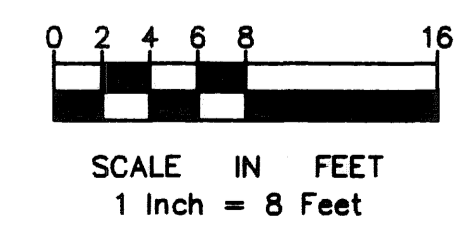

- * All Sidewalks, Decks and Patios are LIMITED COMMON ELEMENTS assigned to the UNIT adjoining thereto.
- * L.C.E.- Denotes Limited Common Element
- * Elevations shown are referenced to a bench mark as denoted on Sheet 1 of 5 Sheets.
- * All inside finished surface to inside finished surface dimensions and elevations are shown in feet and tenths of a foot.
- * SW - Denotes Sidewalk
- * C.E. - Denotes Ceiling Elevation
- * F.E. - Denotes Floor Elevation

HEDLUND
PLANNING ENGINEERING SURVEYING

CIC NUMBER 67 RIVER VILLAGE ESTATES 2ND ADDITION CONDOMINIUM ORIGINAL CIC PLAT

LOWER LEVEL

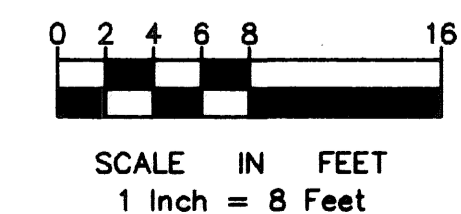
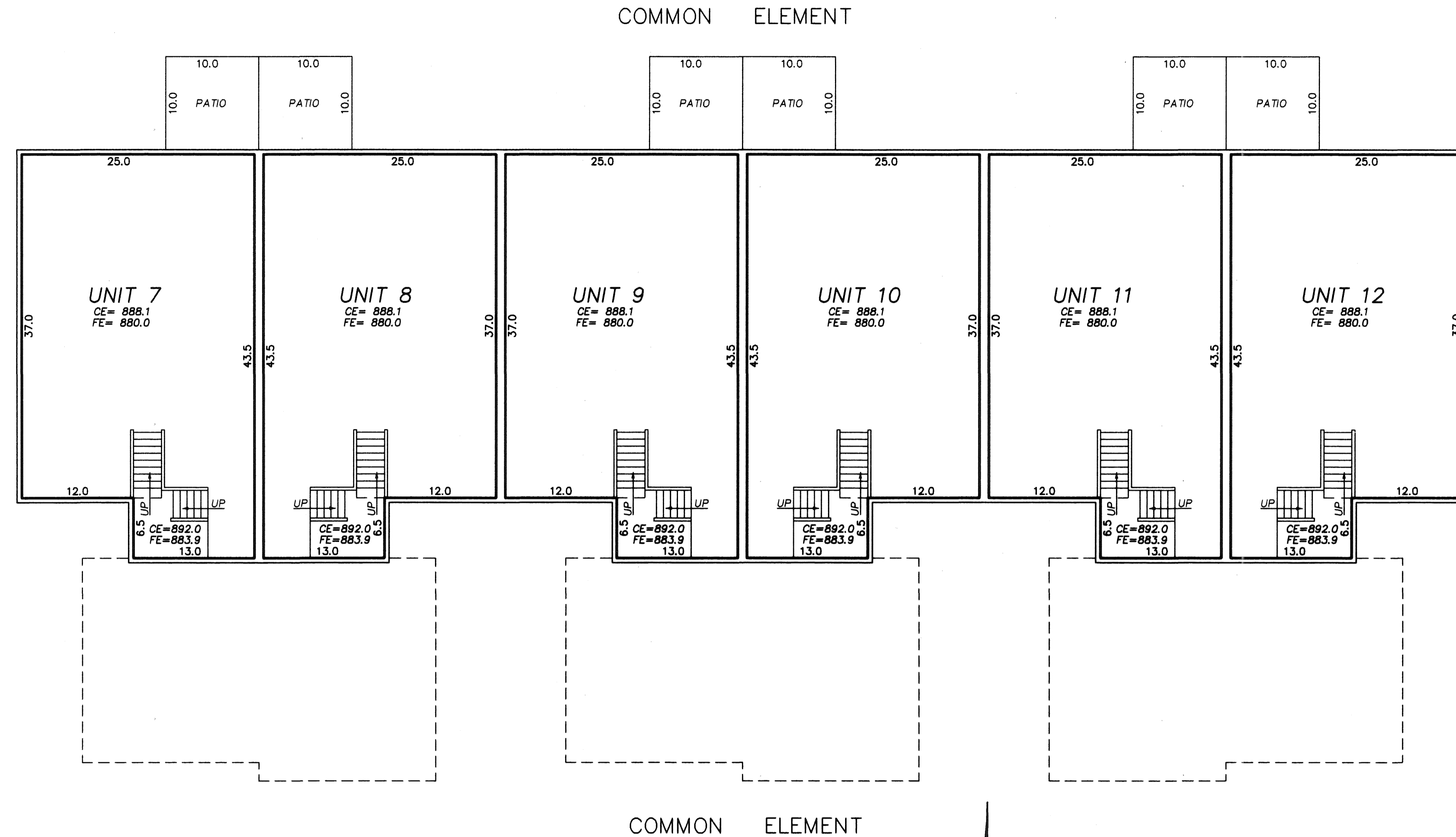

- * All Sidewalks, Decks and Patios are LIMITED COMMON ELEMENTS assigned to the UNIT adjoining thereto.
- * L.C.E.- Denotes Limited Common Element
- * Elevations shown are referenced to a bench mark as denoted on Sheet 1 of 5 Sheets.
- * All inside finished surface to inside finished surface dimensions and elevations are shown in feet and tenths of a foot.
- * SW - Denotes Sidewalk
- * C.E. - Denotes Ceiling Elevation
- * F.E. - Denotes Floor Elevation

HEDLUND
PLANNING ENGINEERING SURVEYING

CIC NUMBER 67 RIVER VILLAGE ESTATES 2ND ADDITION CONDOMINIUM ORIGINAL CIC PLAT

UPPER LEVEL

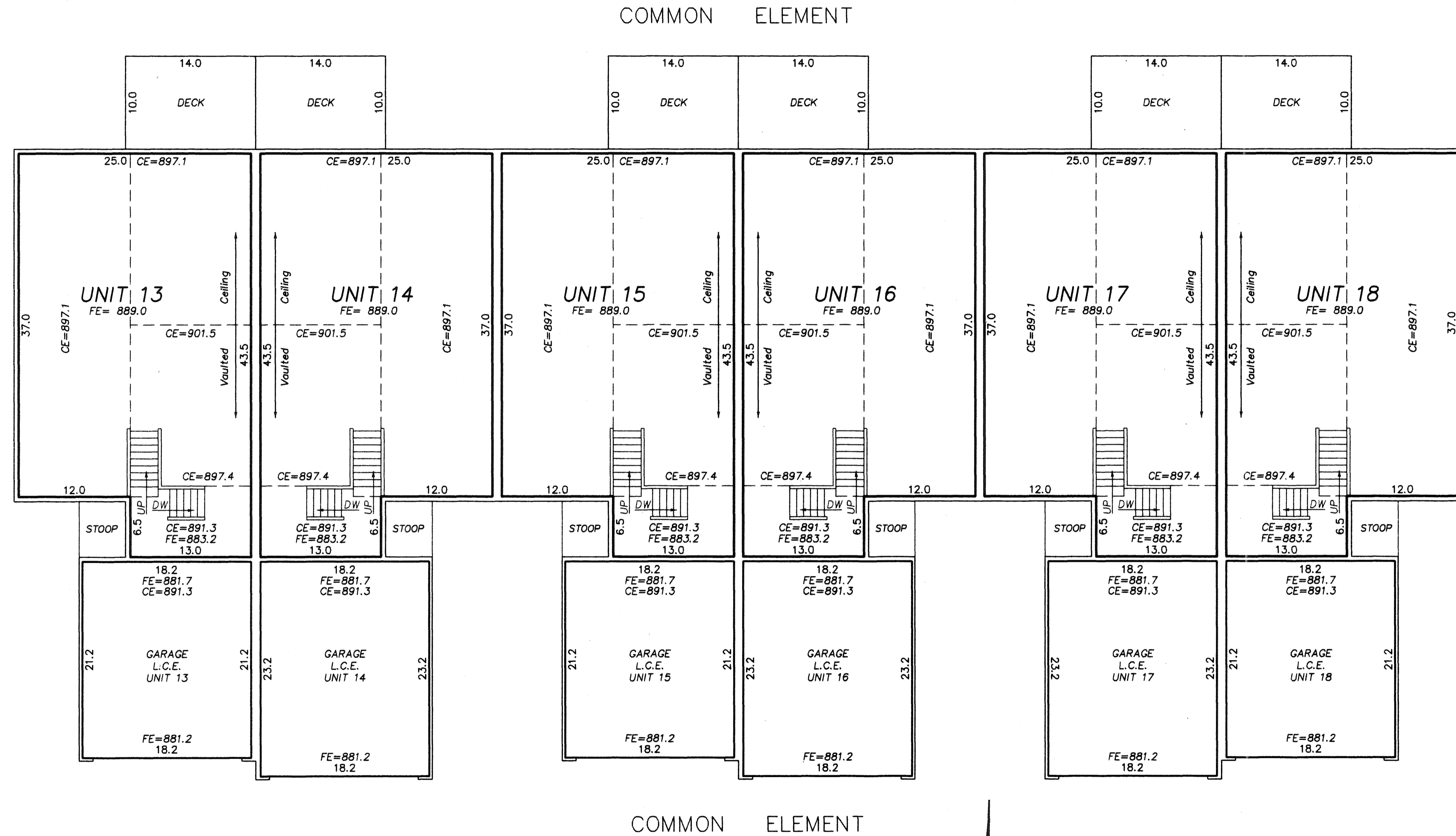

COMMON ELEMENT

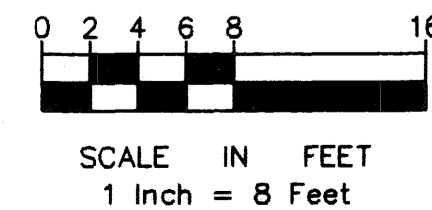

- * All Sidewalks, Decks and Patios are LIMITED COMMON ELEMENTS assigned to the UNIT adjoining thereto.
- * L.C.E.- Denotes Limited Common Element
- * Elevations shown are referenced to a bench mark as denoted on Sheet 1 of 5 Sheets.
- * All inside finished surface to inside finished surface dimensions and elevations are shown in feet and tenths of a foot.
- * SW - Denotes Sidewalk
- * C.E. - Denotes Ceiling Elevation
- * F.E. - Denotes Floor Elevation

CIC NUMBER 67 RIVER VILLAGE ESTATES 2ND ADDITION CONDOMINIUM ORIGINAL CIC PLAT

LOWER LEVEL

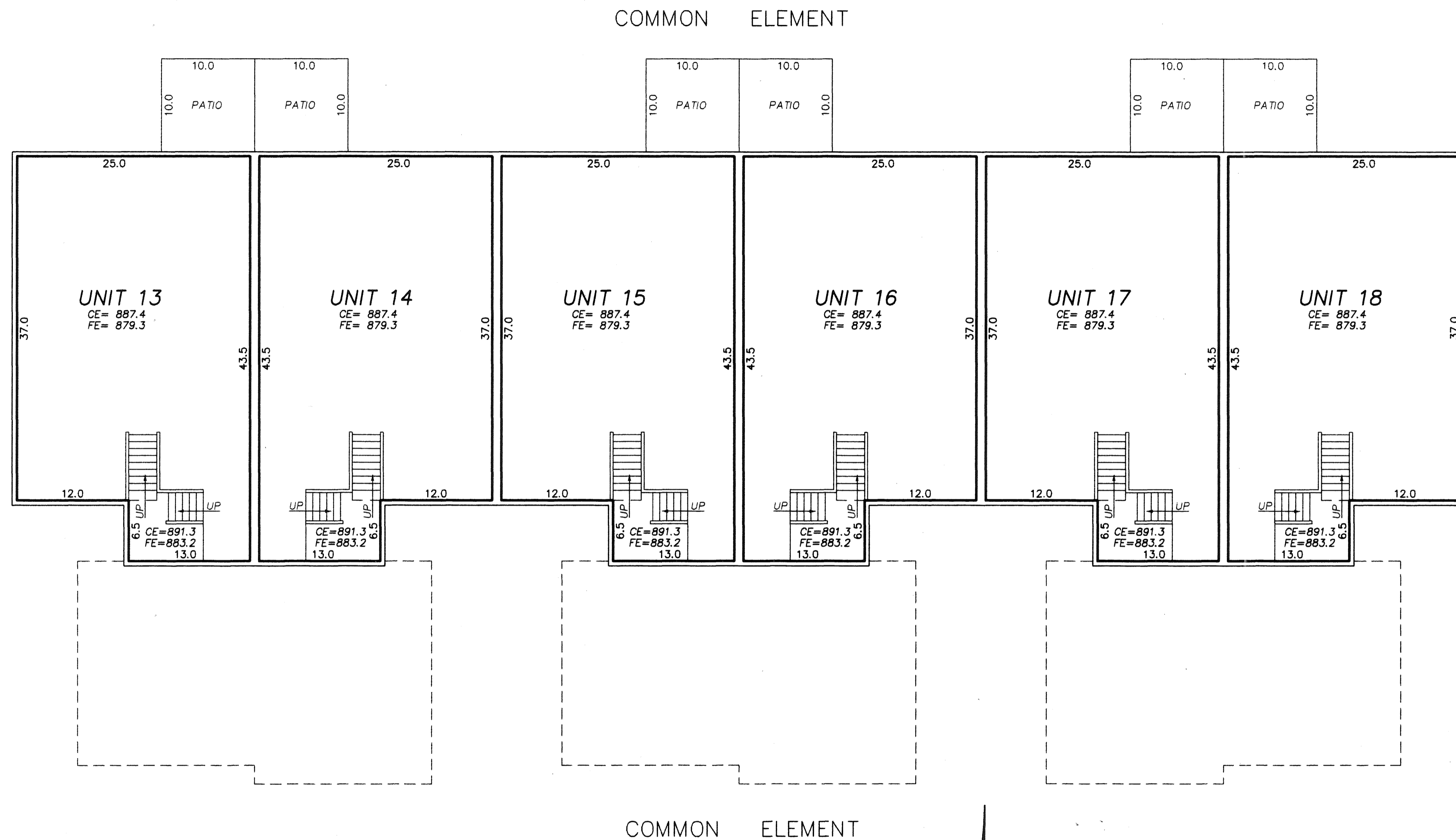

COMMON ELEMENT

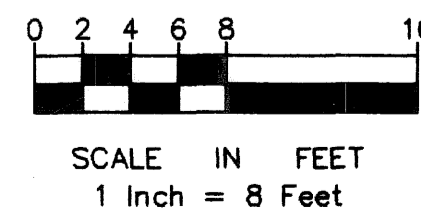

HEDLUND
PLANNING ENGINEERING SURVEYING

- * All Sidewalks, Decks and Patios are LIMITED COMMON ELEMENTS assigned to the UNIT adjoining thereto.
- * L.C.E.— Denotes Limited Common Element
- * Elevations shown are referenced to a bench mark as denoted on Sheet 1 of 5 Sheets.
- * All inside finished surface to inside finished surface dimensions and elevations are shown in feet and tenths of a foot.
- * SW — Denotes Sidewalk
- * C.E. — Denotes Ceiling Elevation
- * F.E. — Denotes Floor Elevation