

GRAY'S

ADDITION TO

ANOKA

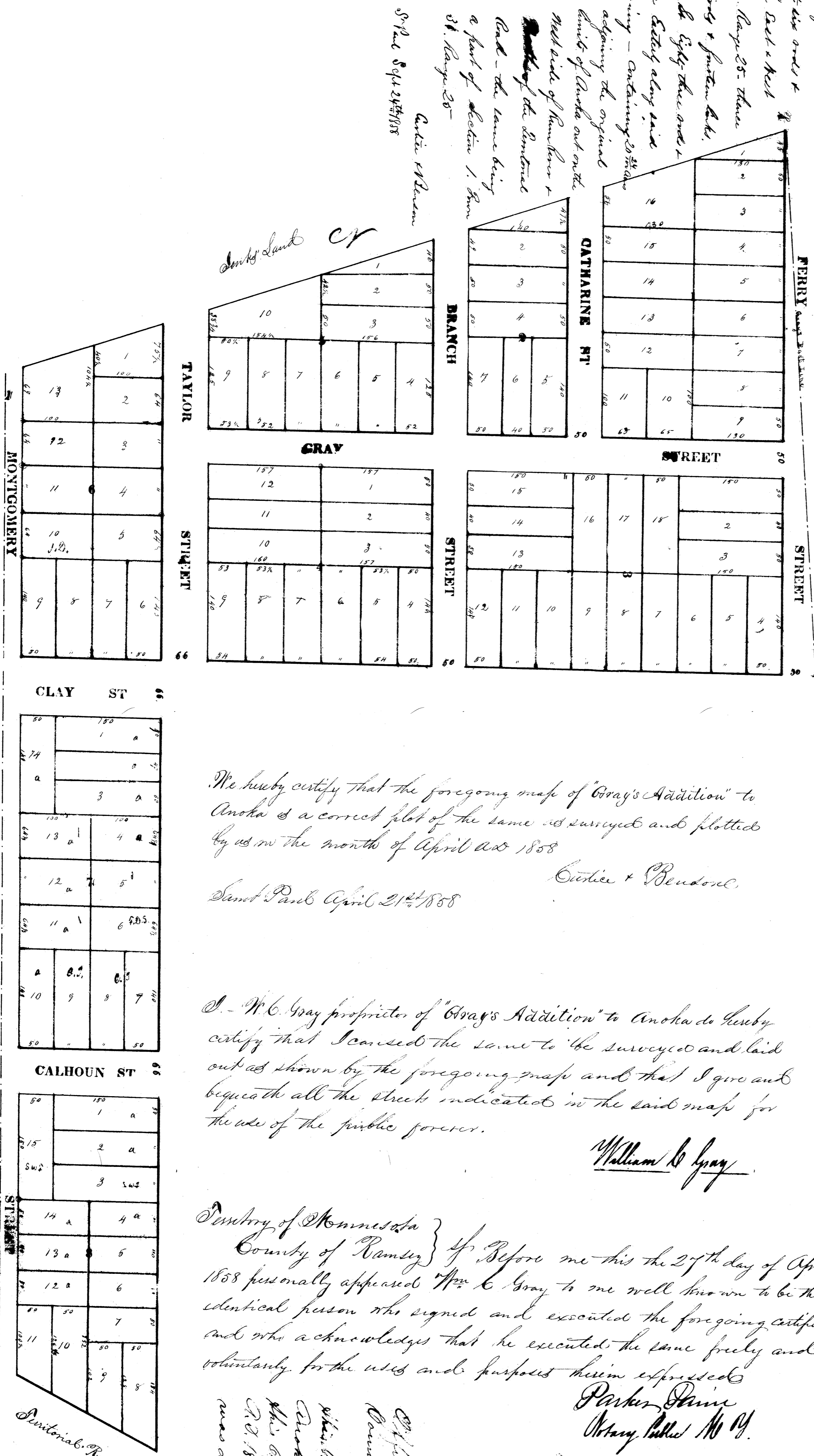

Description of land contained in the foregoing plat...
 The plat is a correct and true copy of the original plat as shown to me by the surveyor...
 The plat is a correct and true copy of the original plat as shown to me by the surveyor...
 The plat is a correct and true copy of the original plat as shown to me by the surveyor...

We hereby certify that the foregoing map of "Gray's Addition" to Anoka is a correct plot of the same as surveyed and plotted by us in the month of April A.D. 1858

Sanct. Park April 21st 1858
 Curtis + Bendon

I, W.C. Gray proprietor of "Gray's Addition" to Anoka do hereby certify that I caused the same to be surveyed and laid out as shown by the foregoing map and that I give and bequeath all the streets indicated in the said map for the use of the public forever.

William C. Gray

County of Ramsey }
 County of Ramsey }
 Before me this the 27th day of April 1858 personally appeared W.C. Gray to me well known to be the identical person who signed and executed the foregoing certificate and who acknowledges that he executed the same freely and voluntarily for the uses and purposes therein expressed.

Parker Davis
 Notary Public No. 14.

Official Register of Ramsey County of Minnesota
 This office in the 14th day of April A.D. 1858 at the said place was duly recorded.

*County of Minnesota }
 County of Anoka }
 Before me this the 14th day of April 1858 personally appeared before me W.C. Gray to me well known to be the identical person who signed and executed the foregoing certificate and who acknowledges that he executed the same freely and voluntarily for the uses and purposes therein expressed.*

Albert Woodruff
 Notary Public for Minnesota.

Brando's Land

Divisional Road