

OR 1502

OLLINGER PARK

Addition to Fridley Park.

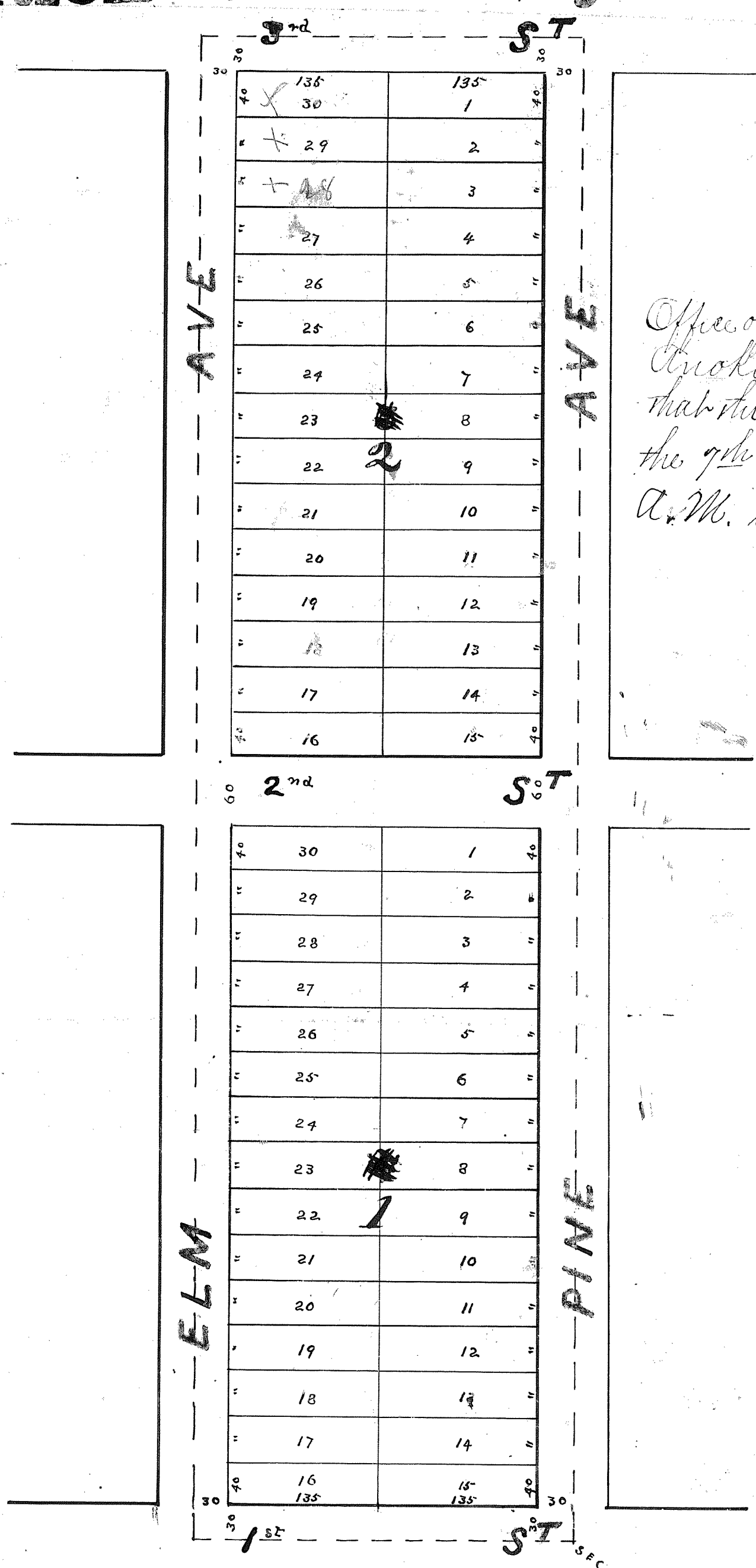

Office of the Register of Deeds } ss
 Anoka County Minnesota } I hereby certify
 that this plat was filed in this office on
 the 7th day of October A. D. 1887 at 9 o'clock
 A. M. in Book A of Plats
 S. H. Kilpatrick
 Register of Deeds
 Anoka Co. Minn.



I hereby certify that the above is a true and correct plat of the
 East 1/2 of the South W 1/4 of the South W 1/4 of the South W 1/4 and
 East 1/2 of the North W 1/4 of the South W 1/4 of the South W 1/4
 of Sec 28 Township 31 Range 23 that the lots and streets
 in said subdivision are as indicated by the figures upon the
 above drawing

J R Lewis
 Civil Eng

State of Minnesota
 County of Hennepin
 Before me a Notary Public in and for said County
 on the Eight day of Sept A. D. 1887 personally
 came J R Lewis to me well known as
 the person described in and who executed the
 above certificate and acknowledges the signing of
 the same as his free act and deed

A. N. Juntius
 Notary Public
 Hennepin County
 Minnesota

John Ollinger and Margaret Ollinger his wife
 Owners and proprietors of the above described real
 estate do hereby certify that we have caused this same
 to be platted as indicated in the above drawing and have
 called the same ~~Ollinger~~ ^{Ollinger} Park Addition and that we
 hereby dedicate to the public forever all lands indicated
 on the above drawing as streets

John Ollinger
 Margaret Ollinger

S. B. Blanchard
 State of Minnesota
 County of Hennepin

Before me a Notary Public in and for said County on the
 eight day of Sept A. D. 1887 personally came John
Ollinger and Margaret Ollinger his wife
 to me well known to me ~~well~~ as the persons
 who executed the above dedication and acknowledge
 the signing of the same as their free act
 and deed

A. N. Juntius
 Notary Public
 Hennepin County
 Minn.



Deputy Notary Public
 State of Minnesota
 October 7th 1887