

REGISTERED LAND SURVEY NUMBER 106

ANOKA COUNTY, MINNESOTA

I hereby certify that in accordance with the provisions of Chapter 508, Minnesota Statutes of 1949, as amended, I have surveyed the following described tract of land in the County of Anoka and State of Minnesota, to wit:

The Southeast Quarter of the Southwest Quarter (SE 1/4 of SW 1/4) of Section Fifteen (15), Township Thirty-one (31), Range Twenty-three (23), except right-of-way.

ALSO EXCEPT, the south 680.00 feet of the east 900.00 feet thereof, as measured at right angles to the south and east lines respectively, of the above described property.

I hereby certify that this Registered Land Survey is a correct delineation of said survey.

Dated this 12th day of MAY, 1988.

Larry D. Holm, Land Surveyor
Minnesota Registration No. 18165

175904
OFFICIAL REGISTERED LAND SURVEY
I HEREBY CERTIFY THAT THE TAXES PAYABLE IN THIS SURVEY ON THE LANDS DESCRIBED WITHIN ARE PAID

This Registered Land Survey has been approved and accepted by the City Council of Blaine at a regular meeting thereof held this 19th day of May, 1988.

CITY COUNCIL OF BLAINE, MINNESOTA

By Cheryl Tinklerberg Mayor
By Joyce Turstel Clerk

"NO DELINQUENT TAXES AND TRANSFER ENTITLED"
May 20th 1988
Charles R. Schreiber Auditor, Anoka County
By Pamela Schuch Deputy

Checked and approved this 12th day of May, 1988.

M. J. D. ... Anoka County Surveyor

REGISTERED LAND SURVEY NUMBER 106

ANOKA COUNTY, MINNESOTA

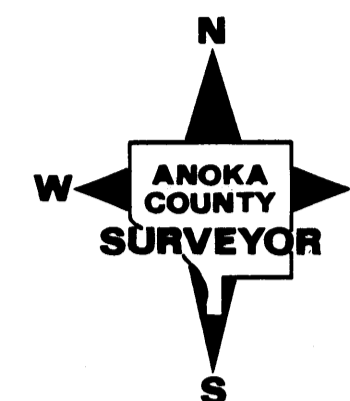

SCALE: ONE INCH=200 FEET
SCALE IN FEET

○ DENOTES IRON PIPE SET

THE EAST LINE OF THE SOUTHEAST 1/4 OF THE SOUTHWEST 1/4 OF SEC. 15, T. 31, R. 23 IS ASSUMED TO HAVE A BEARING OF S0°48'59"E.

