

ST. CLAIR WOODS

City of Blaine - County of Anoka

290986

REGISTRAR OF TITLES
Katherine Beier
2:30 P

KNOW ALL MEN BY THESE PRESENTS: that Landon M. LaCroix, a single person, owner of the following described property situated in the State of Minnesota, County of Anoka to wit:

Lot 34, Spring Lake Park Woodland, Anoka County, Minnesota

and that Daniel A. Vogel and Cathy J. Vogel, husband and wife, owners of the following described property situated in the State of Minnesota, County of Anoka to wit:

Lot 35, Spring Lake Park Woodland, Anoka County, Minnesota

Has caused the same to be surveyed and platted as ST. CLAIR WOODS and do hereby dedicate to the public for public use forever the street, avenue and drainage and utility easements as shown on this plat

In witness whereof said Landon M. LaCroix, a single person, has hereunto set his hand this 19th day of December, 1996

Landon M. LaCroix
Landon M. LaCroix

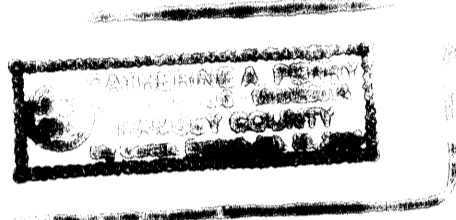

STATE OF Minnesota
COUNTY OF Ramsay
19th day of December, 1996 The foregoing instrument was acknowledged before me this _____ day of _____, 1996, by Landon M. LaCroix, a single person.

Carol A. Long
Notary Public, Ramsay County, Minnesota
My Commission Expires 11/31/2000

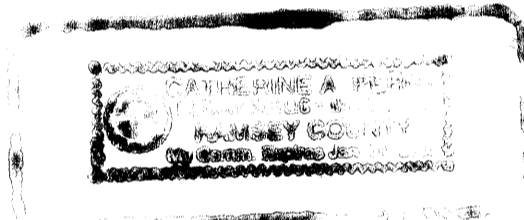

In witness whereof said Daniel A. Vogel and Cathy J. Vogel, husband and wife, have hereunto set their hands this 19th day of Dec., 1996

Daniel A. Vogel
Daniel A. Vogel
Cathy J. Vogel
Cathy J. Vogel

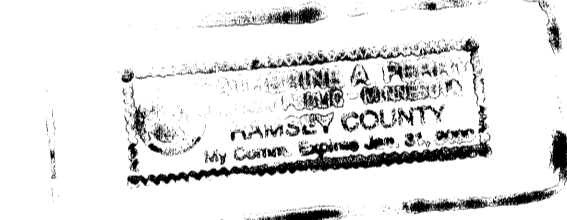

STATE OF Minnesota
COUNTY OF Ramsay
19th day of Dec, 1996 The foregoing instrument was acknowledged before me this _____ day of _____, 1996, by Daniel A. Vogel and Cathy J. Vogel, husband and wife.

Carol A. Long
Notary Public, Ramsay County, Minnesota
My Commission Expires 11/31/2000

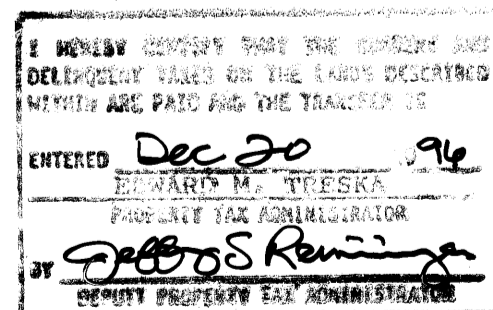
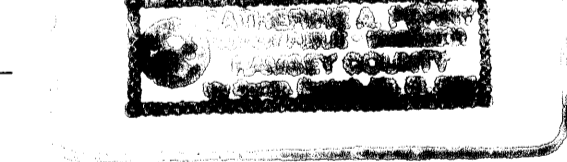

I hereby certify that I have surveyed and platted the property described on this plat as ST. CLAIR WOODS that this plat is a correct representation of said survey; that all distances are correctly shown on the plat in feet and hundredths of a foot; that all monuments will be correctly placed in the ground as shown; that the outside boundary lines are correctly designated on said plat and that there are no wetlands or public highways to be designated other than as shown on said plat.

Ronald P. Alwin
Ronald P. Alwin, Land Surveyor
Minnesota Registration No. 17765

STATE OF MINNESOTA
COUNTY OF ANOKA

The foregoing Surveyors Certificate was acknowledged before me this 16th day of December, 1996, by Ronald P. Alwin, Land Surveyor

John A. Rengo
Notary Public, Anoka County, Minnesota
My Commission Expires January 31, 2000

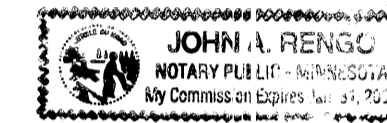

This plat of ST. CLAIR WOODS was approved by the City Council of Blaine, Minnesota at a regular meeting thereof held this 21st day of November, 1996, and if applicable, the written comments and recommendations of the Commissioner of Transportation and the County Highway Engineer have been received by the City or the prescribed 30 day period has elapsed without receipt of such comments and recommendations, as provided by Minnesota Statutes, Section 505.03, Subd. 2.

By Shirley Lindberg Mayor
By Joyce Wright Clerk

This plat has been checked and approved this 20th day of DECEMBER, 1996

MERLYN D. ANDERSON
Merlyn D. Anderson
Anoka County Surveyor
by Larry D. Alwin deputy



ST. CLAIR WOODS

City of Blaine - County of Anoka

VICINITY MAP

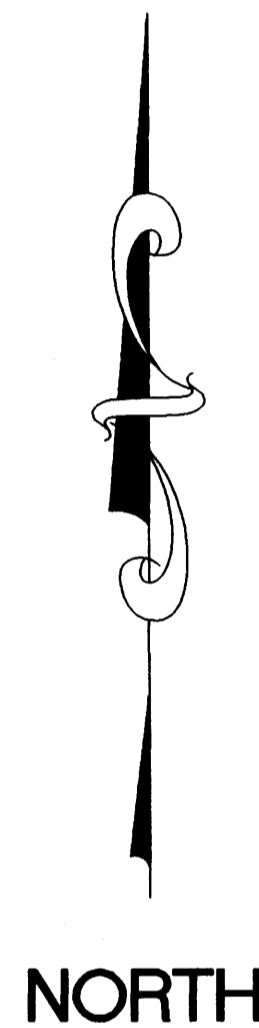
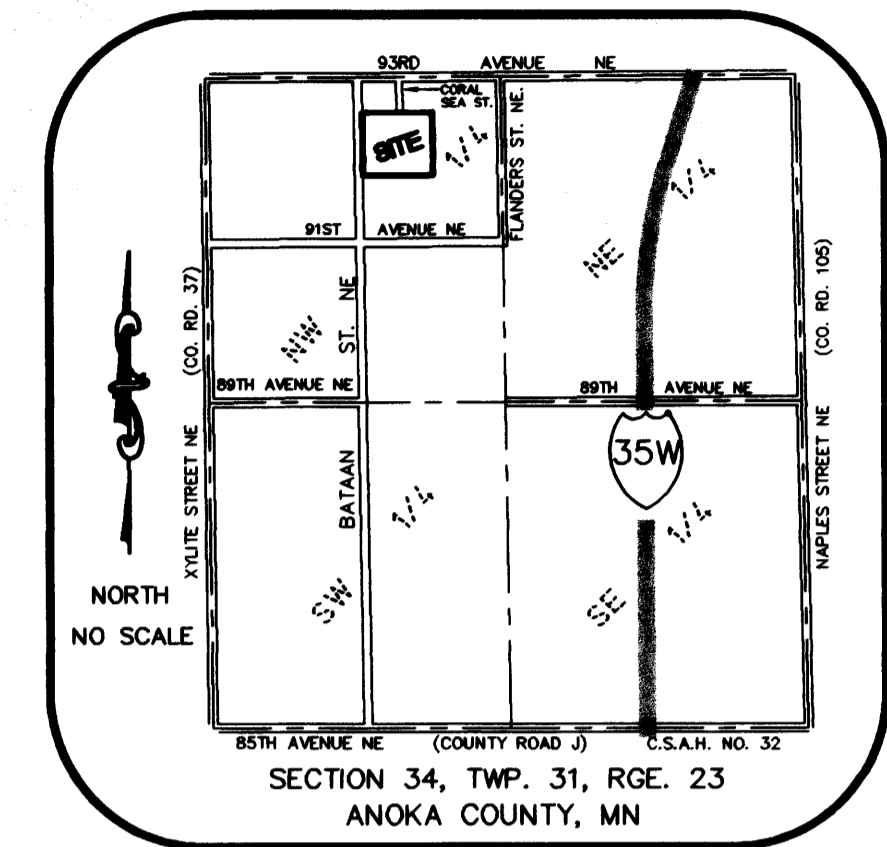

NORTH

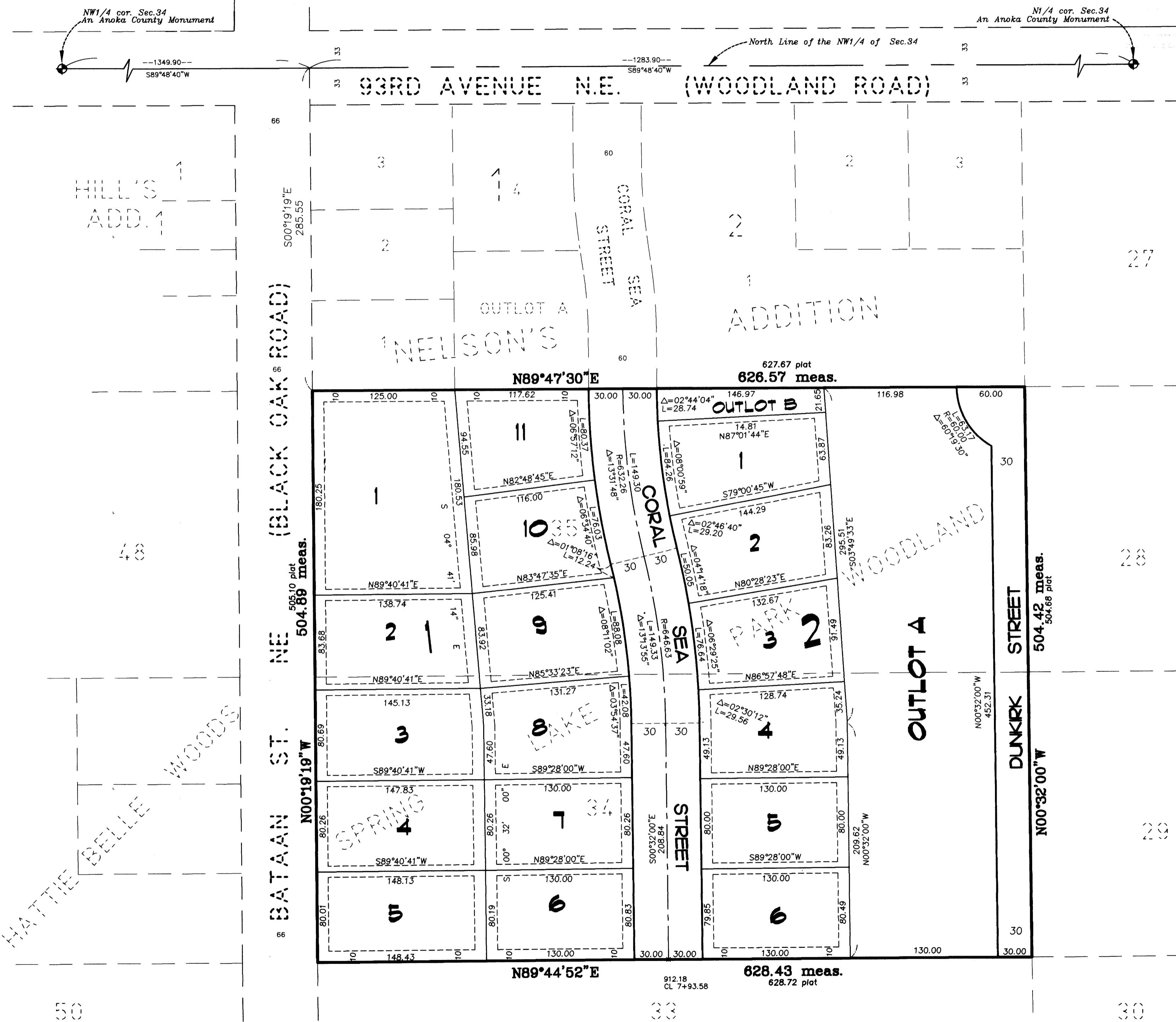

PLAT DENOTES DISTANCE PER PLAT OF SPRING LAKE PARK WOODLAND
MEAS. DENOTES MEASURED DISTANCE

No monument symbol shown at any statute required location indicates a plat monument that will be a 1/2 inch by 18 inch iron pipe set within one year of the recording of this plat, and marked by RLS 17765

For the purposes of this plat the north line of Lot 35, Spring Lake Park Woodland is assumed to have a bearing of N 89°47'30" E

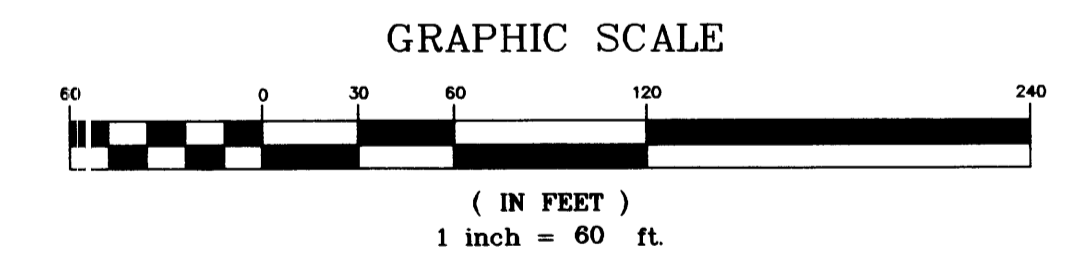

DRAINAGE AND UTILITY EASEMENTS SHOWN THUS:

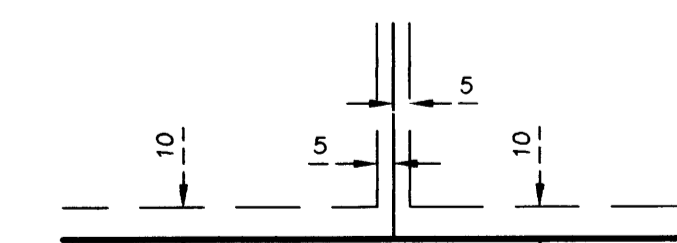

BEING 5 FEET IN WIDTH AND ADJOINING SIDE LOT LINES AND 10 FEET IN WIDTH AND ADJOINING STREET LINES AND REAR LOT LINES UNLESS OTHERWISE SHOWN ON THE PLAT.

E.G. RUD & SONS, INC.
LAND SURVEYORS