

OFFICIAL PLAT

TRAPPERS RIDGE

Bk 67 of Abot, pg 21

CITY OF RAMSEY
COUNTY OF ANOKA, MN
SECTION 16, T32, R25

FOR THE PURPOSES OF THIS PLAT THE EAST LINE OF THE SE1/4, SECTION 16, T32, R25, IS ASSUMED TO BEAR S1°07'53"W.

KNOW ALL PERSONS BY THESE PRESENTS: That Gregory L. Bauer and Michelle R. Bauer, husband and wife, owners and proprietors, and Village Banks, a Minnesota Corporation, mortgage, of the following described property situated in the County of Anoka, State of Minnesota, to-wit;

The North 780.07 feet of the East 526.49 feet of the Southeast Quarter of Section 16, Township 32, Range 25, Anoka County, Minnesota.

And That part of the South 333.00 feet of the Southeast Quarter of the Northeast Quarter of Section 16 Township 32, Range 25, Anoka County, Minnesota, as measured at right angles to the south line of said Southeast Quarter of the Northeast Quarter which lies easterly of the following described line: Commencing at the southeast corner of said Southeast Quarter of the Northeast Quarter; thence North 89 degrees 02 minutes 35 seconds West, assumed bearing, along the south line thereof 527.06 feet to the point of beginning of the line to be herein described; thence North 29 degrees 10 minutes 38 seconds West 385.04 feet to the north line of said South 333.00 feet and there terminating.

Have caused the same to be surveyed and platted as TRAPPERS RIDGE and do hereby donate and dedicate to the public for public use forever the Lane and easements for utility and drainage purposes as shown on the plat. In witness whereof said Gregory L. Bauer and Michelle R. Bauer, husband and wife, have hereunto set their hands this 10th day of FEBRUARY 2004. In witness whereof said Village Banks, a Minnesota Corporation, has caused these presents to be signed by its proper officer this 10th day of FEBRUARY 2004.

Gregory L. Bauer
Gregory L. Bauer

VILLAGE BANKS

Michelle R. Bauer
Michelle R. Bauer

C.E. ZEMKE
C.E. ZEMKE its VICE PRESIDENT

State of Minnesota
County of Anoka
The foregoing instrument was acknowledged before me this 10th day of February, 2004, by Gregory L. Bauer and Michelle R. Bauer, husband and wife.



Barbara J. Robinson
Notary Public, Anoka County, Minnesota
My Commission Expires 1-31-2007

State of Minnesota
County of Anoka
The foregoing instrument was acknowledged before me this 10th day of February, 2004, by C.E. ZEMKE as VICE PRESIDENT of Village Banks, a Minnesota Corporation, on behalf of said corporation.



Sarah J. Greene
Notary Public, Anoka County, Minnesota
My Commission Expires 1/31/05

I hereby certify that I have surveyed and platted the property described on this plat as TRAPPERS RIDGE; that this plat is a correct representation of said survey; that all distances are correctly shown in feet and hundredths of a foot; that all monuments have been correctly placed in the ground as shown on the plat; that the outside boundary lines are correctly designated on said plat; and that there are no wetlands as defined in MS 905.02, Subd. 1 to be designated or public highways to be designated other than as shown.

Charles F. Anderson
Charles F. Anderson, Land Surveyor
Minnesota License No. 21753

State of Minnesota
County of Hennepin
The foregoing instrument was acknowledged before me this 13th day of JANUARY, 2004, by Charles F. Anderson, Land Surveyor

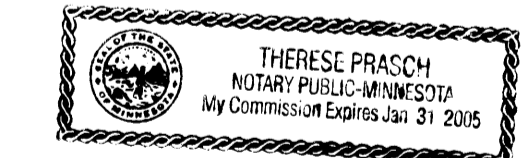

Therese Prasch
Therese Prasch, Notary Public, Hennepin County, Minnesota.
My Commission Expires January 31, 2005.

This plat of TRAPPERS RIDGE was accepted and approved by the City Council of the City of Ramsey at a regular meeting thereof held this 12th day of December, 2003. If applicable, the written comments and recommendations of the Commissioner of Transportation and the County Highway Engineer have been received by the City or the prescribed 30 day period has elapsed without receipt of such comments and recommendations, as provided by Minnesota Statutes Section 505.03, Subd. No. 2.

Shon Kalman
Mayor

John M. Hurling
Clerk

Checked and approved this 12th day of MAY, 2004.

Terry D. Shin
Anoka County Surveyor

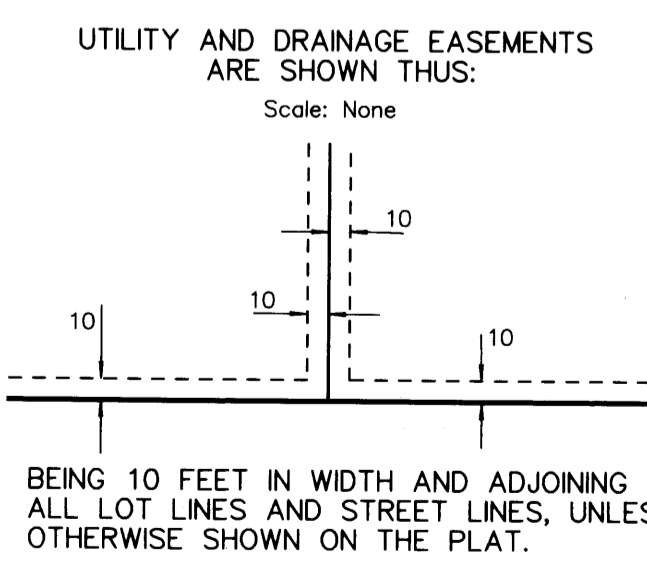
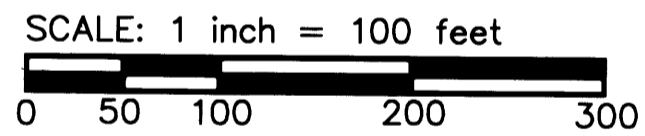
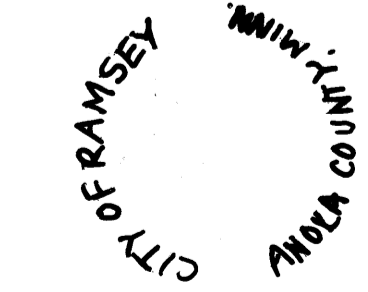

- Denotes 1/2" x 14" Iron Monument Set with plastic cap marked with R.L.S. No. 21753
- Denotes Iron Monument Found
- Denotes Cast Iron Monument

LOT SURVEYS COMPANY, INC.
LAND SURVEYORS

Office of REGISTRAR OF TITLES
STATE OF MINNESOTA
COUNTY OF ANOKA 466219.0
I hereby certify that the within instrument was filed in this office on May 12, 2004 at 9:45 o'clock A.M.
Maureen J. Devine, Registrar of Titles
By TAP Deputy Registrar of Titles

I HEREBY CERTIFY THAT THE CURRENT AND DELINQUENT TAXES ON THE LANDS DESCRIBED WITHIN ARE PAID AND THE TRANSFER IS ENTERED
MAY 12 2004
MAUREEN J. DEVINE
PROPERTY TAX ADMINISTRATOR
By S. Culver
DEPUTY PROPERTY TAX ADMINISTRATOR

2004065678 \$55.00

2004065672 \$220.00