

CERTIFICATE OF LOCATION OF GOVERNMENT CORNER

County of Anoka

State of Minnesota

South 1/4 Corner of Sec. 11 Township 32 Range 24

On the 1st day of June, 1962, the described corner was evidenced by a 1/2" iron pipe in a wooden post

and to perpetuate the location of said corner, at the exact location thereof, a permanent marker was placed consisting of a red and white iron pipe

AND on the 26th day of January, 2011, said permanent marker was found leaning. On 3/14/11 a 2" square steel Telespar monument was set up 1'±. Sign & post was set on west side.

Updated reference ties are as shown below.

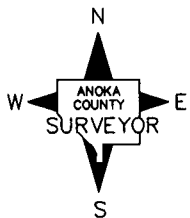
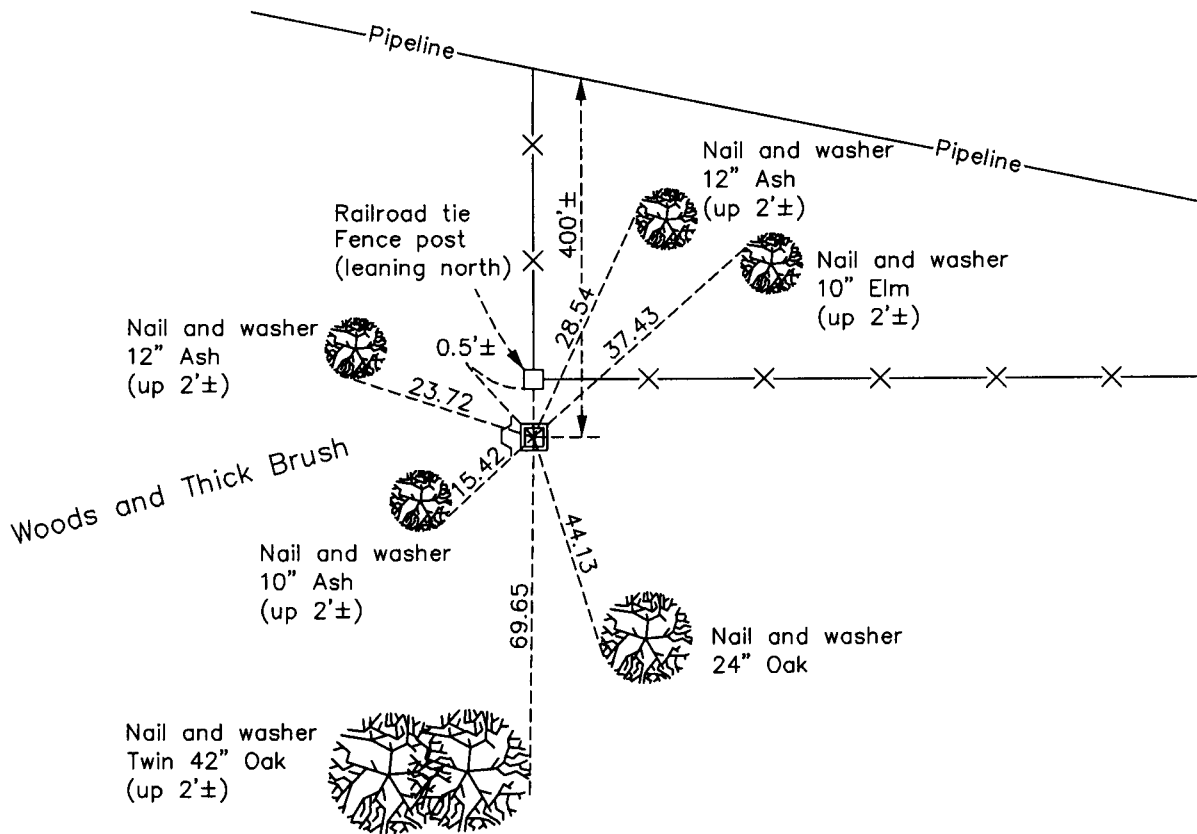

Revision Date

4/21/11

N.A.D. 1983 Coordinates
(1996 Adjustment)

County Project Coordinates	
Northing	185462.0639
Easting	492527.2769
Date	11/06/01

I hereby certify that this United States public land survey monument record is correct and complete to the best of my knowledge and belief.

Larry D. Hoium Date 4/21/11

Larry D. Hoium, Anoka County Surveyor

Minnesota License Number 18165