

CERTIFICATE OF LOCATION OF GOVERNMENT CORNER

County of Anoka

State of Minnesota

East 1/4 Corner of Sec. 18 Township 32 Range 24

On the 12th day of July, 1963, the described corner was evidenced by an old rotted post from N.C. Hoium's ties

and to perpetuate the location of said corner, at the exact location thereof, a permanent marker was placed consisting of a red and white 2" square steel Telspar monument

AND on the 2nd day of November, 2010, said permanent marker was found and the ties were updated. A sign, facing south, was attached to monument.

Updated reference ties are as shown below.

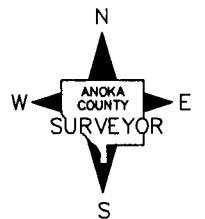
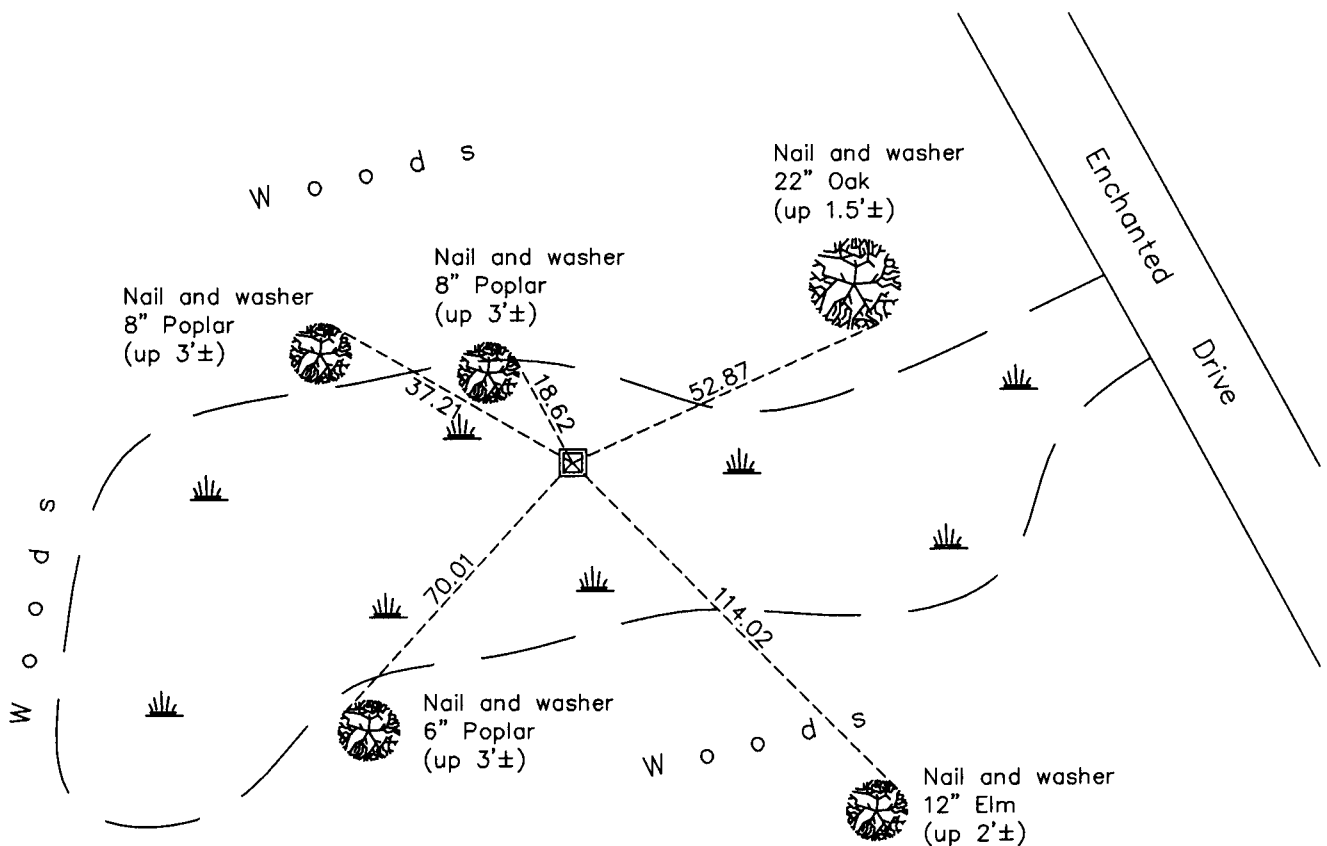

Revision Date

4/27/11

N.A.D. 1983 Coordinates
(1996 Adjustment)

| County Project Coordinates | |
|----------------------------|-------------|
| Northing | 183041.2743 |
| Easting | 474144.0017 |
| Date | 11/07/01 |

I hereby certify that this United States public land survey monument record is correct and complete to the best of my knowledge and belief.

Larry D. Hoium Date 4/27/11

Larry D. Hoium, Anoka County Surveyor

Minnesota License Number 18165