

CERTIFICATE OF LOCATION OF GOVERNMENT CORNER

County of Anoka

State of Minnesota

North 1/4 Corner of Sec. 19 Township 32 Range 24

On the 2nd day of July, 1963, the described corner was evidenced by area resurvey

and to perpetuate the location of said corner, at the exact location thereof, a permanent marker was placed consisting of a partial cast iron monument set in concrete

AND on the 16th day of May, 2011, said permanent marker was replaced with a new cast iron monument and the ties were updated

Updated reference ties are as shown below.

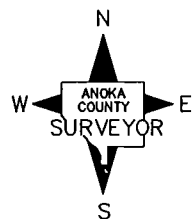
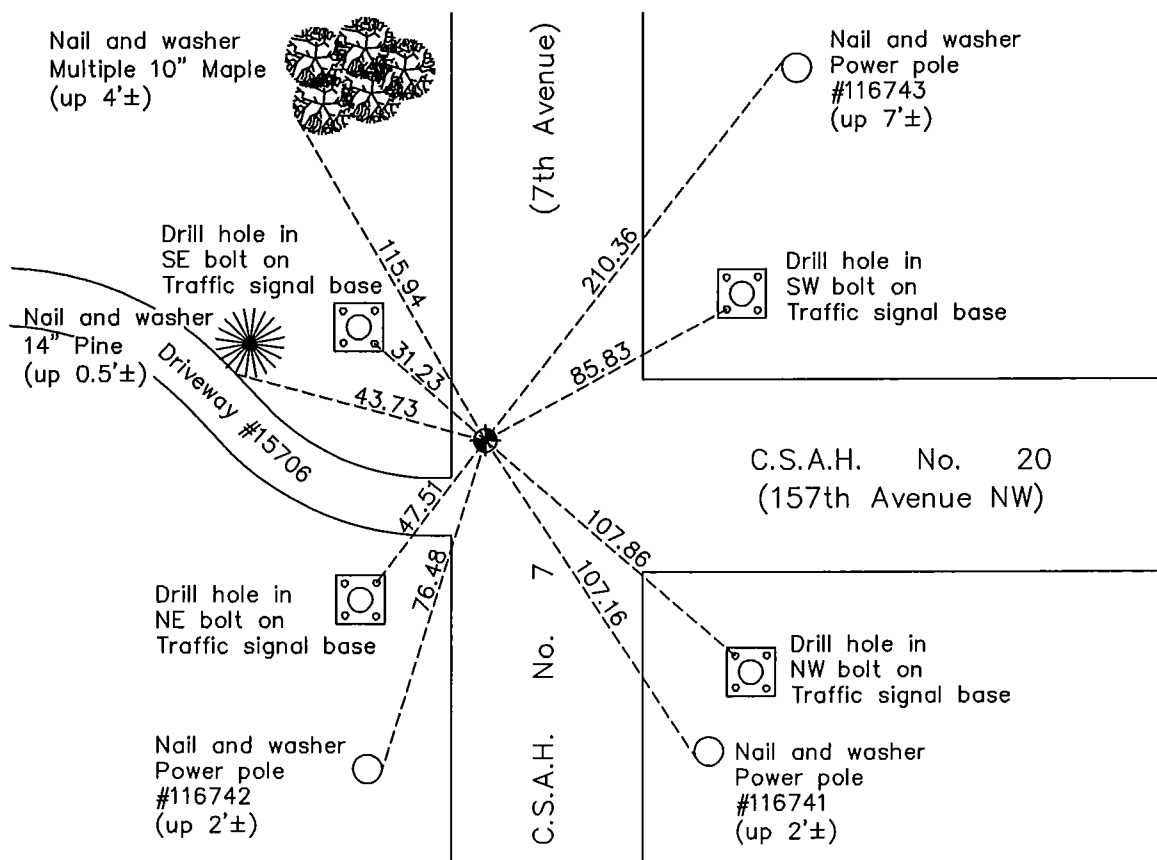

N.A.D. 1983 Coordinates
(1996 Adjustment)

County Project Coordinates	
Northing	180395.3983
Easting	471469.0496
Date	10/04/00

I hereby certify that this United States public land survey monument record is correct and complete to the best of my knowledge and belief.

Larry D. Holum Date 8/17/11

Larry D. Holum, Anoka County Surveyor

Minnesota License Number 18165

Revision Date
8/17/11