

# CERTIFICATE OF LOCATION OF GOVERNMENT CORNER

County of Anoka

State of Minnesota

## South 1/4 Corner of Sec. 21 Township 32 Range 24

On the 10th day of August, 1960, the described corner was evidenced by a 1 1/2" iron pipe with round field stone

and to perpetuate the location of said corner, at the exact location thereof, a permanent marker was placed consisting of a cast iron monument

AND on the 11th day of October, 2010, said permanent marker was found down 0.6'± and the ties were updated

Updated reference ties are as shown below.

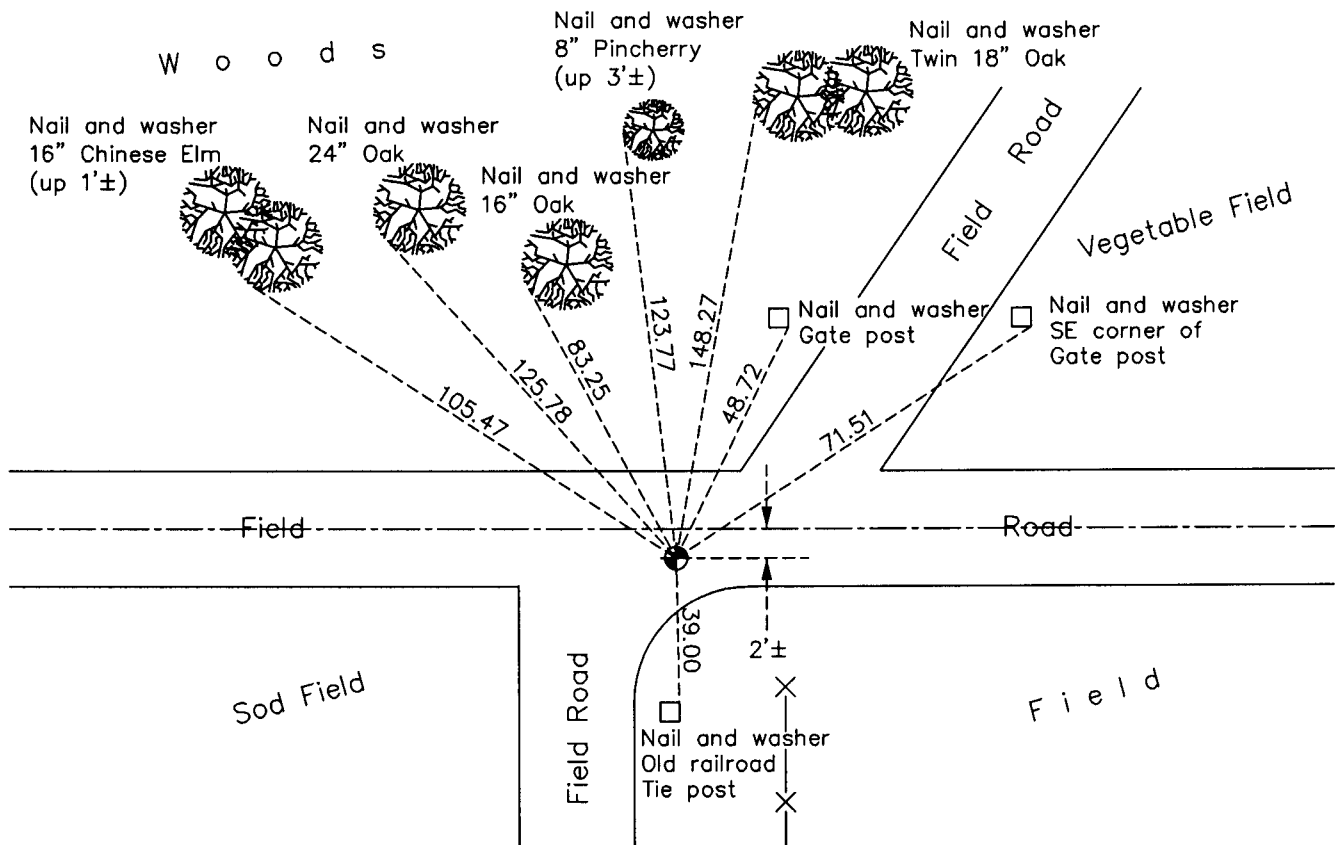

N

ANOKA COUNTY SURVEYOR

S

Revision Date

5/23/11

N.A.D. 1983 Coordinates  
(1996 Adjustment)

County Project Coordinates	
Northing	<u>175101.1682</u>
Easting	<u>481956.1742</u>
Date	<u>11/06/01</u>

I hereby certify that this United States public land survey monument record is correct and complete to the best of my knowledge and belief.

*Larry D. Hoium* Date 5/23/11

Larry D. Hoium, Anoka County Surveyor

Minnesota License Number 18165