

CERTIFICATE OF LOCATION OF GOVERNMENT CORNER

County of Anoka

State of Minnesota

North 1/4 Corner of Sec. 36 Township 32 Range 24

On the 15th day of February, 1968, the described corner was evidenced by a granite monument

and to perpetuate the location of said corner, at the exact location thereof, a permanent marker was placed consisting of the same granite monument with a sign and post on the north side

AND on the 7th day of December, 2010, said permanent marker was found leaning south and up 0.2'±. The ties were updated

Updated reference ties are as shown below.

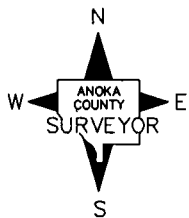
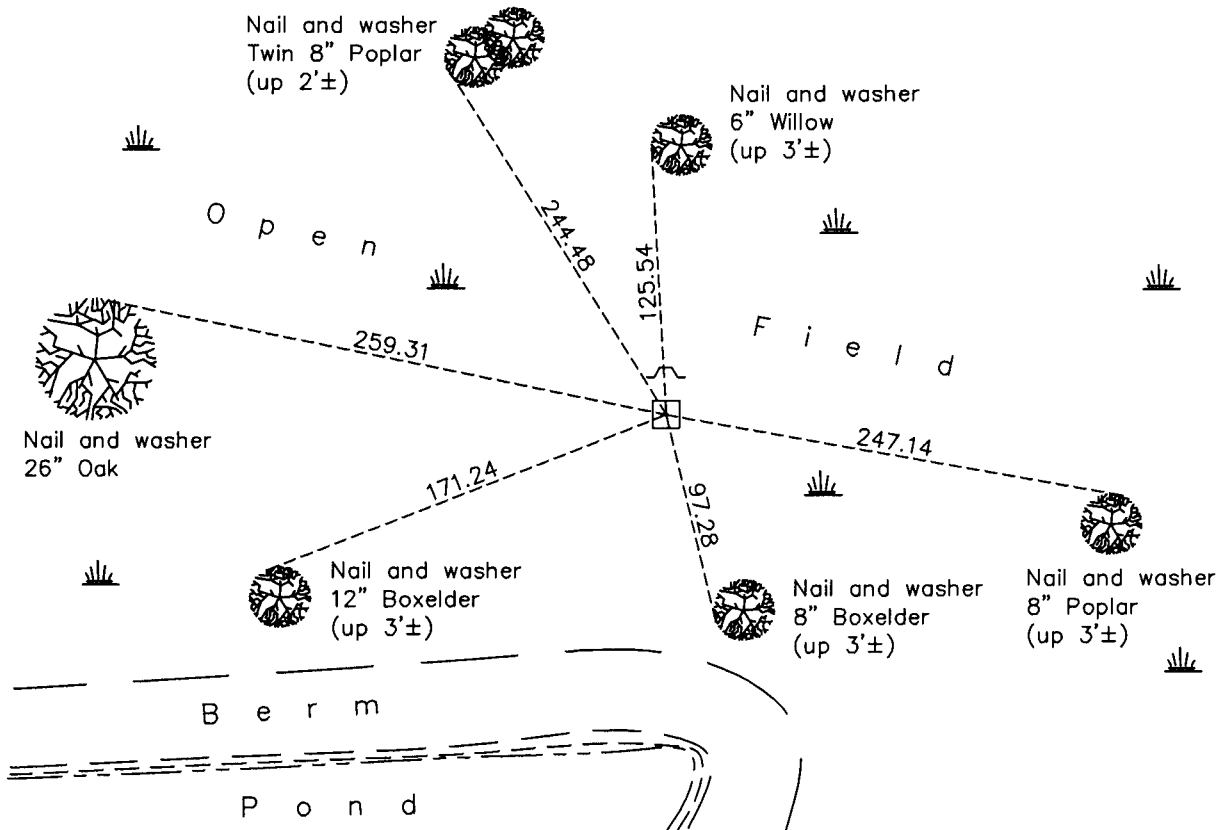

Revision Date

6/10/11

N.A.D. 1983 Coordinates
(1996 Adjustment)

County Project Coordinates	
Northing	<u>169610.8210</u>
Easting	<u>497682.2009</u>
Date	<u>11/30/00</u>

I hereby certify that this United States public land survey monument record is correct and complete to the best of my knowledge and belief.

Larry D. Hoium Date 6/10/11

Larry D. Hoium, Anoka County Surveyor

Minnesota License Number 18165