

CERTIFICATE OF LOCATION OF GOVERNMENT CORNER

County of Anoka

State of Minnesota

South 1/4 Corner of Sec. 27 Township 32 Range 24

On the 10th day of August, 1960, the described corner was evidenced by a steel fence post

and to perpetuate the location of said corner, at the exact location thereof, a permanent marker was placed consisting of a red and white iron pipe with a sign attached

AND on the 4th day of November, 2010, said permanent marker was found with the sign facing east and the ties were updated

Updated reference ties are as shown below.

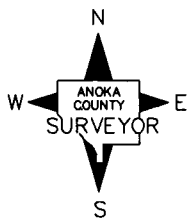
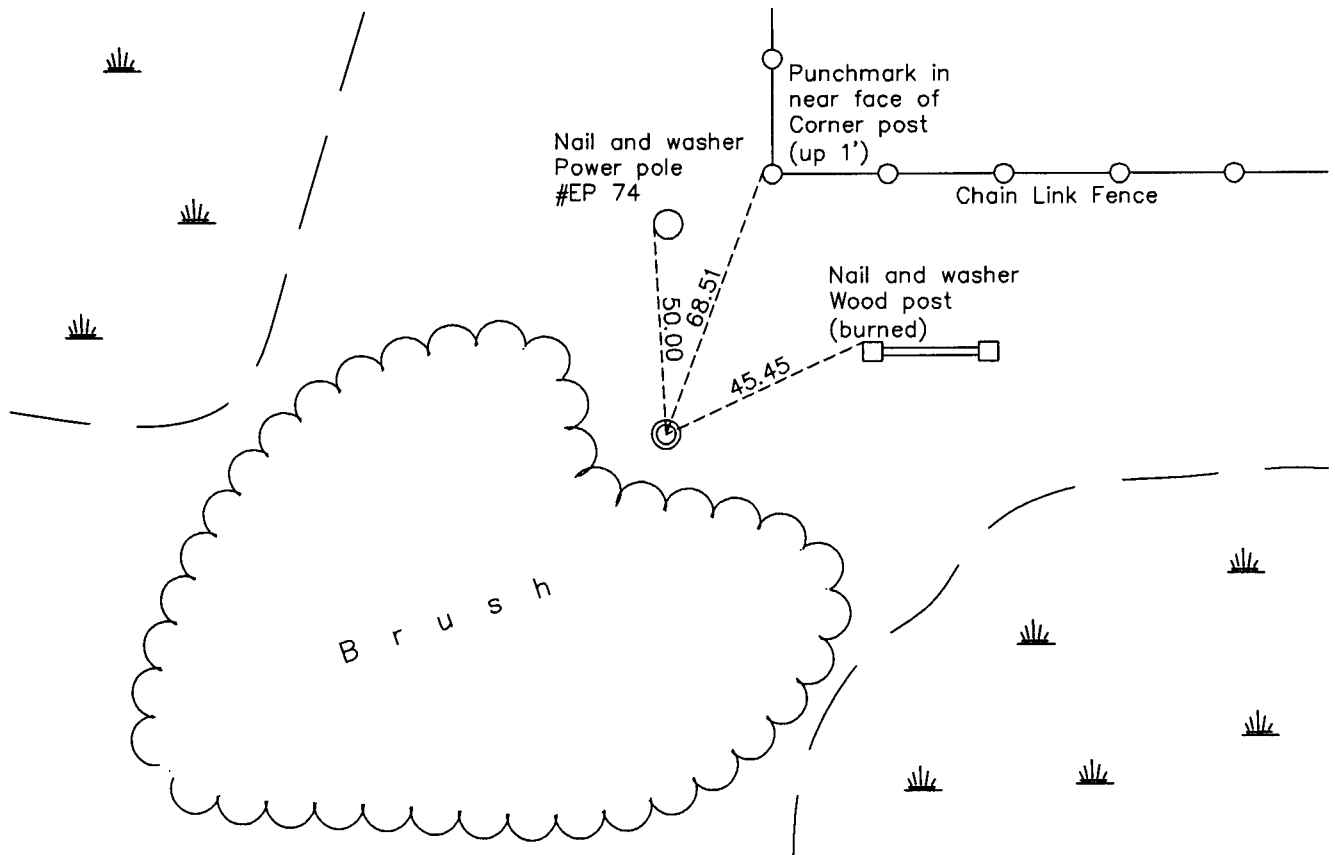

Revision Date

6/13/11

N.A.D. 1983 Coordinates
(1996 Adjustment)

County Project Coordinates	
Northing	<u>169789.1123</u>
Easting	<u>487176.0634</u>
Date	<u>8/10/88</u>

I hereby certify that this United States public land survey monument record is correct and complete to the best of my knowledge and belief.

Larry D. Hoium Date 6/13/11

Larry D. Hoium, Anoka County Surveyor

Minnesota License Number 18165