

# CERTIFICATE OF LOCATION OF GOVERNMENT CORNER

County of Anoka

State of Minnesota

## East 1/4 Corner of Sec. 31 Township 32 Range 24

On the \_\_\_\_ day of July, 1956, the described corner was evidenced by a 1" iron pipe  
in an old rotted post

and to perpetuate the location of said corner, at the exact location thereof, a permanent marker  
was placed consisting of a red and white iron pipe

AND on the 9th day of December, 2010, said permanent marker was found up 4'± and the  
ties were updated

Updated reference ties are as shown below.

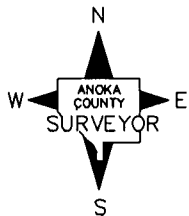
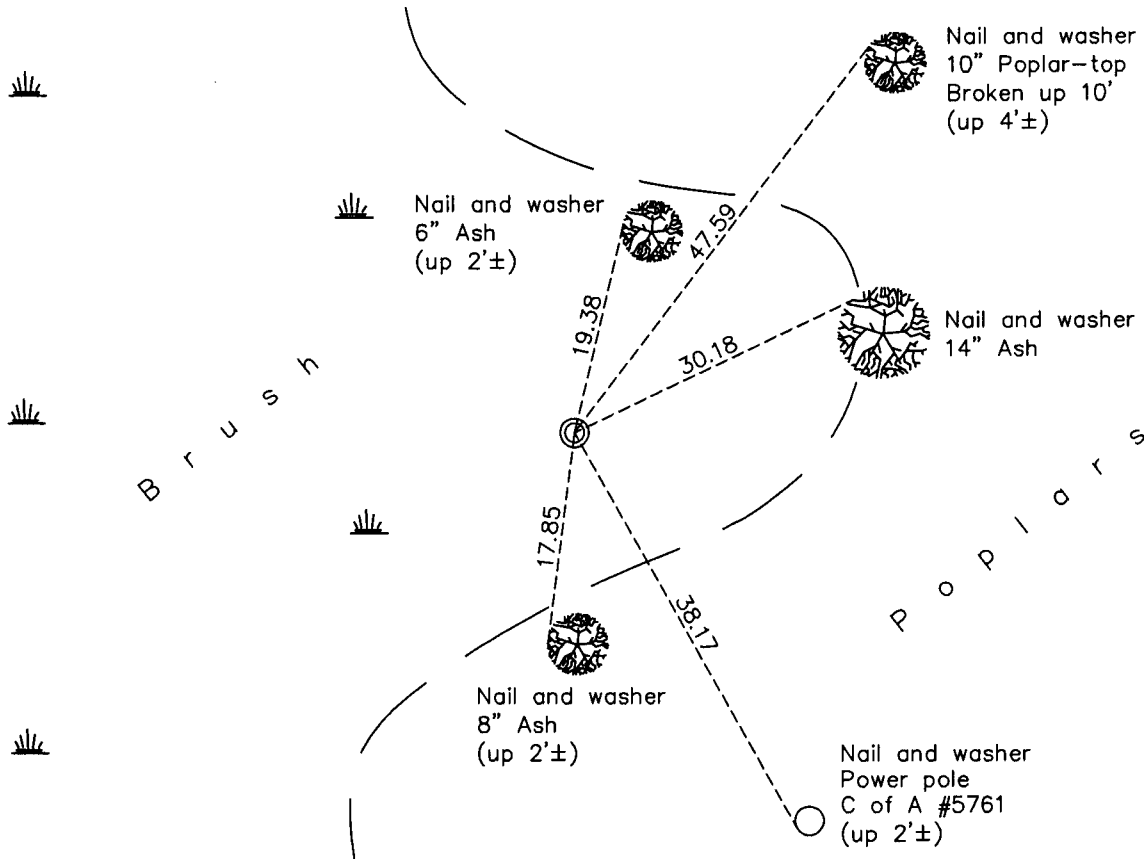

Revision Date

6/22/11

N.A.D. 1983 Coordinates  
(1996 Adjustment)

County Project Coordinates	
Northing	167216.4311
Easting	473978.7559
Date	12/01/00

I hereby certify that this United States public land survey monument record is correct and complete to the best of my knowledge and belief.

*Larry D. Hoium* Date 6/22/11

Larry D. Hoium, Anoka County Surveyor

Minnesota License Number 18165