

# CERTIFICATE OF LOCATION OF GOVERNMENT CORNER

County of Anoka

State of Minnesota

North 1/4 Corner of Sec. 4 Township 32 Range 23

I hereby certify that on the 10th day of August, 1962, I found the described corner which was evidenced by a cast iron monument set by N. C. Hoium

and I further certify that to perpetuate the location of said corner, I did, at the exact location thereof, place a permanent marker consisting of a cast iron monument

which reference or witness monuments are located in the manner following:

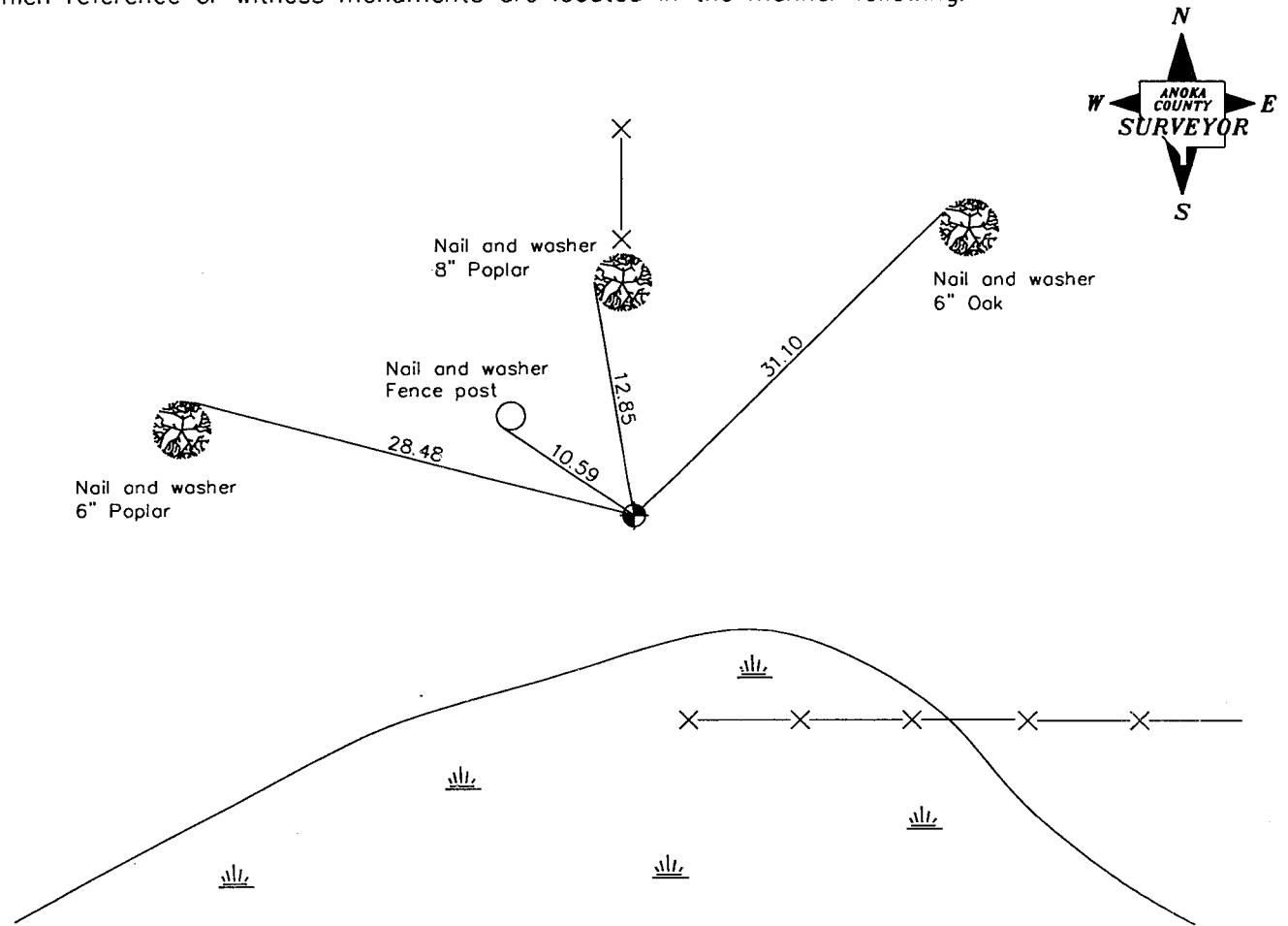

Revised date

11/7/90

N.A.D. 1983 Coordinates  
(1996 adjustment)

County Project Coordinates	State Plane Coordinates
Northing <u>195748.3056</u>	Y _____
Easting <u>513590.8237</u>	X _____

Date \_\_\_\_\_