

# CERTIFICATE OF LOCATION OF GOVERNMENT CORNER

County of Anoka

State of Minnesota

## North $\frac{1}{4}$ Corner of Sec. 6 Township 32 Range 23

On the 21st day of November, 1978, the described corner was evidenced by area resurvey

and to perpetuate the location of said corner, at the exact location thereof, a permanent marker was placed consisting of a red and white 2" square steel Telspar monument with a sign attached

AND on the 10th day of March, 2011, said permanent marker was found up 5'± with a sign facing north and the ties were updated

Updated reference ties are as shown below.

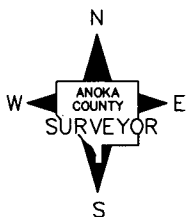
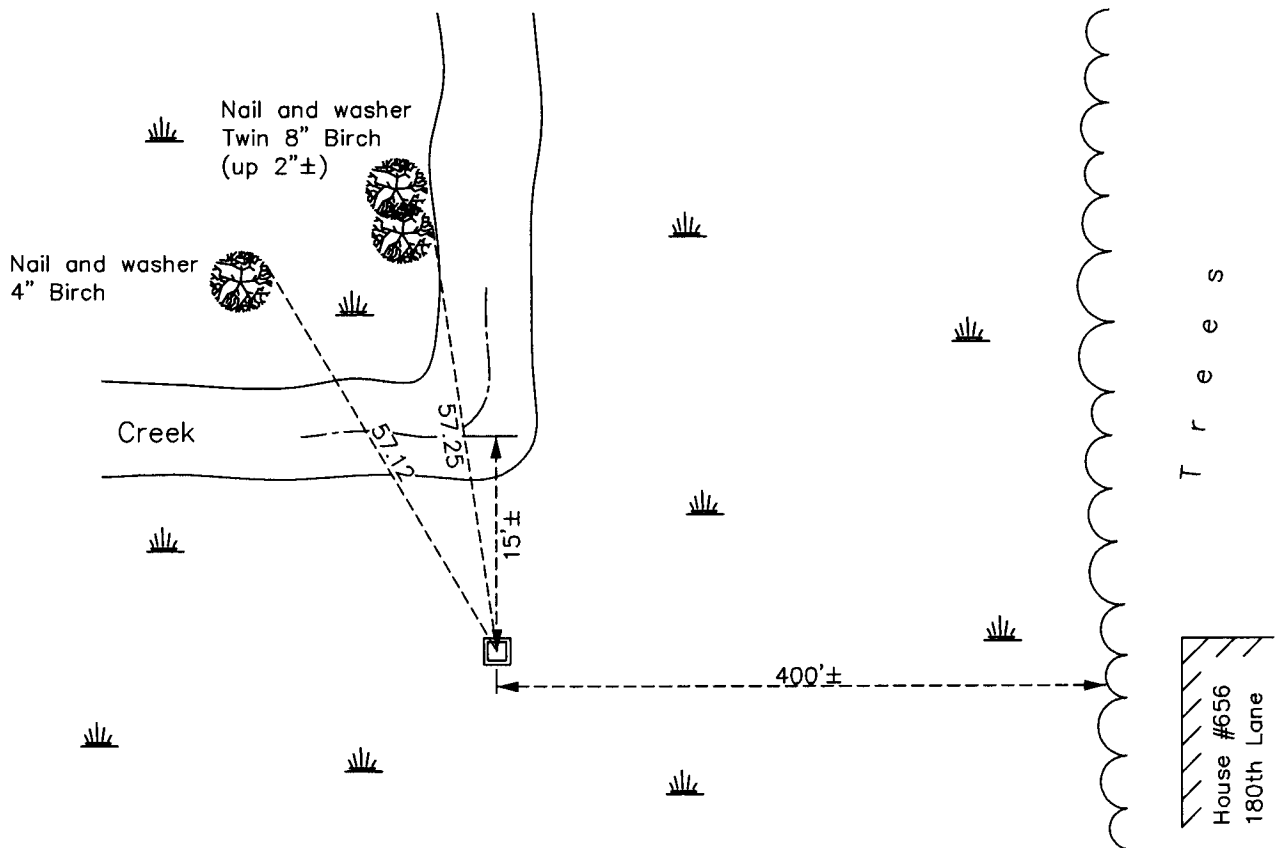

Revision Date

8/24/11

N.A.D. 1983 Coordinates  
(1996 Adjustment)

County Project Coordinates	
Northing	195826.0137
Easting	503070.3057
Date	1/02/02

I hereby certify that this United States public land survey monument record is correct and complete to the best of my knowledge and belief.

*Larry D. Hoium* Date 8/24/11

Larry D. Hoium, Anoka County Surveyor

Minnesota License Number 18165