

# CERTIFICATE OF LOCATION OF GOVERNMENT CORNER

County of Anoka

State of Minnesota

## East 1/4 Corner of Sec. 12 Township 32 Range 23

On the 30th day of April, 1965, the described corner was evidenced by a concrete monument

and to perpetuate the location of said corner, at the exact location thereof, a permanent marker was placed consisting of a cast iron monument

AND on the 18th day of March, 2011, said permanent marker was found up 0.3'± and the ties were updated. On April 27, 2011 set sign and post on the east side.

Updated reference ties are as shown below.

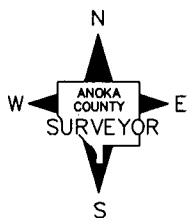
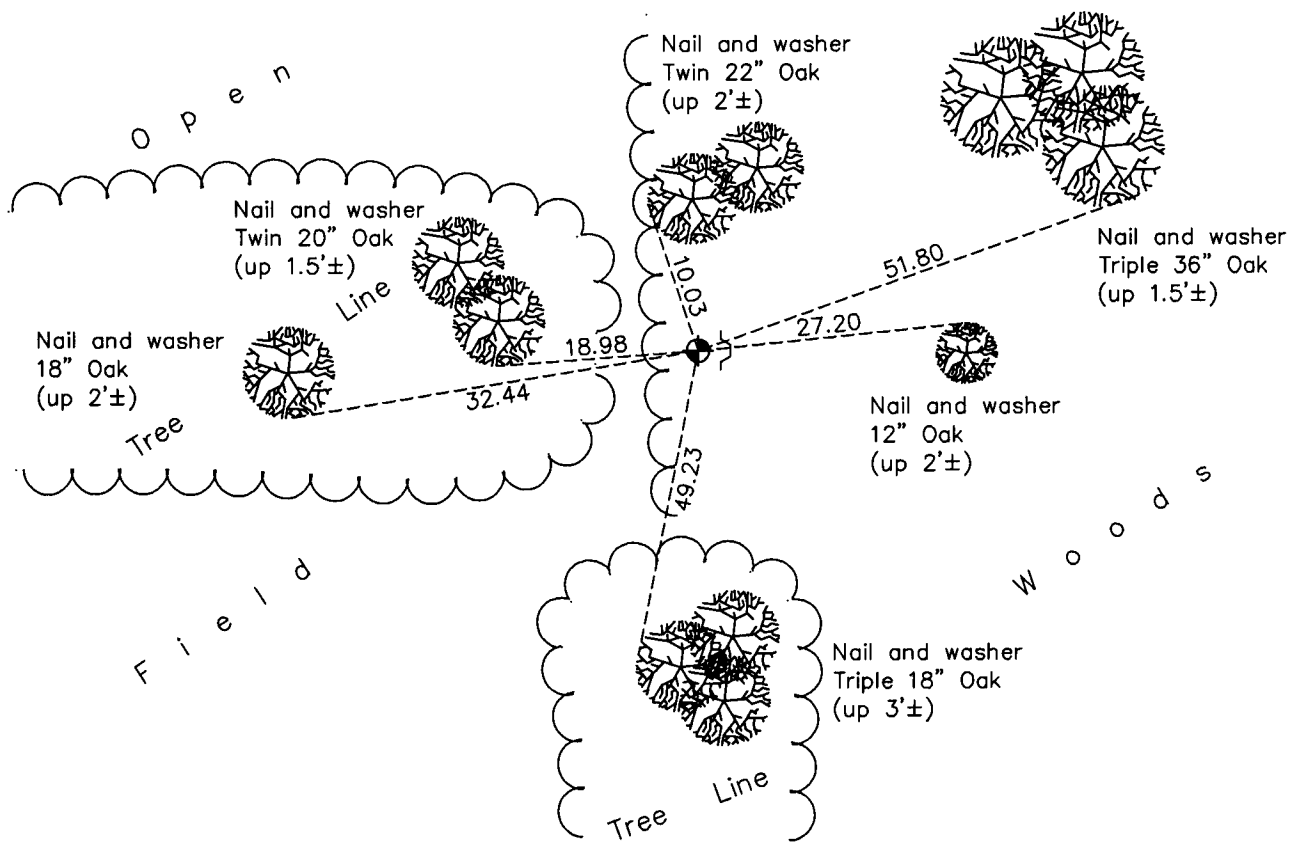

Revision Date  
9/08/11

N.A.D. 1983 Coordinates  
(1996 Adjustment)

County Project Coordinates	
Northing	<u>187769.1920</u>
Easting	<u>532043.0894</u>
Date	<u>1/28/02</u>

I hereby certify that this United States public land survey monument record is correct and complete to the best of my knowledge and belief.

*Larry D. Hoium* Date 9/08/11

Larry D. Hoium, Anoka County Surveyor

Minnesota License Number 18165