

# CERTIFICATE OF LOCATION OF GOVERNMENT CORNER

County of Anoka

State of Minnesota

Witness Corner of Sec. 24 Township 32 Range 23  
(on north line of NE1/4)

On the 10th day of October, 1988, the described corner was evidenced by area resurvey

and to perpetuate the location of said corner, at the exact location thereof, a permanent marker was placed consisting of a cast iron monument with a sign and post on the north side

AND on the 4th day of April, 2011, said permanent marker was found down 0.5'± and the ties were updated

Updated reference ties are as shown below.

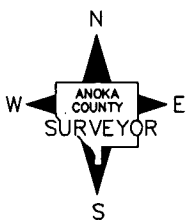
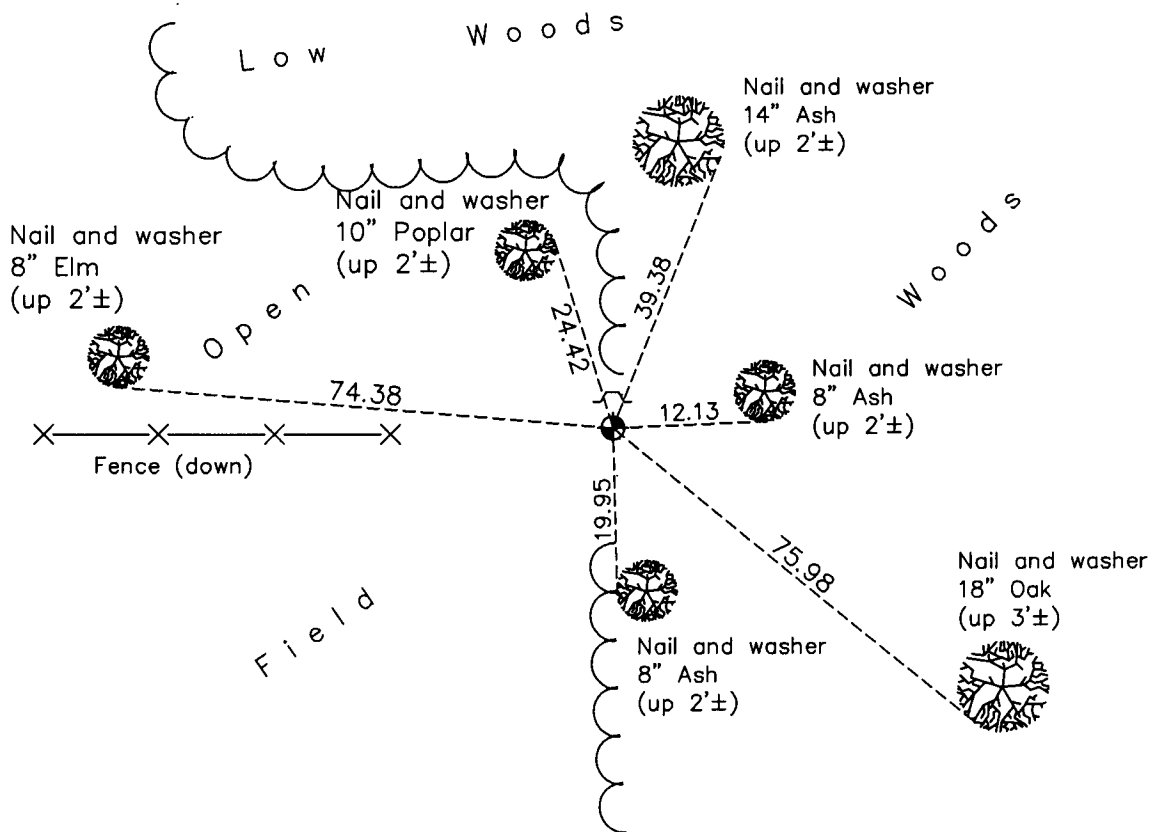

Revision Date

**9/15/11**

N.A.D. 1983 Coordinates  
(1996 Adjustment)

County Project Coordinates	
Northing	179920.6478
Easting	530563.6018
Date	2/14/02

I hereby certify that this United States public land survey monument record is correct and complete to the best of my knowledge and belief.

*Larry D. Hoium* Date 9/15/11

Larry D. Hoium, Anoka County Surveyor

Minnesota License Number 18165