

CERTIFICATE OF LOCATION OF GOVERNMENT CORNER

County of Anoka

State of Minnesota

Southwest Corner of Sec. 13 Township 32 Range 23

On the 3rd day of August, 1966, the described corner was evidenced by area resurvey

and to perpetuate the location of said corner, at the exact location thereof, a permanent marker was placed consisting of a cast iron monument

AND on the 17th day of May, 2011, said permanent marker was found laying in ditch and was replaced w/ 2" square steel Telspar monument w/ 'County Surveyor' cap & sign & post to north

Updated reference ties are as shown below.

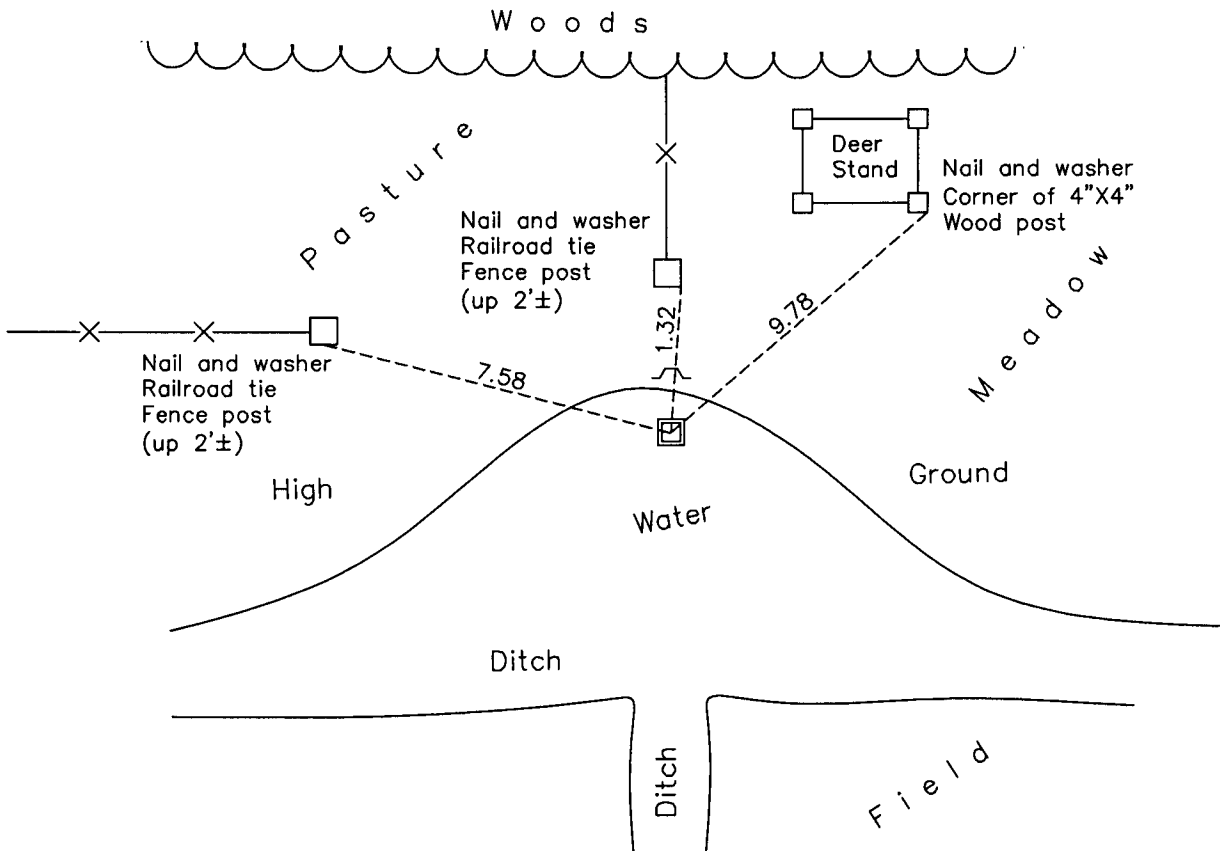

N
W ANOKA COUNTY SURVEYOR E
S
Revision Date
9/15/11

N.A.D. 1983 Coordinates
(1996 Adjustment)

County Project Coordinates	
Northing	180005.8596
Easting	526755.9055
Date	2/12/02

I hereby certify that this United States public land survey monument record is correct and complete to the best of my knowledge and belief.

Larry D. Hoium Date 9/15/11
 Larry D. Hoium, Anoka County Surveyor
 Minnesota License Number 18165