

# CERTIFICATE OF LOCATION OF GOVERNMENT CORNER

County of Anoka

State of Minnesota

## North 1/4 Corner of Sec. 20 Township 32 Range 23

On the 2nd day of November, 1970, the described corner was evidenced by a railroad spike

and to perpetuate the location of said corner, at the exact location thereof, a permanent marker was placed consisting of a cast iron monument

AND on the 25th day of May, 2011, said permanent marker was found broken down 2.2'± and was replaced with a new cast iron monument and the ties were updated

Updated reference ties are as shown below.

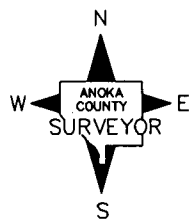
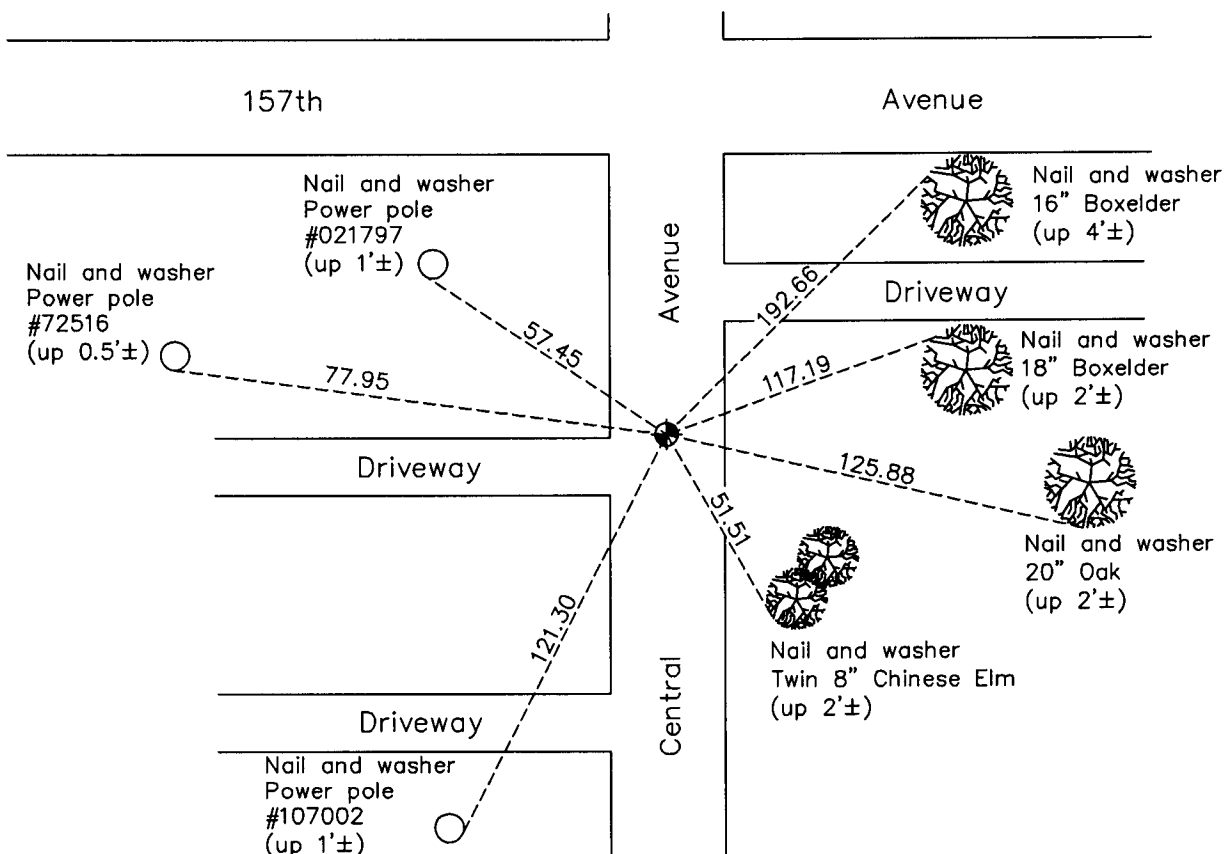

N.A.D. 1983 Coordinates  
(1996 Adjustment)

County Project Coordinates

Northing 180235.3813

Easting 508191.6265

Date 12/13/01

I hereby certify that this United States public land survey monument record is correct and complete to the best of my knowledge and belief.

*Larry D. Hoium* Date 9/21/11

Larry D. Hoium, Anoka County Surveyor

Minnesota License Number 18165

Revision Date

9/21/11