

CERTIFICATE OF LOCATION OF GOVERNMENT CORNER

County of Anoka

State of Minnesota

North 1/4 Corner of Sec. 29 Township 32 Range 23

On the 12th day of September, 1960, the described corner was evidenced by a brass plug

and to perpetuate the location of said corner, at the exact location thereof, a permanent marker was placed consisting of a cast iron monument

AND on the 20th day of May, 2011, said permanent marker was found leaning and broken. Replaced it with a new cast iron monument and updated ties.

Updated reference ties are as shown below.

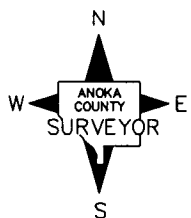
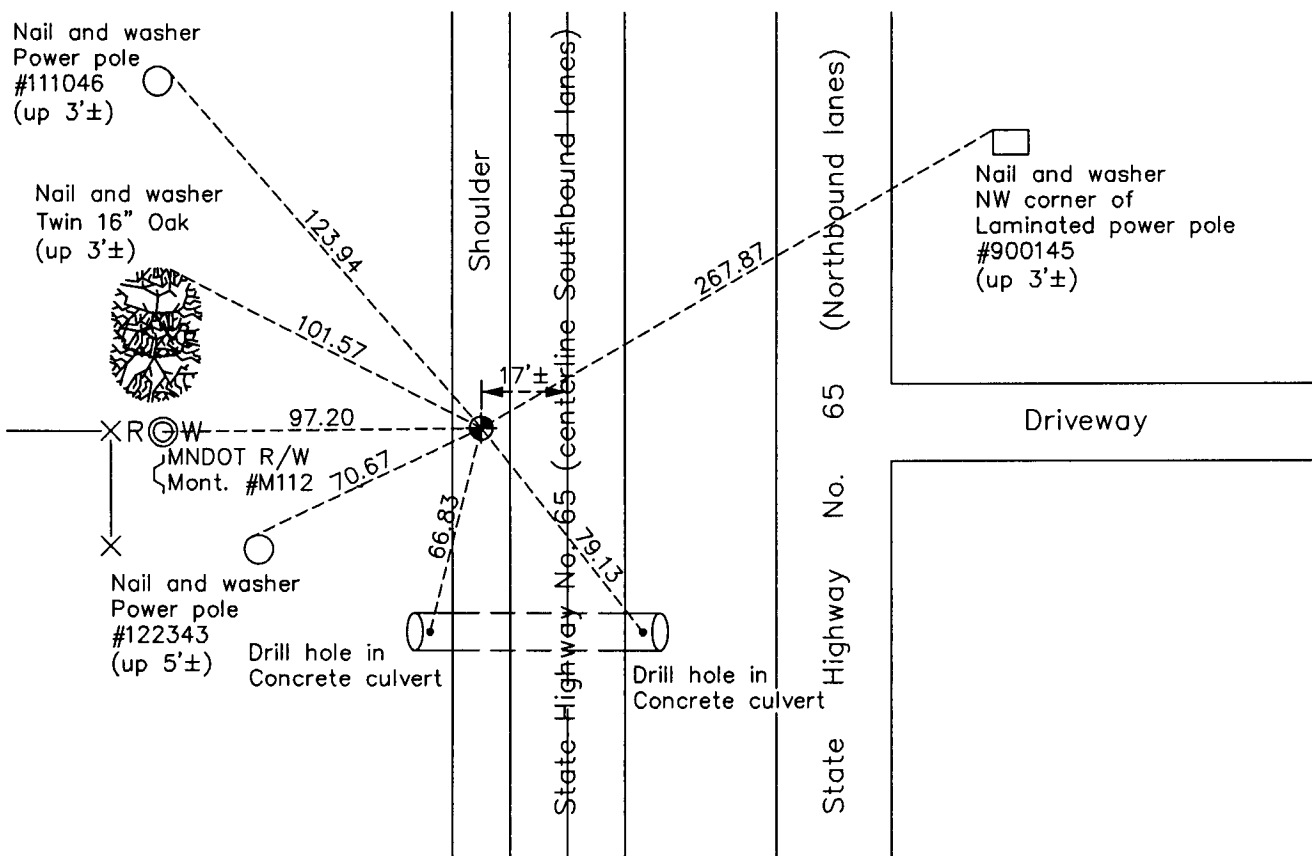

Revision Date
9/26/11

N.A.D. 1983 Coordinates
(1996 Adjustment)

County Project Coordinates	
Northing	174897.2589
Easting	508169.9824
Date	12/12/01

I hereby certify that this United States public land survey monument record is correct and complete to the best of my knowledge and belief.

Larry D. Hoium Date 9/26/11

Larry D. Hoium, Anoka County Surveyor

Minnesota License Number 18165