

CERTIFICATE OF LOCATION OF GOVERNMENT CORNER

County of Anoka

State of Minnesota

East 1/4 Corner of Sec. 25 Township 32 Range 23

On the 30th day of April, 1965, the described corner was evidenced by a concrete monument

and to perpetuate the location of said corner, at the exact location thereof, a permanent marker was placed consisting of the same concrete monument with a DNR sign and post on the north side

AND on the 7th day of March, 2011, said permanent marker was found down 0.4'± below the ice and the ties were updated

Updated reference ties are as shown below.

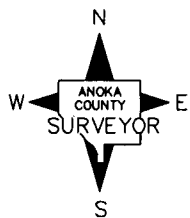
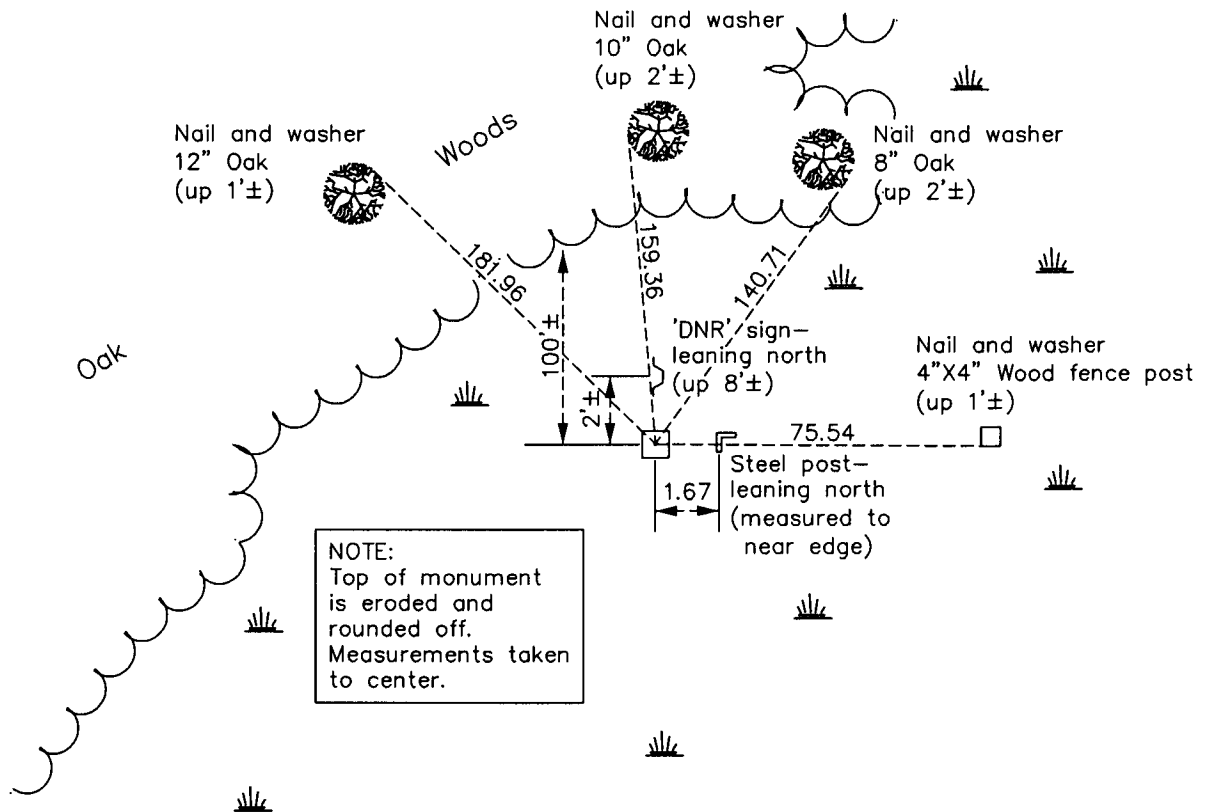

Revision Date

10/03/11

N.A.D. 1983 Coordinates
(1996 Adjustment)

County Project Coordinates

Northing 172023.1936

Easting 532001.5704

Date 3/05/02

I hereby certify that this United States public land survey monument record is correct and complete to the best of my knowledge and belief.

Larry D. Hoium Date 10/03/11

Larry D. Hoium, Anoka County Surveyor

Minnesota License Number 18165