

# CERTIFICATE OF LOCATION OF GOVERNMENT CORNER

County of Anoka

State of Minnesota

## Southeast Corner of Sec. 30 Township 32 Range 23

On the 15th day of August, 1960, the described corner was evidenced by an iron pipe

and to perpetuate the location of said corner, at the exact location thereof, a permanent marker was placed consisting of a cast iron monument with a sign and post on the north side

AND on the 21st day of April, 2011, said permanent marker was found and the ties were updated

Updated reference ties are as shown below.

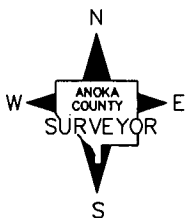
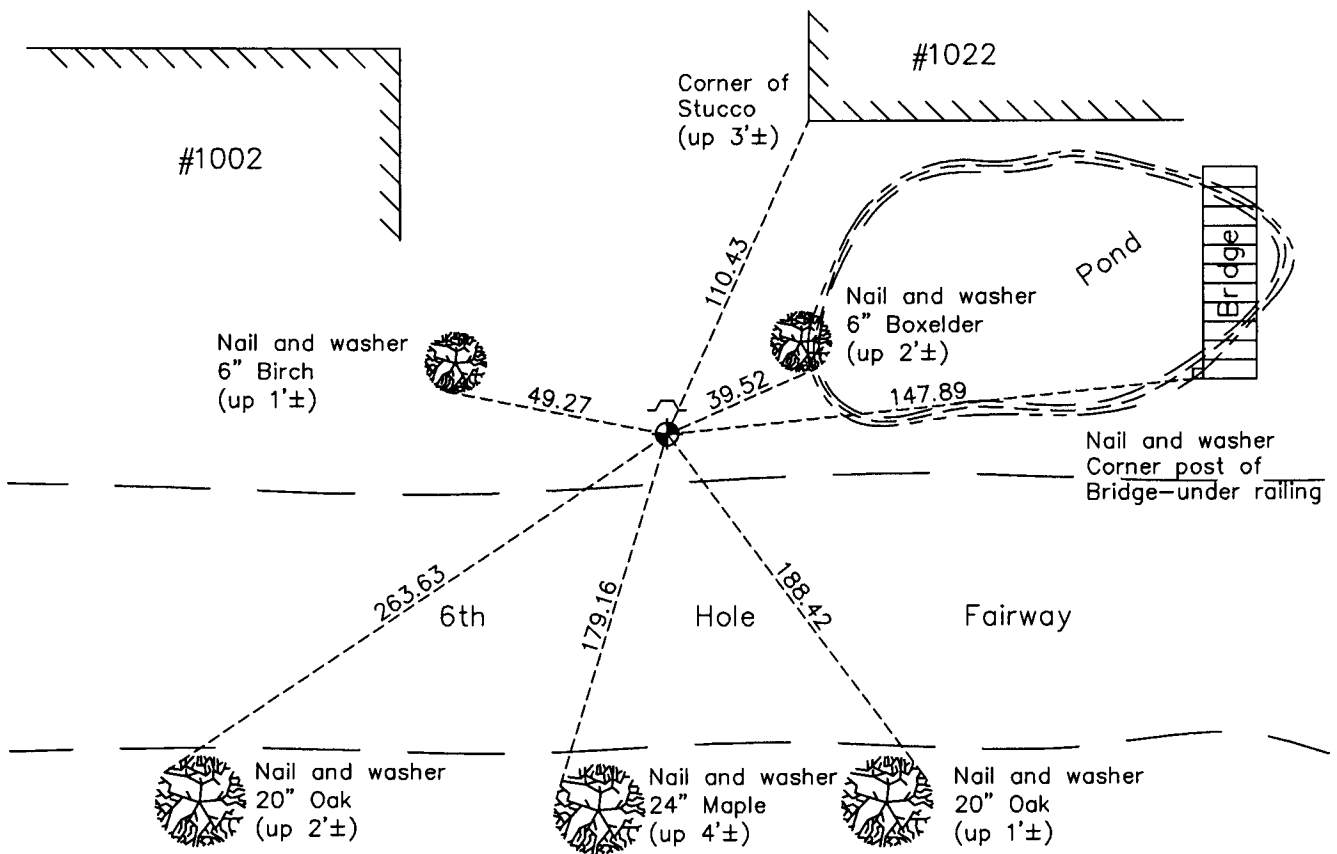

Revision Date  
10/07/11

N.A.D. 1983 Coordinates  
(1996 Adjustment)

County Project Coordinates	
Northing	169601.3299
Easting	505524.8464
Date	12/20/01

I hereby certify that this United States public land survey monument record is correct and complete to the best of my knowledge and belief.

*Larry D. Hoium* Date 10/07/11

Larry D. Hoium, Anoka County Surveyor

Minnesota License Number 18165