

CERTIFICATE OF LOCATION OF GOVERNMENT CORNER

County of Anoka

State of Minnesota

Witness Corner of Sec. 15 Township 31 Range 22
 (On south line of section)

On the 31st day of July, 1964, the described corner was evidenced by area resurvey

and to perpetuate the location of said corner, at the exact location thereof, a permanent marker was placed consisting of a cast iron monument

AND on the 4th day of April, 2011, said permanent marker was replaced by removing found rebar w/ RLS #23300 cap. Set red&white 2" square steel Telspar monument w/ punched cap.

Updated reference ties are as shown below.

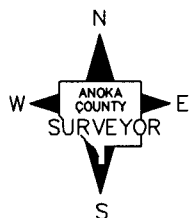
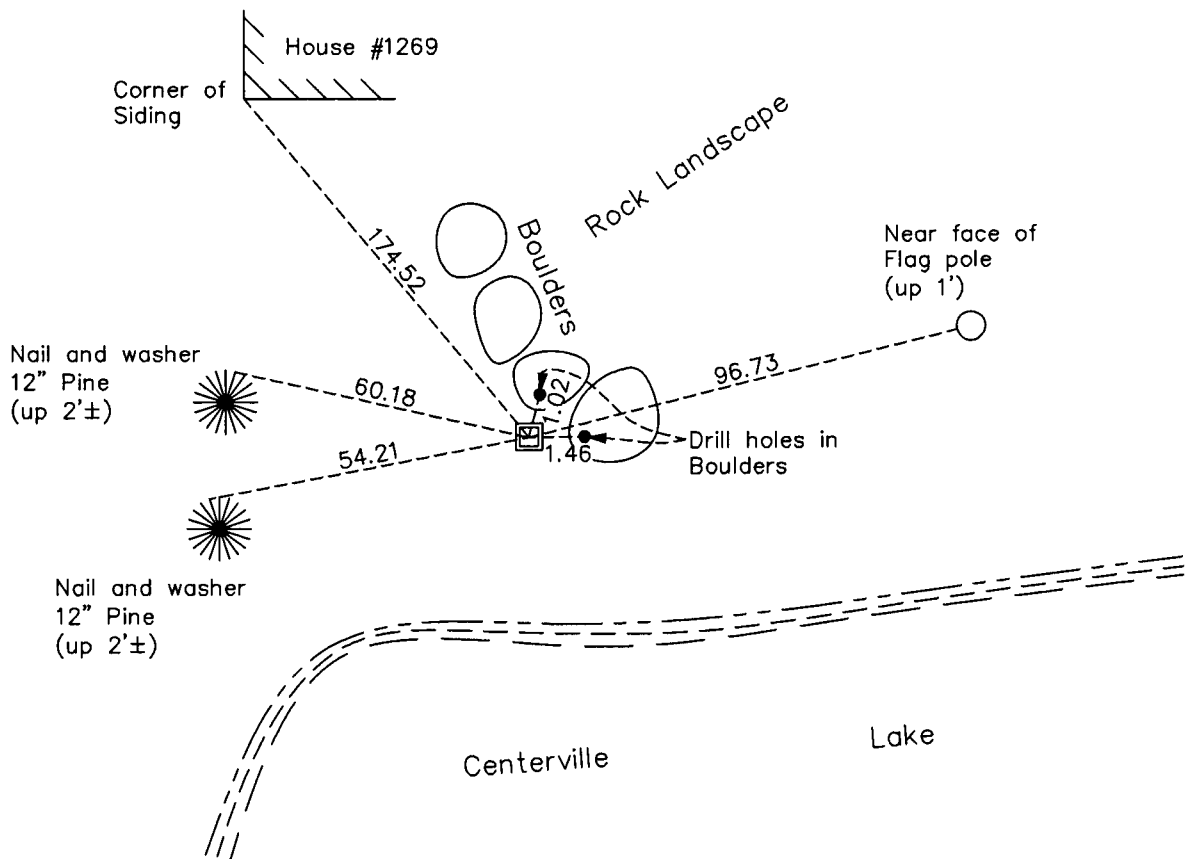

Revision Date

7/20/11

N.A.D. 1983 Coordinates
(1996 Adjustment)

| County Project Coordinates | |
|----------------------------|-------------|
| Northing | 148288.8855 |
| Easting | 548570.7290 |
| Date | 4/16/98 |

I hereby certify that this United States public land survey monument record is correct and complete to the best of my knowledge and belief.

Larry D. Hoium Date 7/20/11

Larry D. Hoium, Anoka County Surveyor

Minnesota License Number 18165