

CERTIFICATE OF LOCATION OF GOVERNMENT CORNER

County of Anoka

State of Minnesota

Witness Corner of Sec. 28 Township 31 Range 22

(on south line of SE 1/4)

On the 3rd day of January, 1992, the described corner was evidenced by area resurvey

and to perpetuate the location of said corner, at the exact location thereof, a permanent marker was placed consisting of a cast iron monument with a sign and post on the north side

AND on the 27th day of April, 2011, said permanent marker was found broken and was replaced with a new cast iron monument. The ties were updated.

Updated reference ties are as shown below.

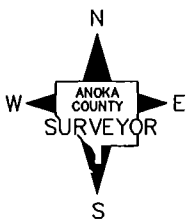
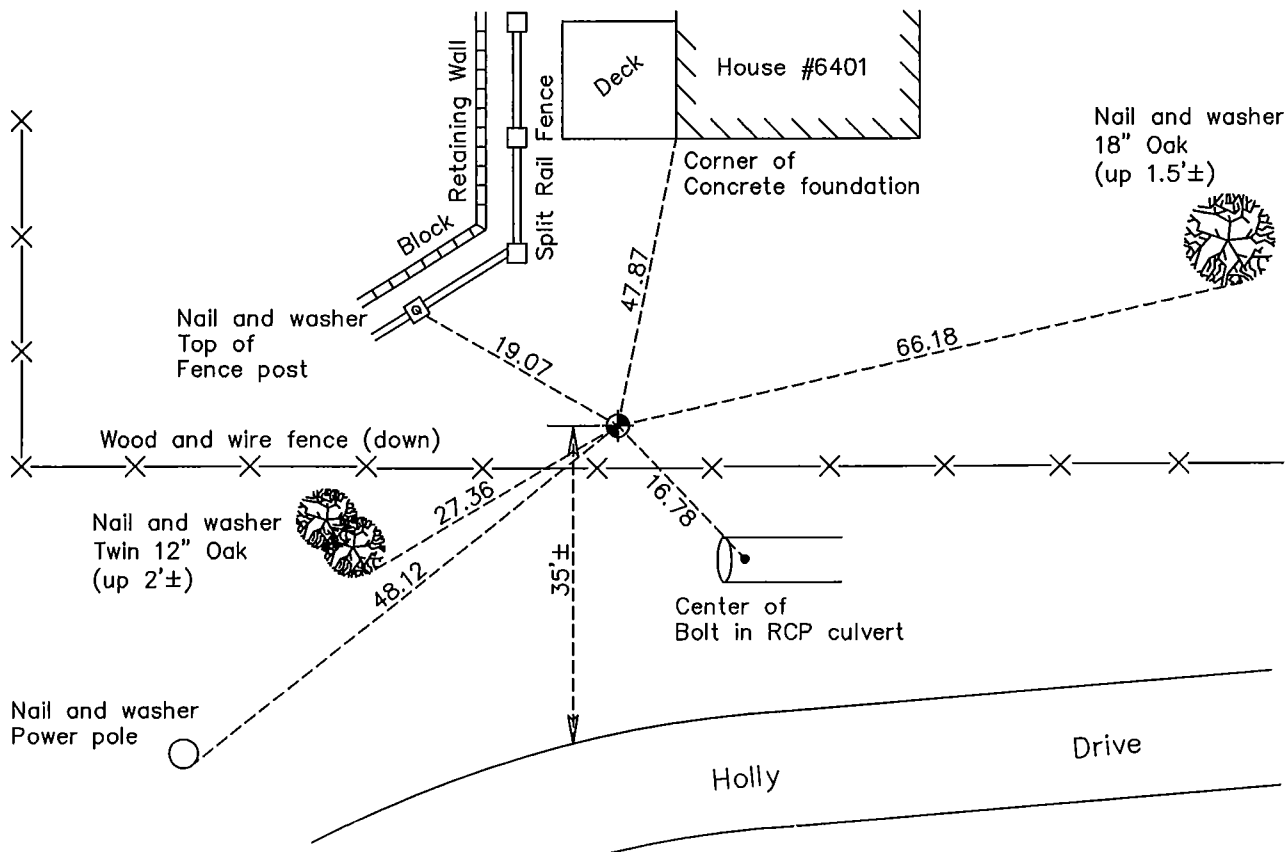

Revision Date
8/18/11

N.A.D. 1983 Coordinates
(1996 Adjustment)

County Project Coordinates	
Northing	137714.6703
Easting	546309.4833
Date	3/25/98

I hereby certify that this United States public land survey monument record is correct and complete to the best of my knowledge and belief.

Larry D. Hoium Date 8/18/11

Larry D. Hoium, Anoka County Surveyor
Minnesota License Number 18165