

CERTIFICATE OF LOCATION OF GOVERNMENT CORNER

County of Anoka

State of Minnesota

South 1/4 Corner of Sec. 34 Township 31 Range 22

On the 6th day of February, 1964, the described corner was evidenced by a 3/4" iron pipe

and to perpetuate the location of said corner, at the exact location thereof, a permanent marker was placed consisting of a cast iron monument with a sign and post on the southeast side

AND on the 5th day of April, 2011, said permanent marker was found down 4.5'±. Set additional cast iron monument on top of found cast iron monument. Sign and post is up 2'±.

Updated reference ties are as shown below.

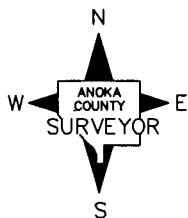
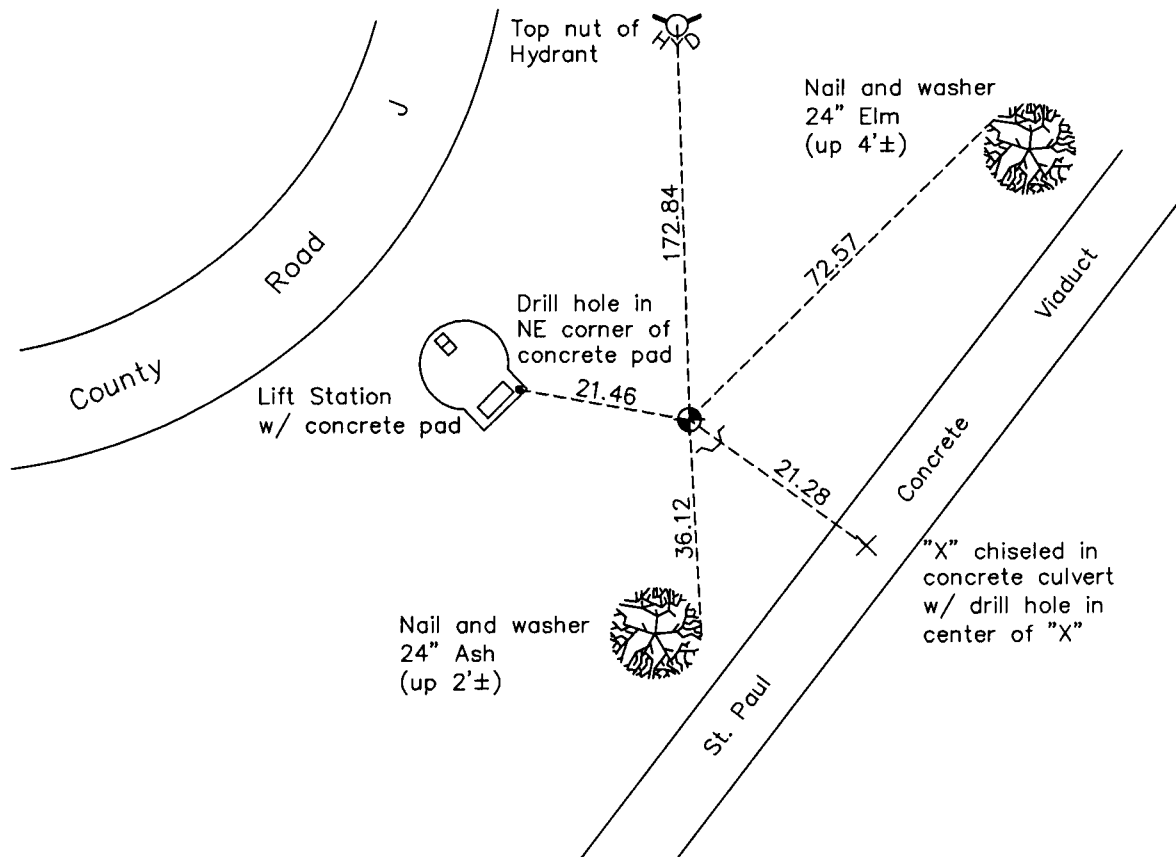

Revision Date

7/20/11

N.A.D. 1983 Coordinates
(1996 Adjustment)

County Project Coordinates	
Northing	<u>132433.5154</u>
Easting	<u>550466.4875</u>
Date	<u>3/26/98</u>

I hereby certify that this United States public land survey monument record is correct and complete to the best of my knowledge and belief.

Larry D. Hoium Date 7/20/11

Larry D. Hoium, Anoka County Surveyor

Minnesota License Number 18165