

CERTIFICATE OF LOCATION OF GOVERNMENT CORNER

County of Anoka

State of Minnesota

Northeast Corner of Sec. 1 Township 31 Range 24

On the 29th day of May, 1959, the described corner was evidenced by a granite monument

and to perpetuate the location of said corner, at the exact location thereof, a permanent marker was placed consisting of the same granite monument with a sign and post on the north side

AND on the 11th day of March, 2010, said permanent marker was found and the ties were updated

Updated reference ties are as shown below.

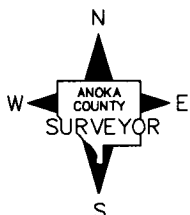
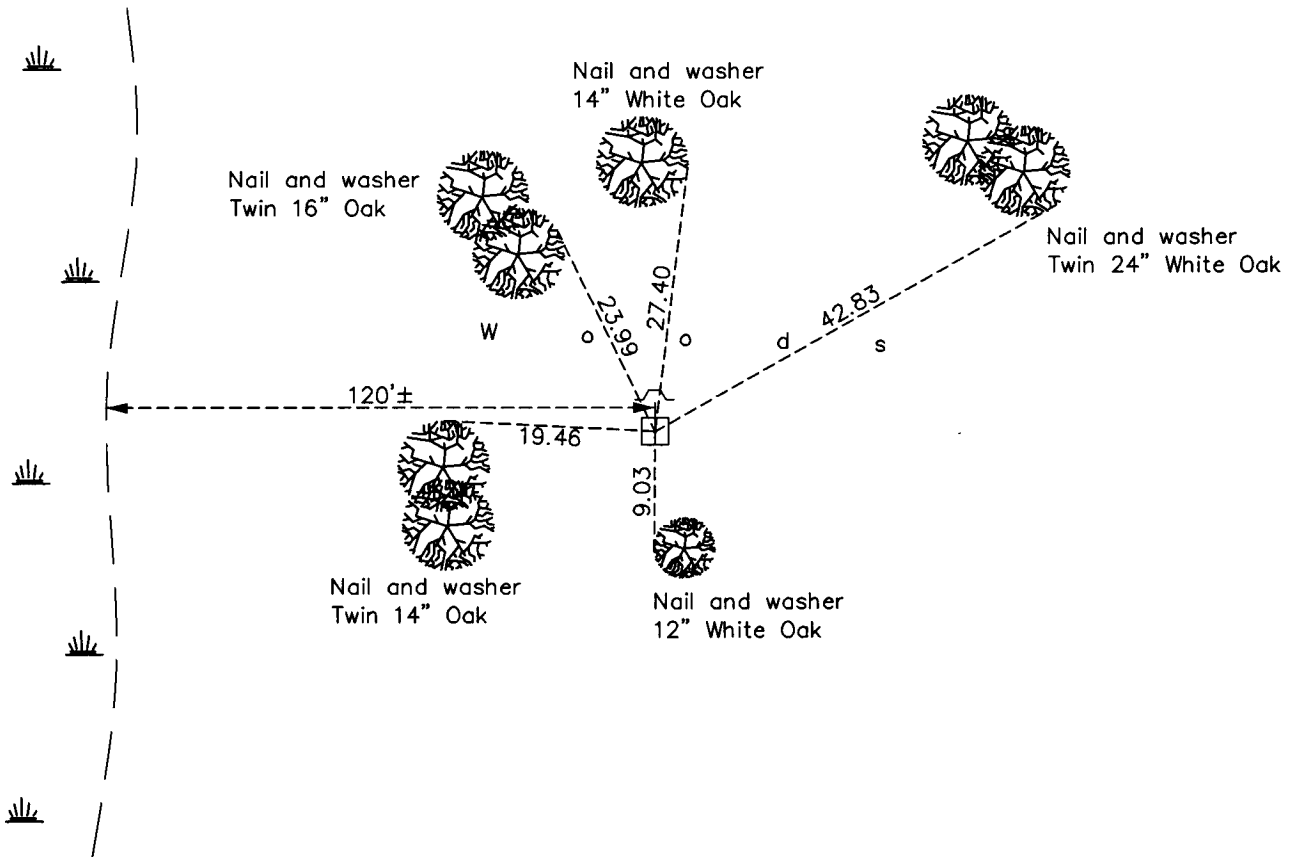

Revision Date
4/15/10

N.A.D. 1983 Coordinates
(1996 Adjustment)

County Project Coordinates	
Northing	164293.4322
Easting	500211.3207
Date	11/29/00

I hereby certify that this United States public land survey monument record is correct and complete to the best of my knowledge and belief.

Date 4/10/10

 Larry D. Hoium, Anoka County Surveyor
 Minnesota License Number 18165

HISTORY OF GOVERNMENT CORNER

County of Anoka

State of Minnesota

Northeast Corner of Sec. 1 Township 31 Range 24

CORNER HISTORY:

May 29, 1959 - Found granite monument. Established ties to monument.

June 8, 1964 - Found granite monument and updated ties.

July 11, 1966 - Found granite monument and updated ties.

July 22, 1970 - Found granite monument and updated ties.

July 1, 1974 - Found granite monument and updated ties.

June 27, 1977 - Found granite monument and updated ties.

November 8, 1983 - Found granite monument and updated ties.

June 20, 1986 - Found granite monument and updated ties.

August 25, 1994 - Found granite monument and updated ties.

February 4, 2000 - Found granite monument and updated ties.

November 29, 2000 - Found granite monument and established NAD 1983 (1996 Adjustment) Anoka County Project Coordinates by Static GPS methods. Updated ties.

March 11, 2010 - Found granite monument with a sign and post on the north side and updated ties.