

CERTIFICATE OF LOCATION OF GOVERNMENT CORNER

County of Anoka

State of Minnesota

North 1/4 Corner of Sec. 1 Township 31 Range 24

On the 15th day of December, 1944, the described corner was evidenced by a concrete monument

and to perpetuate the location of said corner, at the exact location thereof, a permanent marker was placed consisting of a cast iron monument with a sign and post on the north side

AND on the 11th day of March, 2010, said permanent marker was found down 0.2' and the ties were updated

Updated reference ties are as shown below.

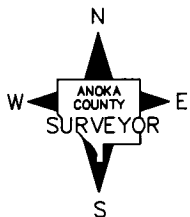
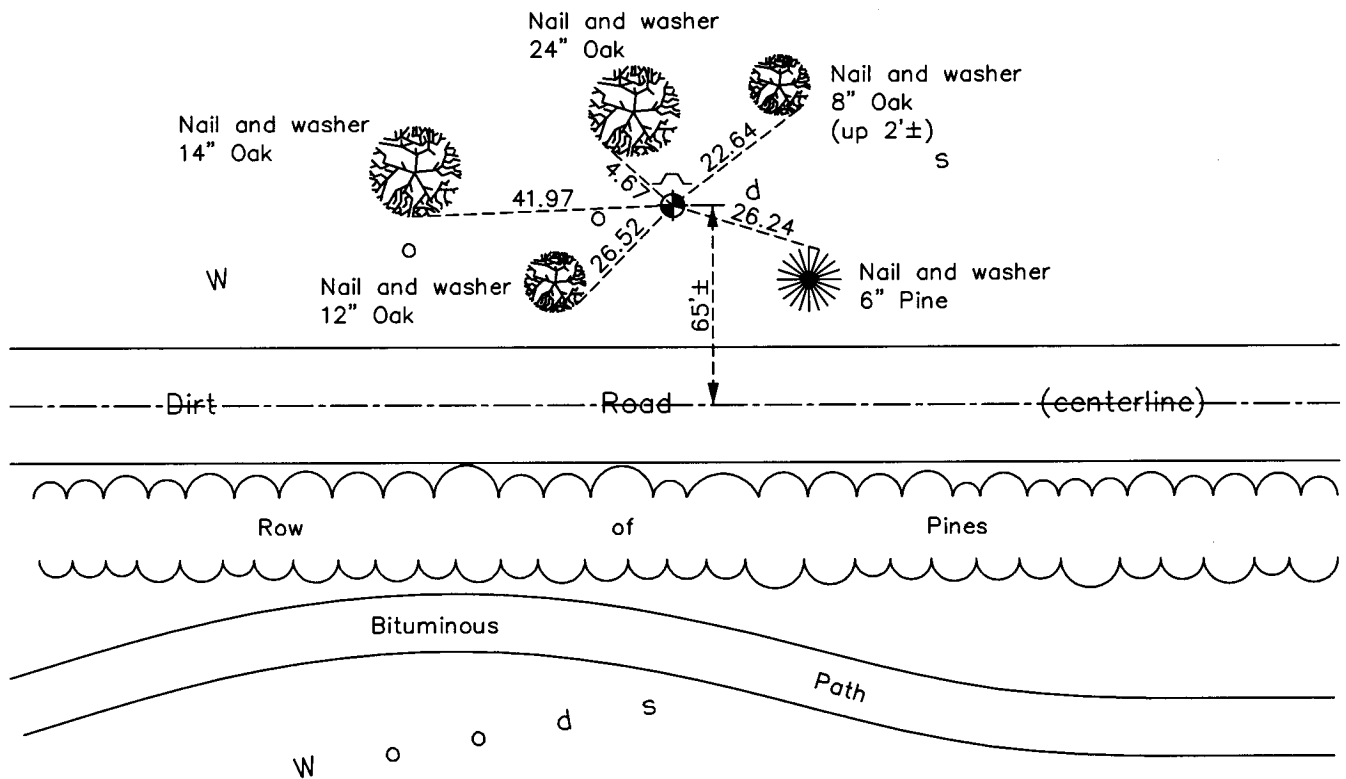

Revision Date
4/16/10

N.A.D. 1983 Coordinates
(1996 Adjustment)

County Project Coordinates	
Northing	164315.1422
Easting	497595.8564
Date	11/27/00

I hereby certify that this United States public land survey monument record is correct and complete to the best of my knowledge and belief.

Larry D. Hoium Date 4/16/10

Larry D. Hoium, Anoka County Surveyor
Minnesota License Number 18165

HISTORY OF GOVERNMENT CORNER

Page No. 2

County of Anoka

State of Minnesota

North 1/4 Corner of Sec. 1 Township 31 Range 24

CORNER HISTORY:

December 15, 1944 - H.A.Cartwright found concrete monument down 0.3'. Established ties to monument.

June 19, 1964 - Found concrete monument using ties by H.A. Cartwright dated December 15, 1944. Monument was found down 0.2' and 2.5' north of an east-west fence line. Set 1/2" iron pipe on north face of monument and updated ties.

July 11, 1966 - Found concrete monument and updated ties.

July 22, 1970 - Found concrete monument and updated ties.

October 23, 1970 - Replaced concrete monument with a cast iron monument and set sign and post 0.5' north of monument. Updated ties.

July 1, 1974 - Found cast iron monument and updated ties.

June 14, 1977 - Found cast iron monument and updated ties.

June 20, 1980 - Found cast iron monument and updated ties.

June 20, 1986 - Found cast iron monument and updated ties.

August 24, 1994 - Found cast iron monument and updated ties.

November 27, 2000 - Found cast iron monument and established NAD 1983 (1996 Adjustment) Anoka County Project Coordinates by Static GPS methods. Updated ties.

March 11, 2010 - Found cast iron monument down 0.2' with sign and post on the north side and updated ties.