

CERTIFICATE OF LOCATION OF GOVERNMENT CORNER

County of Anoka

State of Minnesota

Northeast Corner of Sec. 4 Township 31 Range 24

On the 1st day of August, 1960, the described corner was evidenced by an iron pipe

and to perpetuate the location of said corner, at the exact location thereof, a permanent marker was placed consisting of a cast iron monument

AND on the day of July, 2012, said permanent marker was reset flush with the surface after road construction and the ties were updated

Updated reference ties are as shown below.

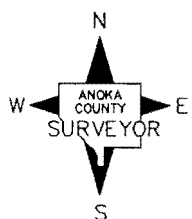
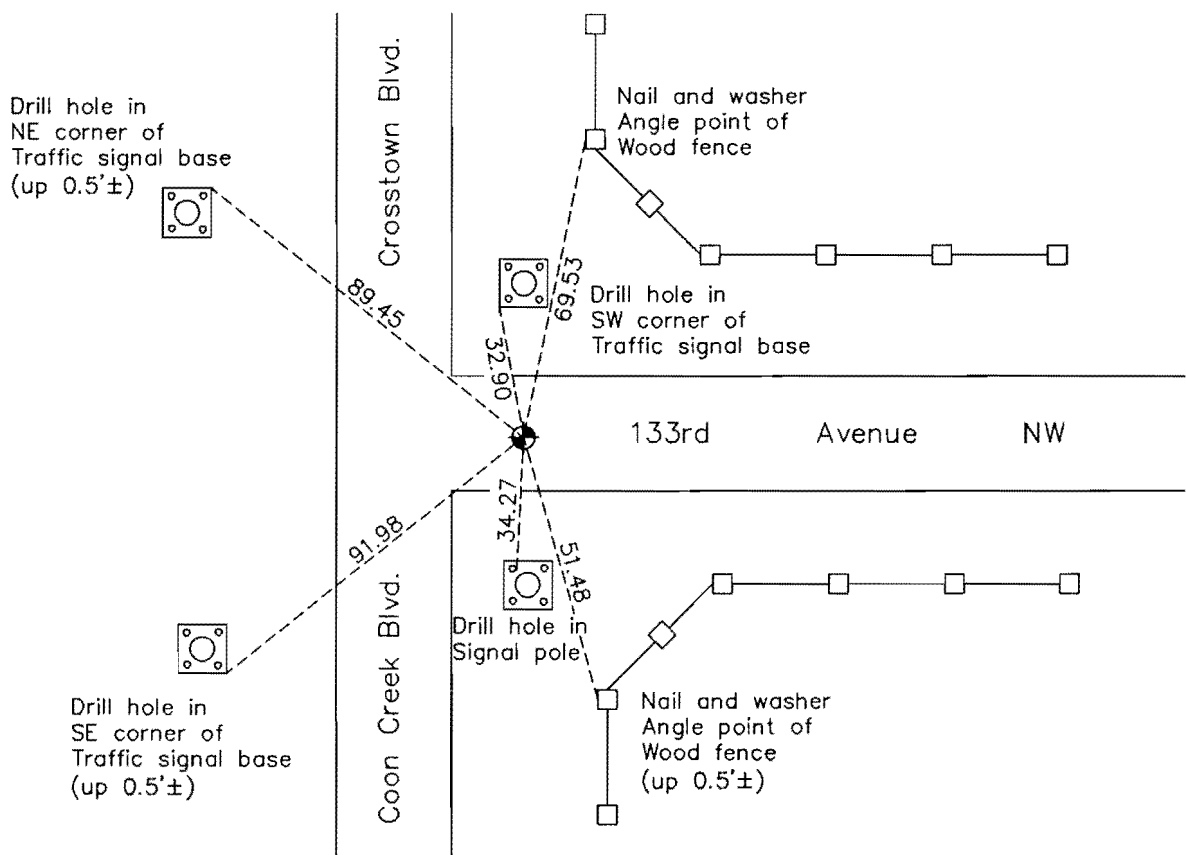

Revision Date
12/18/12

N.A.D. 1983 Coordinates
(1996 Adjustment)

County Project Coordinates	
Northing	164591.4236
Easting	484457.5856
Date	7/19/00

I hereby certify that this United States public land survey monument record is correct and complete to the best of my knowledge and belief.

Larry D. Hoium Date 12/18/12

Larry D. Hoium, Anoka County Surveyor

Minnesota License Number 18165

HISTORY OF GOVERNMENT CORNER

Page No. 6A

County of Anoka

State of Minnesota

Northeast Corner of Sec. 4 Township 31 Range 24

CORNER HISTORY:

June 1957 - Cartwright and Olson found iron pipe up 0.3' under fence line. All trees were found with old blazes. Established ties to monument.

August 1, 1960 - Found iron pipe up 0.6' with steel fence post and updated ties.

November 12, 1987 - Set cast iron monument flush with surface after road construction using area plats and resurvey. Set P.K.Nails 2.00' North and East of monument. Updated ties.

July 21, 1993 - Found cast iron monument and updated ties

July 19, 2000 - Found cast iron monument and established NAD 1983 (1996 Adjustment) Anoka County Project Coordinates by Static GPS methods. Updated ties.

February 8, 2010 - Found cast iron monument and updated ties

May 17, 2012 - Set construction ties, updated ties, verified location using VRS and removed cast iron monument prior to road construction.

July 2012 - Set cast iron monument flush with surface after road construction using construction ties. Verified location of corner by Static GPS methods.