

CERTIFICATE OF LOCATION OF GOVERNMENT CORNER

County of Anoka

State of Minnesota

Witness Corner of Sec. 1 Township 31 Range 24

(On east line of NE1/4)

On the 3rd day of February, 1976, the described corner was evidenced by area resurvey

and to perpetuate the location of said corner, at the exact location thereof, a permanent marker was placed consisting of a cast iron monument with a sign and post on the north side

AND on the day of March, 2010, said permanent marker was found up 0.4' and the ties were updated

Updated reference ties are as shown below.

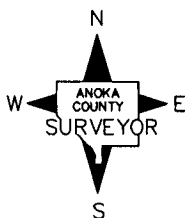
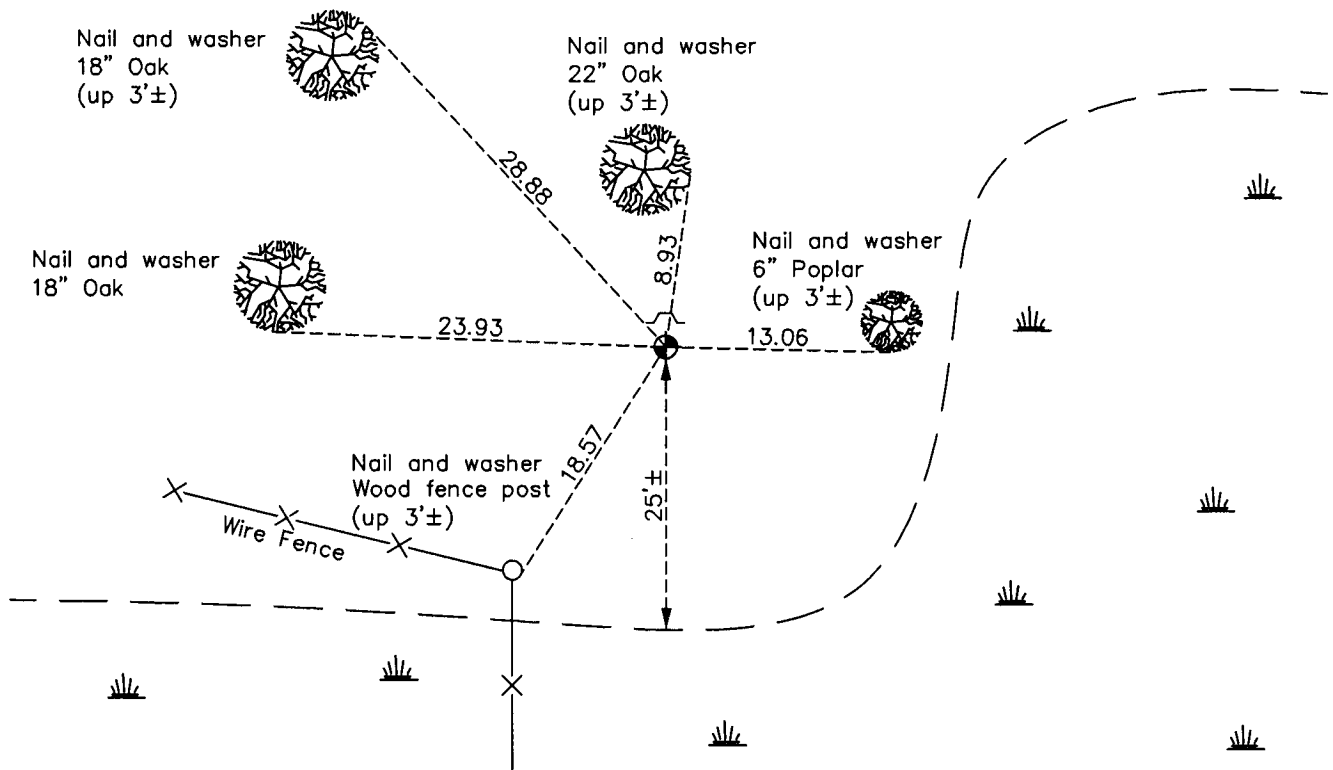

N.A.D. 1983 Coordinates
(1996 Adjustment)

County Project Coordinates	
Northing	163385.4892
Easting	500210.0603
Date	2/04/00

Revision Date
4/23/10

I hereby certify that this United States public land survey monument record is correct and complete to the best of my knowledge and belief.

Larry D. Hoium Date 4/23/10

Larry D. Hoium, Anoka County Surveyor

Minnesota License Number 18165

HISTORY OF GOVERNMENT CORNER

Page No. 25

County of Anoka

State of Minnesota

Witness Corner of Sec. 1 Township 31 Range 24
(On east line of NE1/4)

CORNER HISTORY:

February 3, 1976 - Set cast iron monument using area resurvey, set a sign and post on the north side and established ties to monument.

July 15, 1983 - Found cast iron monument and updated ties.

June 20, 1986 - Found cast iron monument and updated ties.

February 4, 2000 - Found cast iron monument with a sign and post on the north side and established NAD 1983 (1996 Adjustment) Anoka County Project Coordinates by Static GPS methods. Updated ties.

March 2010 - Found cast iron monument up 0.4' with a sign and post on the north side and updated ties.