

CERTIFICATE OF LOCATION OF GOVERNMENT CORNER

County of Anoka State of Minnesota

Southeast Corner of Sec. 1 Township 31 Range 24

On the 29th day of August, 1960, the described corner was evidenced by a concrete monument

and to perpetuate the location of said corner, at the exact location thereof, a permanent marker was placed consisting of a cast iron monument

AND on the 23rd day of March, 2010, said permanent marker was found and the ties were updated

Updated reference ties are as shown below.

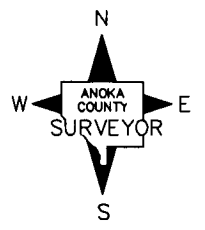
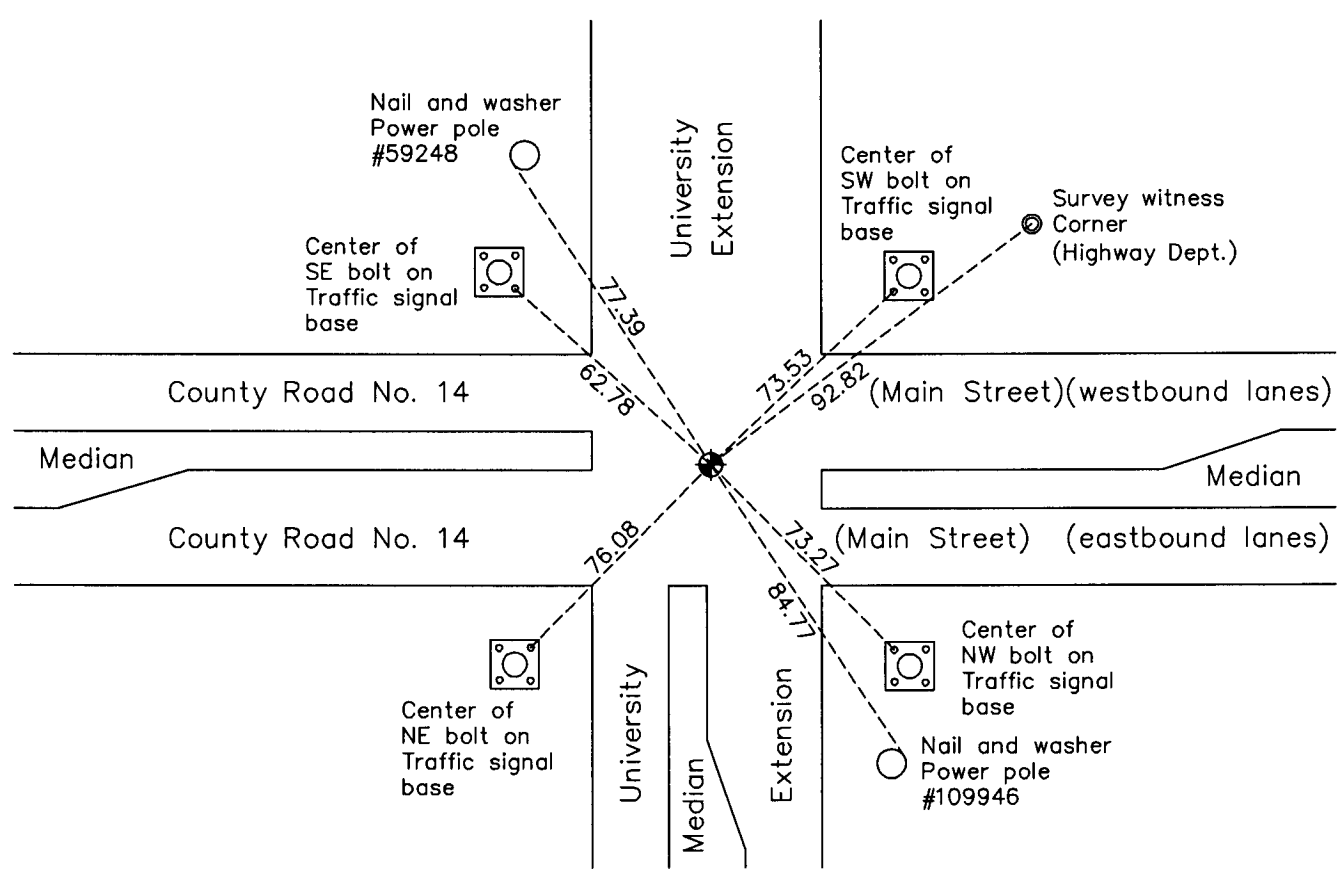

N.A.D. 1983 Coordinates
(1996 Adjustment)

County Project Coordinates	
Northing	<u>158990.7382</u>
Easting	<u>500204.1178</u>
Date	<u>10/12/98</u>

Revision Date
4/23/10

I hereby certify that this United States public land survey monument record is correct and complete to the best of my knowledge and belief.

Larry D. Hoium Date 4/23/10

Larry D. Hoium, Anoka County Surveyor

Minnesota License Number 18165

HISTORY OF GOVERNMENT CORNER

Page No. 27

County of Anoka

State of Minnesota

Southeast Corner of Sec. 1 Township 31 Range 24

CORNER HISTORY:

June 28, 1943 - H.A. Cartwright found concrete monument down 4". Established ties to monument.

July 1955 - Minder Engineering Co. found concrete monument and updated ties.

July 1957 - Minder Engineering Co. found concrete monument and updated ties.

August 29, 1960 - Found concrete monument down 2'. Set cast iron monument flush with surface and updated ties.

June 26, 1964 - Found cast iron monument and updated ties.

July 11, 1966 - Found cast iron monument and updated ties.

July 21, 1970 - Found cast iron monument and updated ties.

July 5, 1974 - Found cast iron monument and updated ties.

June 17, 1977 - Found cast iron monument and updated ties.

July 27, 1977 - Set construction ties (P.K. nails 200' and 300' North) prior to road construction.

September 21, 1977 - Found cast iron monument undisturbed after construction and updated ties. Set P.K. nails 2.00' North and East.

June 23, 1980 - Found cast iron monument and updated ties.

July 22, 1983 - Found cast iron monument and updated ties.

June 18, 1985 - Found cast iron monument and updated ties.

August 17, 1990 - Found cast iron monument and updated ties.

August 3, 1994 - Found cast iron monument and updated ties.

October 12, 1998 - Found cast iron monument and established NAD 1983 (1996 Adjustment) Anoka County Project Coordinates by Static GPS methods. Updated ties.

March 23, 2010 - Found cast iron monument and updated ties.