

CERTIFICATE OF LOCATION OF GOVERNMENT CORNER

County of Anoka

State of Minnesota

South 1/4 Corner of Sec. 1 Township 31 Range 24

On the 29th day of August, 1960, the described corner was evidenced by a concrete monument

and to perpetuate the location of said corner, at the exact location thereof, a permanent marker was placed consisting of a cast iron monument

AND on the 22nd day of August, 2012, said permanent marker was replaced with a 1/2" iron pipe with Anoka County cap 0.2' from face of curb

Updated reference ties are as shown below.

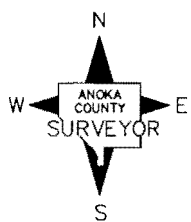
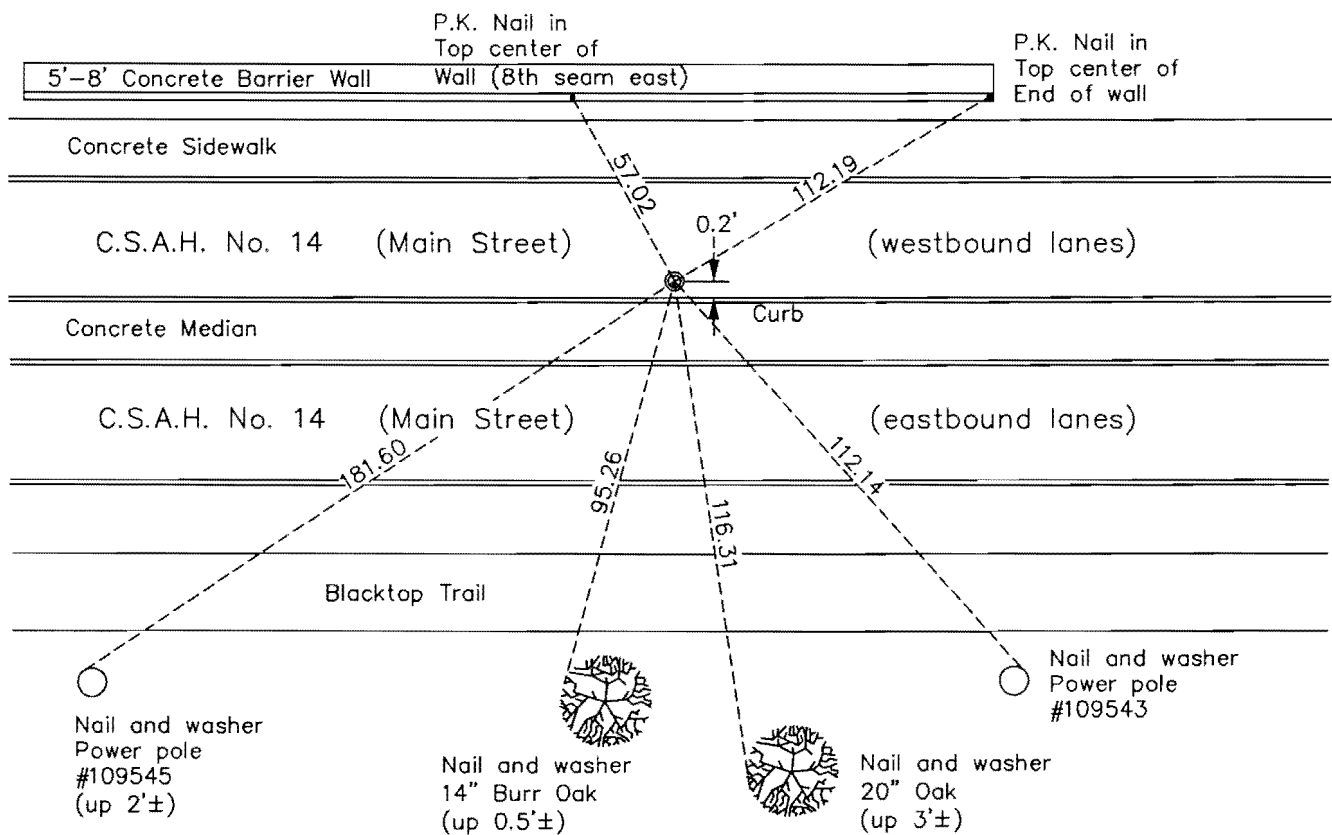

Revision Date
12/18/12

N.A.D. 1983 Coordinates
(1996 Adjustment)

County Project Coordinates	
Northing	<u>158963.8720</u>
Easting	<u>497541.6709</u>
Date	<u>8/02/01</u>

I hereby certify that this United States public land survey monument record is correct and complete to the best of my knowledge and belief.

Larry D. Hoium Date 12/18/12

Larry D. Hoium, Anoka County Surveyor

Minnesota License Number 18165

HISTORY OF GOVERNMENT CORNER

Page No. 28

County of Anoka

State of Minnesota

South 1/4 Corner of Sec. 1 Township 31 Range 24

CORNER HISTORY:

November 25, 1944 - H.A. Cartwright found concrete monument down 4". Established ties to monument.

July 1955 - Minder Engineering Co. found concrete monument and updated ties.

August 29, 1960 - Found concrete monument broken off down 2'. Set cast iron monument flush with surface and updated ties.

June 26, 1964 - Found cast iron monument and updated ties.

July 11, 1966 - Found cast iron monument and updated ties.

July 21, 1970 - Found cast iron monument and updated ties.

July 5, 1974 - Found cast iron monument and updated ties.

June 17, 1977 - Found cast iron monument and updated ties.

June 23, 1980 - Found cast iron monument and updated ties.

December 14, 1983 - Found cast iron monument and updated ties.

June 24, 1986 - Found cast iron monument and updated ties.

June 24, 1991 - Found cast iron monument and updated ties.

August 2, 2001 - Found cast iron monument and established NAD 1983 (1996 Adjustment) Anoka County Project Coordinates by Static GPS methods. Updated ties.

March 30, 2010 - Found cast iron monument and updated ties.

June 21, 2011 - Updated ties, verified location with VRS and removed cast iron monument prior to road construction.

August 22, 2012 - Set 1/2" iron pipe with Anoka County cap flush with surface and 0.2' from face of curb after road construction using ties. Verified location of corner by Static GPS methods.