

CERTIFICATE OF LOCATION OF GOVERNMENT CORNER

County of Anoka

State of Minnesota

Northeast Corner of Sec. 9 Township 31 Range 24

On the 26th day of September, 1962, the described corner was evidenced by a 3/4" iron pipe

and to perpetuate the location of said corner, at the exact location thereof, a permanent marker was placed consisting of a cast iron monument set in concrete

AND on the 29th day of August, 2011, said permanent marker was reset using construction ties. A 0.5' top section of a cast iron monument was set in concrete.

Updated reference ties are as shown below.

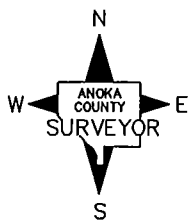
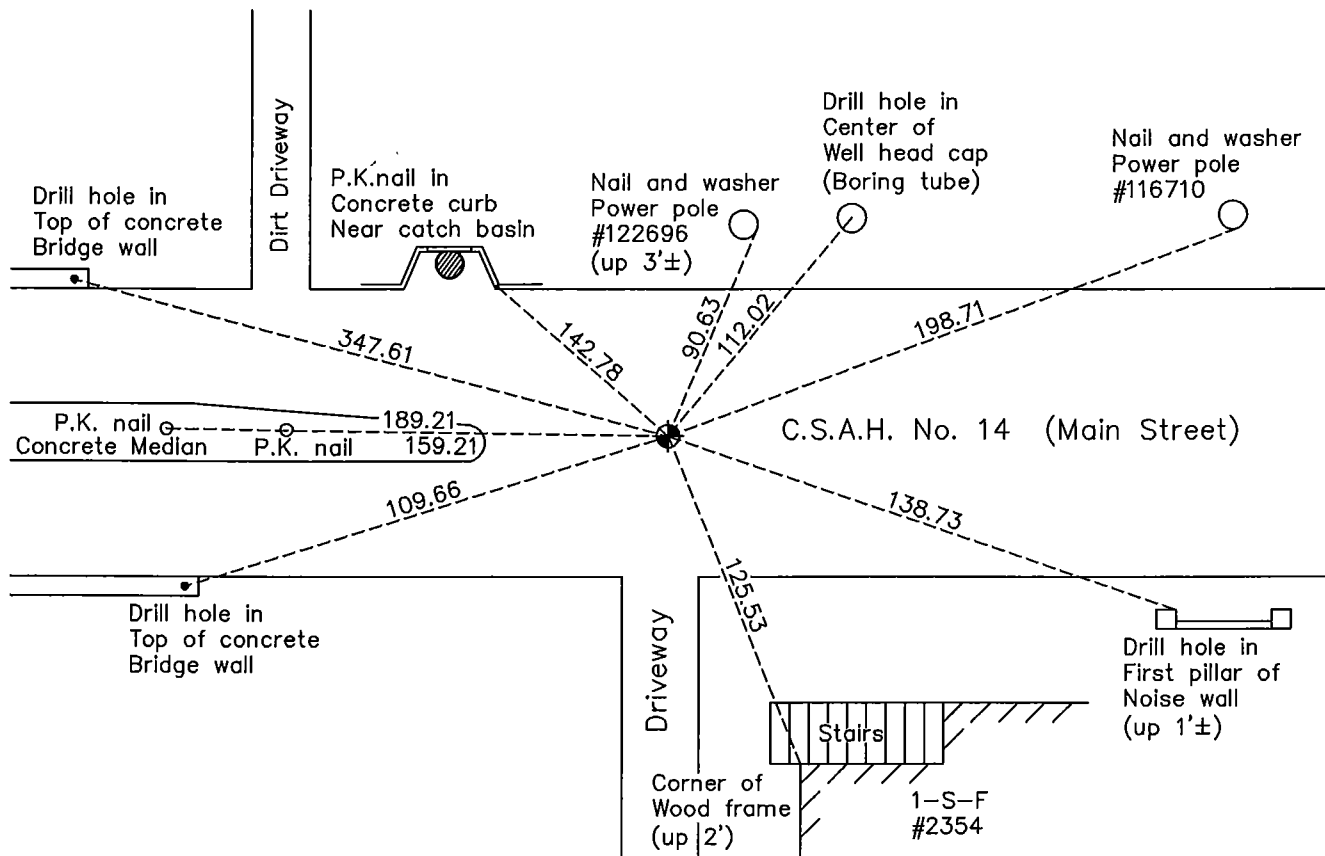

N.A.D. 1983 Coordinates
(1996 Adjustment)

County Project Coordinates	
Northing	159193.9888
Easting	484372.5737
Date	9/26/01

Revision Date
5/17/12

I hereby certify that this United States public land survey monument record is correct and complete to the best of my knowledge and belief.

Larry D. Holium Date 5/17/12

Larry D. Holium, Anoka County Surveyor

Minnesota License Number 18165

HISTORY OF GOVERNMENT CORNER

Page No. 33

County of Anoka

State of Minnesota

Northeast Corner of Sec. 9 Township 31 Range 24

CORNER HISTORY:

April 10, 1943 - H.A. Cartwright found 6" X 6" granite monument down 3" in the centerline of Main Street. Established ties to monument.

June 24, 1960 - Found pinched iron pipe down 6". Dug below iron pipe and found nothing. Replaced iron pipe in its original position.

September 26, 1962 - Swung ties from Cartwright, Hoium and Minder. Found P.K. nail straddles, then dug down and found 3/4" bent iron pipe down 0.2' which fit straddles when straightened. Also found 3/4" pinched iron pipe down 0.8' which fell 0.2' East of above described 3/4" iron pipe. Set cast iron monument at intersection of straddles and updated ties.

July 21, 1966 - Found cast iron monument and updated ties.

July 21, 1970 - Found cast iron monument and updated ties.

July 5, 1974 - Found cast iron monument and updated ties.

June 17, 1977 - Found cast iron monument and updated ties.

June 25, 1980 - Found cast iron monument and updated ties.

June 24, 1991 - Found cast iron monument and updated ties.

August 9, 1994 - Found cast iron monument and updated ties.

September 26, 2001 - Found cast iron monument and established NAD 1983 (1996 Adjustment) Anoka County Project Coordinates by Static GPS methods.

November 1, 2001 - Found cast iron monument and updated ties.

April 10, 2003 - Set construction ties (transit) prior to road construction.

December 8, 2003 - Set cast iron monument in concrete after road construction using construction ties.

March 18, 2010 - Found cast iron monument flush with surface and updated ties.

July 20, 2010 - Set construction ties (transit) prior to road construction.

August 29, 2011 - Set 0.5' top section of a cast iron monument in concrete after road construction using construction ties.