

CERTIFICATE OF LOCATION OF GOVERNMENT CORNER

County of Anoka

State of Minnesota

South 1/4 Corner of Sec. 6 Township 31 Range 24

On the 10th day of May, 1963, the described corner was evidenced by area resurvey

and to perpetuate the location of said corner, at the exact location thereof, a permanent marker was placed consisting of a cast iron monument

AND on the 30th day of March, 2010, said permanent marker was found and the ties were updated

Updated reference ties are as shown below.

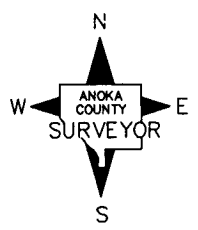
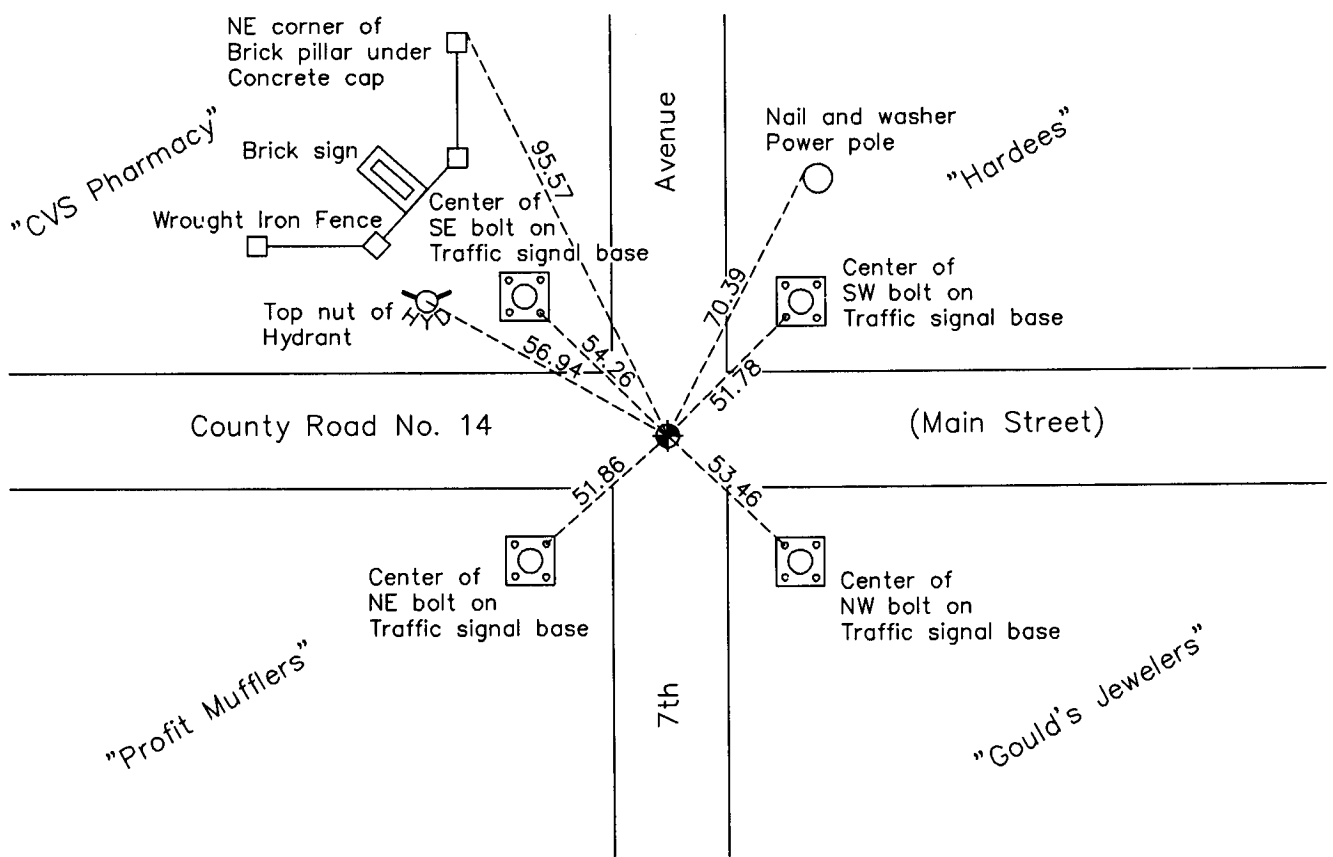

Revision Date
4/29/10

N.A.D. 1983 Coordinates
(1996 Adjustment)

County Project Coordinates	
Northing	159249.6020
Easting	471162.3803
Date	11/02/01

I hereby certify that this United States public land survey monument record is correct and complete to the best of my knowledge and belief.

Larry D. Hoium Date 4/29/10
 Larry D. Hoium, Anoka County Surveyor
 Minnesota License Number 18165

HISTORY OF GOVERNMENT CORNER

County of Anoka

State of Minnesota

South 1/4 Corner of Sec. 6 Township 31 Range 24

CORNER HISTORY:

May 10, 1963 - Set P.K. nail using area resurvey. Established ties to monument.

July 27, 1966 - Found P.K. nail and updated ties.

July 19, 1974 - Found P.K. nail and updated ties.

June 20, 1977 - Found P.K. nail and updated ties. Set P.K. nails 2.00' south and east.

August 2, 1984 - Replaced P.K. nail with a cast iron monument and updated ties.

July 6, 1987 - Set construction ties and removed monument (type unknown) prior to road construction.

October 13, 1987 - Set cast iron monument flush with surface after road construction using construction ties. Updated ties and set P.K. nails 2.00' North and East.

June 25, 1991 - Found cast iron monument and updated ties.

August 19, 1994 - Found cast iron monument and updated ties.

November 2, 2001 - Found cast iron monument and established NAD 1983 (1996 Adjustment) Anoka County Project Coordinates by Static GPS methods.

March 30, 2010 - Found cast iron monument and updated ties.