

CERTIFICATE OF LOCATION OF GOVERNMENT CORNER

County of Anoka

State of Minnesota

Southwest Corner of Sec. 12 Township 31 Range 24

On the 23rd day of February, 1960, the described corner was evidenced by a concrete monument

and to perpetuate the location of said corner, at the exact location thereof, a permanent marker was placed consisting of a cast iron monument with a sign and post on the north side

AND on the 17th day of February, 2010, said permanent marker was found down 0.6' and the ties were updated

Updated reference ties are as shown below.

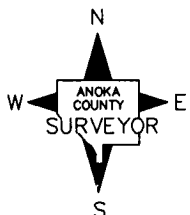
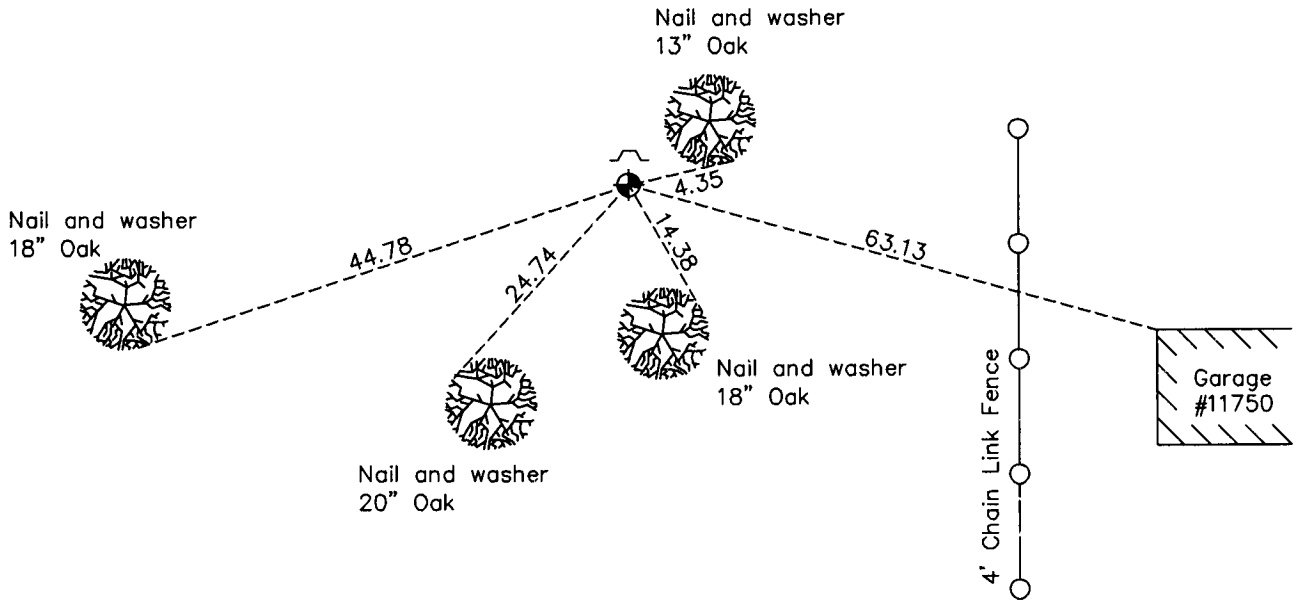

Revision Date
5/03/10

N.A.D. 1983 Coordinates
(1996 Adjustment)

County Project Coordinates	
Northing	<u>153610.0810</u>
Easting	<u>494802.3485</u>
Date	<u>10/23/01</u>

I hereby certify that this United States public land survey monument record is correct and complete to the best of my knowledge and belief.

Larry D. Hoium Date 5/03/10

Larry D. Hoium, Anoka County Surveyor

Minnesota License Number 18165

HISTORY OF GOVERNMENT CORNER

Page No. 48

County of Anoka

State of Minnesota

Southwest Corner of Sec. 12 Township 31 Range 24

CORNER HISTORY:

April 1, 1944 - H.A. Cartwright found concrete monument. Established ties to monument.

July 1955 - Minder Engineering Company found concrete monument and updated ties.

February 23, 1960 - Found concrete monument set flush with the surface and updated ties.

June 5, 1964 - Found concrete monument and updated ties.

July 11, 1966 - Found concrete monument and updated ties.

July 27, 1970 - Found concrete monument and updated ties.

July 11, 1974 - Replaced concrete monument with a cast iron monument set flush with the surface. Set warning sign and post 1'± west of monument and updated ties.

June 20, 1977 - Found cast iron monument and updated ties.

July 25, 1983 - Found cast iron monument and updated ties.

June 19, 1986 - Found cast iron monument and updated ties.

August 13, 1990 - Found cast iron monument and set sign and post on the north side. Updated ties.

August 11, 1994 - Found cast iron monument with sign and post on the north side and updated ties.

October 22, 2001 - Found cast iron monument and established NAD 1983 (1996 Adjustment) Anoka County Project Coordinates by Static GPS methods. Updated ties.

February 17, 2010 - Found cast iron monument down 0.6'± with sign and post on the north side and updated ties.