

CERTIFICATE OF LOCATION OF GOVERNMENT CORNER

County of Anoka

State of Minnesota

North 1/4 Corner of Sec. 15 Township 31 Range 24

On the 19th day of July, 1960, the described corner was evidenced by a concrete monument

and to perpetuate the location of said corner, at the exact location thereof, a permanent marker was placed consisting of a cast iron monument

AND on the 26th day of March, 2010, said permanent marker was found down 0.3' and the ties were updated

Updated reference ties are as shown below.

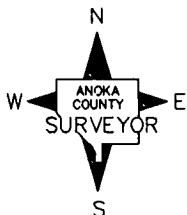
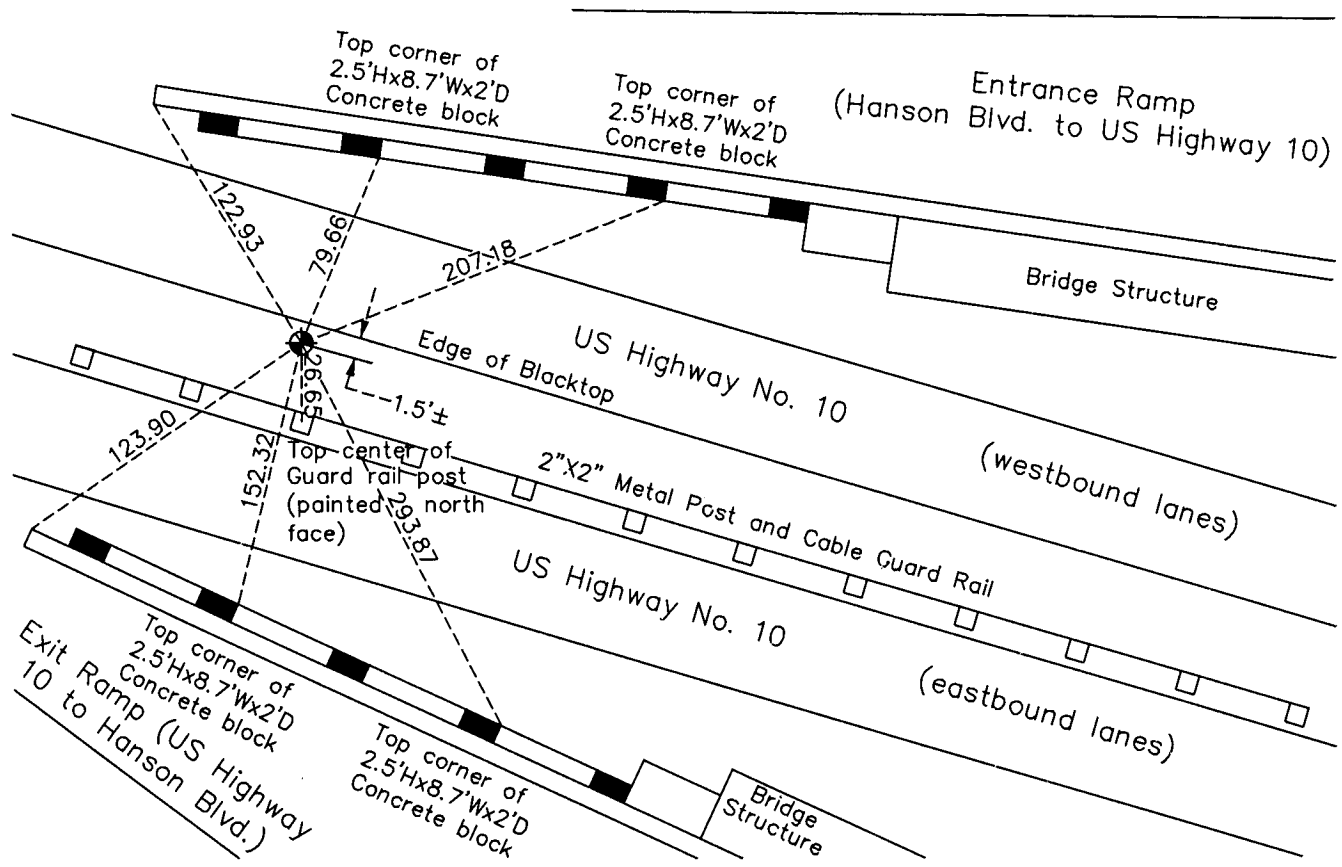

N.A.D. 1983 Coordinates
(1996 Adjustment)

| County Project Coordinates | |
|----------------------------|-------------|
| Northing | 153811.7472 |
| Easting | 486918.4631 |
| Date | 9/20/01 |

Revision Date
5/10/10

I hereby certify that this United States public land survey monument record is correct and complete to the best of my knowledge and belief.

Larry D. Hoium Date 5/10/10

Larry D. Hoium, Anoka County Surveyor

Minnesota License Number 18165

HISTORY OF GOVERNMENT CORNER

Page No. 51

County of Anoka

State of Minnesota

North 1/4 Corner of Sec. 15 Township 31 Range 24

CORNER HISTORY:

November 10, 1944 - H.A. Cartwright found concrete monument set flush with the surface. Established ties to monument.

July 19, 1960 - Found concrete monument up 0.7'± with an iron pipe on the north side and updated ties.

April 27, 1965 - Set construction ties prior to road construction.

September 8, 1966 - Set bridge spike after road construction using construction ties.

October 19, 1966 - Replaced bridge spike with a cast iron monument and updated ties.

July 24, 1970 - Found cast iron monument and updated ties.

July 8, 1974 - Found cast iron monument and updated ties.

June 21, 1977 - Found cast iron monument and updated ties.

July 20, 1983 - Found cast iron monument and updated ties.

June 13, 1986 - Found cast iron monument and updated ties.

September 19, 2001 - Found cast iron monument and established NAD 1983 (1996 Adjustment) Anoka County Project Coordinates by Static GPS methods. Updated ties.

March 26, 2010 - Found cast iron monument down 0.3'± and updated ties.