

# CERTIFICATE OF LOCATION OF GOVERNMENT CORNER

County of Anoka

State of Minnesota

## West 1/4 Corner of Sec. 16 Township 31 Range 24

On the 1st day of August, 1960, the described corner was evidenced by a 1" brass plug

and to perpetuate the location of said corner, at the exact location thereof, a permanent marker was placed consisting of a cast iron monument

AND on the 15th day of March, 2010, said permanent marker was found and the ties were updated

Updated reference ties are as shown below.

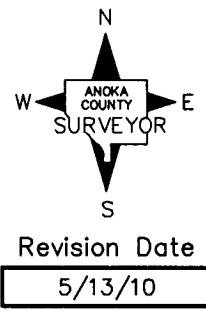
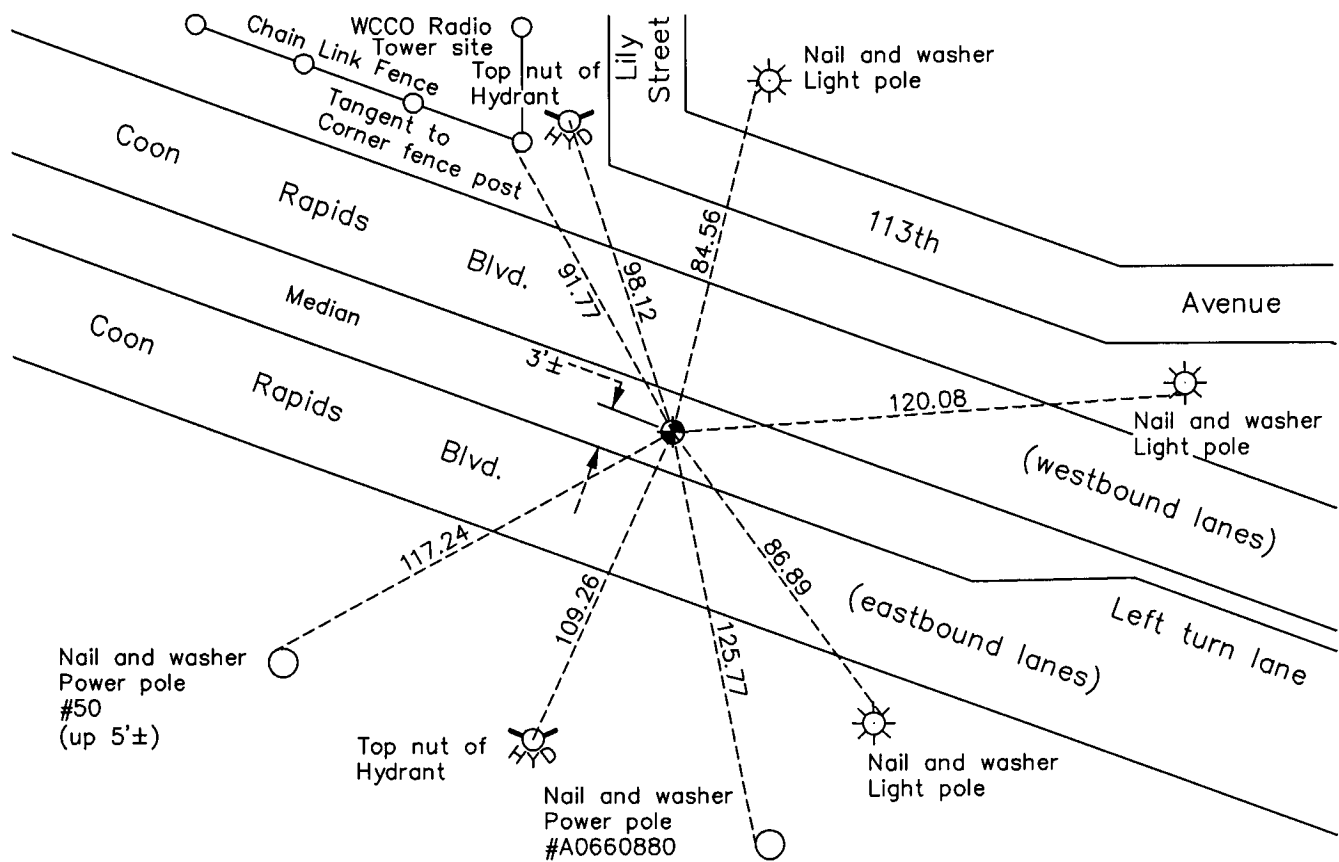

N.A.D. 1983 Coordinates  
(1996 Adjustment)

County Project Coordinates	
Northing	151252.4590
Easting	478959.2288
Date	8/30/01

I hereby certify that this United States public land survey monument record is correct and complete to the best of my knowledge and belief.

*Larry D. Hoium* Date 5/13/10

Larry D. Hoium, Anoka County Surveyor

Minnesota License Number 18165

# HISTORY OF GOVERNMENT CORNER

Page No. 58

County of Anoka

State of Minnesota

## West 1/4 Corner of Sec. 16 Township 31 Range 24

### **CORNER HISTORY:**

May 2, 1944 - H.A. Cartwright found 3/4" brass plug set down 0.1' in highway. Established ties to monument.

October 7, 1958 - Don Coulter found 3/4" brass plug down 0.1'. Updated ties.

August 1, 1960 - Found 1" round brass plug flush with the surface and updated ties.

July 14, 1966 - Found 1" round brass plug flush with the surface and updated ties.

July 28, 1970 - Replaced 1" round brass plug with a broken off cast iron monument set flush with the surface. Set P.K. Nails 2.00' north and east and updated ties.

July 1, 1974 - Found cast iron monument and updated ties.

June 21, 1977 - Found cast iron monument and updated ties.

July 3, 1980 - Found cast iron monument down 0.5' and retied after construction. Position verified by plats of Larson 2nd Addition, Sundquist Addition and Cardinal Heights Plat 4.

July 20, 1983 - Found cast iron monument and updated ties.

June 17, 1986 - Found cast iron monument and updated ties.

August 30, 1990 - Found cast iron monument and updated ties.

August 19, 1994 - Replaced cast iron monument with a new cast iron monument. Updated ties.

August 30, 2001 - Found cast iron monument and established NAD 1983 (1996 Adjustment) Anoka County Project Coordinates by Static GPS methods. Updated ties.

March 15, 2010 - Found cast iron monument and updated ties.