

CERTIFICATE OF LOCATION OF GOVERNMENT CORNER

County of Anoka

State of Minnesota

West 1/4 Corner of Sec. 13 Township 31 Range 24

On the 18th day of October, 1963, the described corner was evidenced by a 1 1/2" iron pipe

and to perpetuate the location of said corner, at the exact location thereof, a permanent marker was placed consisting of a cast iron monument

AND on the 9th day of February, 2010, said permanent marker was found broken off down 0.6' and the ties were updated

Updated reference ties are as shown below.

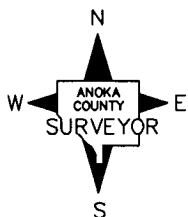
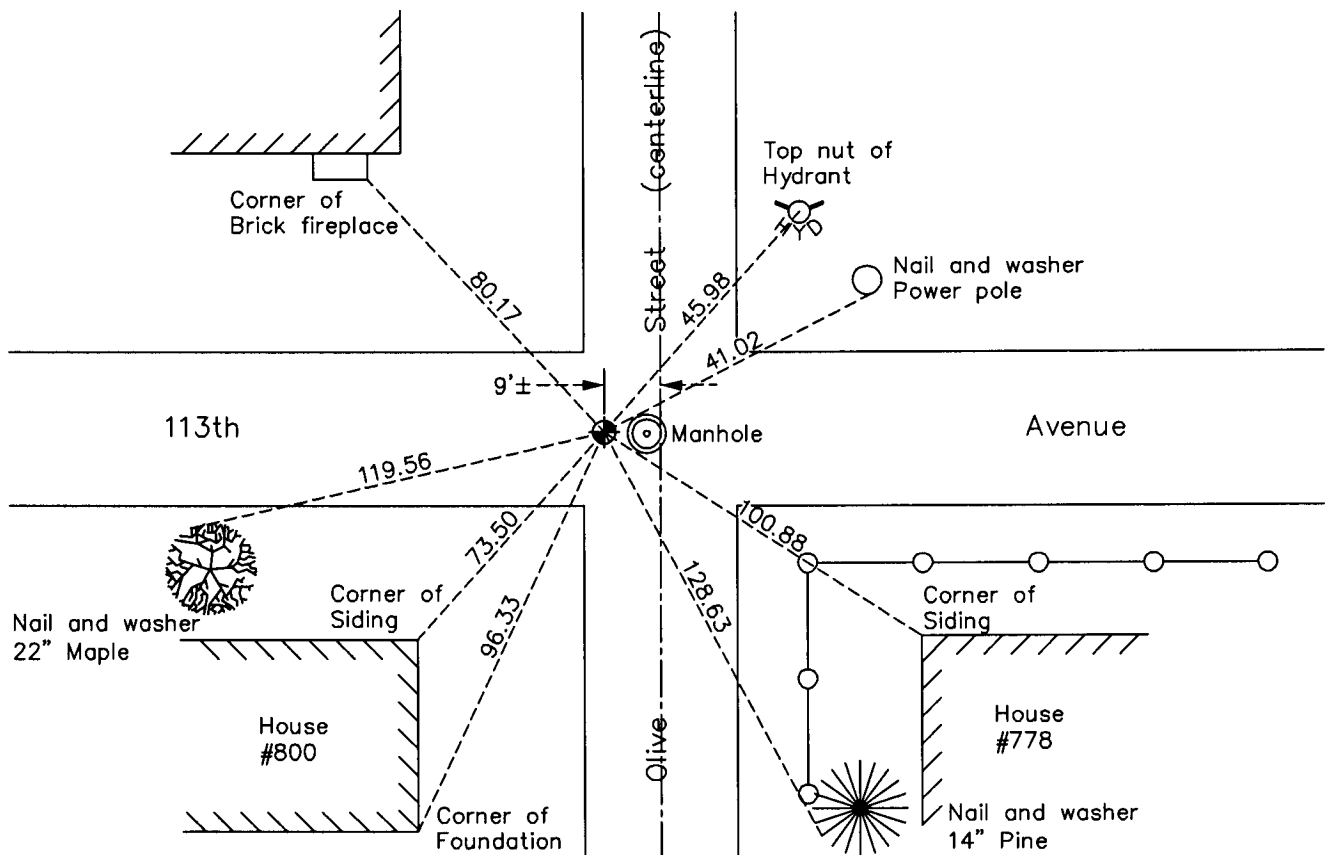

Revision Date
5/14/10

N.A.D. 1983 Coordinates
(1996 Adjustment)

County Project Coordinates	
Northing	<u>150956.3550</u>
Easting	<u>494777.2691</u>
Date	<u>8/29/01</u>

I hereby certify that this United States public land survey monument record is correct and complete to the best of my knowledge and belief.

Larry D. Hoium Date 5/14/10

Larry D. Hoium, Anoka County Surveyor
Minnesota License Number 18165

HISTORY OF GOVERNMENT CORNER

Page No. 61

County of Anoka

State of Minnesota

West 1/4 Corner of Sec. 13 Township 31 Range 24

CORNER HISTORY:

April 19, 1946 - H.A. Cartwright found concrete monument set up 1'. Established ties to monument.

May 28, 1962 - All ties are gone.

October 18, 1963 - Found 1-1/2" iron pipe set flush with the surface and updated ties. Checked location of iron using area plats.

August 21, 1967 - Replaced 1-1/2" iron pipe with a cast iron monument set flush with the surface. Updated ties.

July 30, 1970 - Found cast iron monument 8'± west of centerline and set P.K. nails 2.00' south and west. Updated ties.

July 12, 1974 - Found cast iron monument and updated ties.

June 22, 1977 - Found cast iron monument and updated ties.

July 7, 1980 - Found cast iron monument and updated ties.

July 18, 1983 - Found cast iron monument and updated ties.

February 6, 1984 - Found cast iron monument and updated ties.

June 19, 1986 - Found cast iron monument and updated ties.

August 13, 1990 - Found cast iron monument and updated ties.

August 11, 1994 - Found cast iron monument and updated ties.

August 29, 2001 - Found cast iron monument and established NAD 1983 (1996 Adjustment) Anoka County Project Coordinates by Static GPS methods. Updated ties.

February 9, 2010 - Found cast iron monument broken off down 0.6' and updated ties.