

# CERTIFICATE OF LOCATION OF GOVERNMENT CORNER

County of Anoka

State of Minnesota

## North 1/4 Corner of Sec. 26 Township 31 Range 24

On the 23rd day of February, 1960, the described corner was evidenced by a concrete monument

and to perpetuate the location of said corner, at the exact location thereof, a permanent marker was placed consisting of a cast iron monument

AND on the 15th day of March, 2010, said permanent marker was found down 1.5' and the ties were updated

Updated reference ties are as shown below.

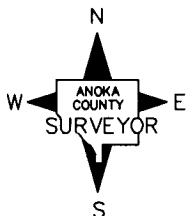
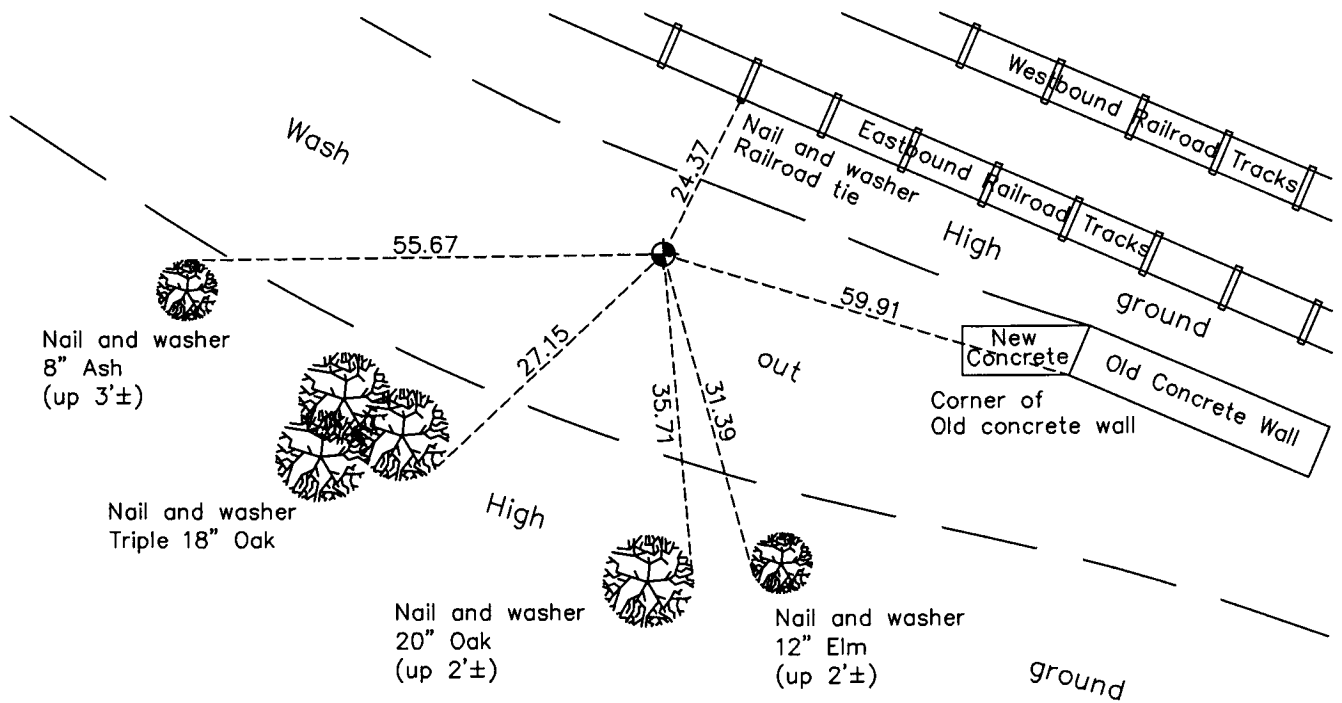

Revision Date  
5/21/10

N.A.D. 1983 Coordinates  
(1996 Adjustment)

County Project Coordinates	
Northing	143077.5035
Easting	492056.1932
Date	10/23/01

I hereby certify that this United States public land survey monument record is correct and complete to the best of my knowledge and belief.

*Larry D. Hoium* Date 5/21/10

Larry D. Hoium, Anoka County Surveyor  
Minnesota License Number 18165

# HISTORY OF GOVERNMENT CORNER

Page No. 81

County of Anoka

State of Minnesota

## North 1/4 Corner of Sec. 26 Township 31 Range 24

### **CORNER HISTORY:**

November 11, 1944 - H.A. Cartwright found concrete monument set flush with the surface. Established ties to monument.

July 1957 - Minder Engineering Company found concrete monument and updated ties.

February 23, 1960 - Found concrete monument and updated ties.

June 3, 1964 - Found concrete monument down 2" and updated ties.

July 15, 1966 - Found concrete monument and updated ties.

August 3, 1970 - Found concrete monument and updated ties.

July 12, 1974 - Replaced concrete monument with a cast iron monument set down 0.5'±. Updated ties.

June 23, 1977 - Found cast iron monument and updated ties.

July 1, 1980 - Found cast iron monument and updated ties.

August 24, 1994 - Found cast iron monument and updated ties.

September 24, 2001 - Found cast iron monument and updated ties.

October 23, 2001 - Found cast iron monument and established NAD 1983 (1996 Adjustment) Anoka County Project Coordinates by Static GPS methods.

March 15, 2010 - Found cast iron monument down 1.5'± and updated ties.