

CERTIFICATE OF LOCATION OF GOVERNMENT CORNER

County of Anoka

State of Minnesota

Southwest Corner of Sec. 22 Township 31 Range 24

On the 26th day of July, 1960, the described corner was evidenced by a concrete monument

and to perpetuate the location of said corner, at the exact location thereof, a permanent marker was placed consisting of the same concrete monument

AND on the 9th day of March, 2010, said permanent marker was found down 0.3' and the ties were updated

Updated reference ties are as shown below.

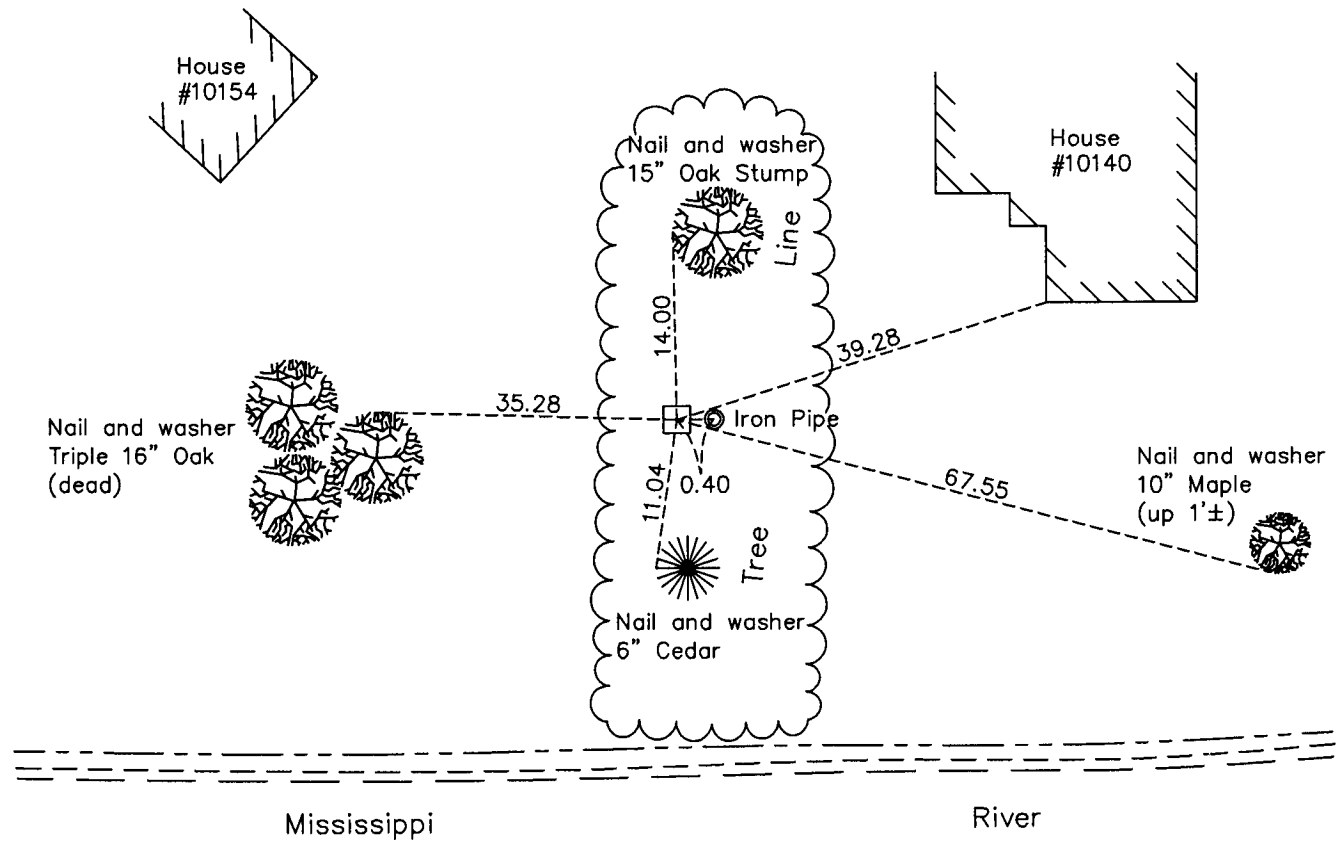

N

 S

Revision Date
5/24/10

N.A.D. 1983 Coordinates
(1996 Adjustment)

County Project Coordinates	
Northing	143288.6265
Easting	484052.9361
Date	11/01/01

I hereby certify that this United States public land survey monument record is correct and complete to the best of my knowledge and belief.

Larry D. Hoium Date 5/24/10

Larry D. Hoium, Anoka County Surveyor
 Minnesota License Number 18165

HISTORY OF GOVERNMENT CORNER

Page No. 84

County of Anoka

State of Minnesota

Southwest Corner of Sec. 22 Township 31 Range 24

CORNER HISTORY:

November 18, 1944 - H.A. Cartwright found concrete monument set flush with the surface. Established ties to monument.

March 17, 1954 - N.C. Hoium found concrete monument with a 2 1/2" iron pipe 0.4' east of monument and updated ties.

July 26, 1960 - Found concrete monument with a 2 1/2" iron pipe 0.4' east of monument and up 4'. Updated ties.

June 4, 1964 - Found concrete monument with a 2 1/2" iron pipe 0.4' east of monument and updated ties.

July 14, 1966 - Found concrete monument with a 2 1/2" iron pipe 0.4' east of monument and updated ties.

August 3, 1970 - Found concrete monument with a 2 1/2" iron pipe 0.4' east of monument and up 5'±. Updated ties.

June 23, 1977 - Found concrete monument with a 2 1/2" iron pipe 0.4' east of monument and up 5'±. Updated ties.

August 30, 1990 - Found concrete monument and updated ties.

November 1, 2001 - Found concrete monument with a 2 1/2" iron pipe 0.4' east of monument and established NAD 1983 (1996 Adjustment) Anoka County Project Coordinates by Static GPS methods. Updated ties.

March 9, 2010 - Found concrete monument and updated ties.