

# CERTIFICATE OF LOCATION OF GOVERNMENT CORNER

County of Anoka

State of Minnesota

## Southeast Corner of Sec. 36 Township 31 Range 24

On the 20th day of March, 1943, the described corner was evidenced by a 4"X8"  
limestone monument

and to perpetuate the location of said corner, at the exact location thereof, a permanent marker  
was placed consisting of a cast iron monument

AND on the 21st day of October, 2010, said permanent marker was replaced with a new  
cast iron monument after construction and the ties were updated

Updated reference ties are as shown below.

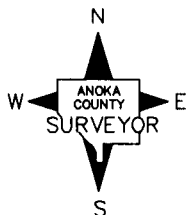
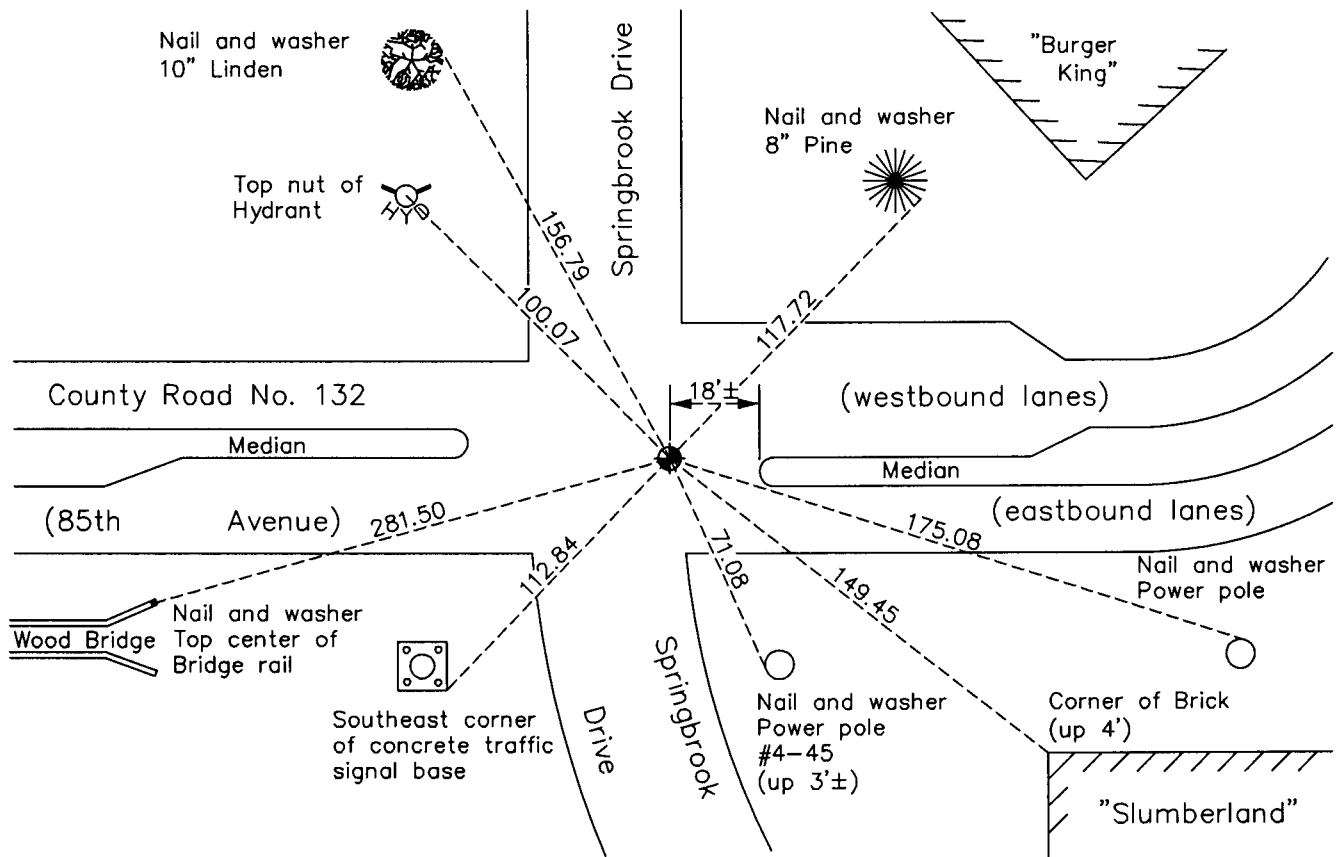

Revision Date

12/15/10

N.A.D. 1983 Coordinates  
(1996 Adjustment)

County Project Coordinates	
Northing	132549.8472
Easting	499932.5860
Date	7/29/99

I hereby certify that this United States public land survey monument record is correct and complete to the best of my knowledge and belief.

*Larry D. Hoium* Date 12/15/10

Larry D. Hoium, Anoka County Surveyor

Minnesota License Number 18165

# HISTORY OF GOVERNMENT CORNER

Page No. 96

County of Anoka

State of Minnesota

## Southeast Corner of Sec. 36 Township 31 Range 24

### **CORNER HISTORY:**

March 20, 1943 - H.A. Cartwright found 4"x8" limestone monument up 16". Established ties to monument.

July 1, 1960 - Found 4"x8" limestone monument up 16" and updated ties.

October 31, 1962 - Replaced broken limestone monument with a 1"x7' iron pipe set up 3' and updated ties. Top 4' of iron pipe is painted with 6" red and white bands.

November 17, 1965 - Replaced 1"x7' iron pipe ( bent and moved by road construction) with a cast iron monument set flush with the surface. Updated ties.

July 11, 1966 - Found cast iron monument and updated ties.

August 19, 1969 - Replaced solid cast iron monument with an extendible cast iron monument set flush with the surface. Set P.K. nails 2.00' north and east of monument. Updated ties.

May 10, 1973 - Checked all ties including construction ties and removed cast iron monument prior to construction.

July 19, 1974 - Found cast iron monument ( date reset unknown) and updated ties.

October 12, 1981 - Set construction tie prior to road construction.

May 23, 1982 - Set cast iron monument flush with surface after road construction using construction ties. Set P.K. nails 2.00' north and east of monument. Updated ties.

June 13, 1986 - Found cast iron monument and updated ties.

August 27, 1990 - Found cast iron monument and updated ties.

December 9, 1993 - Replaced cast iron monument with a new cast iron monument. Updated ties.

August 15, 1994 - Found cast iron monument and updated ties.

July 29, 1999 - Found cast iron monument and established NAD 1983 ( 1996 Adjustment) Anoka County Project Coordinates by Static GPS methods. Updated ties.

October 21, 2010 - Replaced cast iron monument with a new cast iron monument after construction. Updated ties.