

CERTIFICATE OF LOCATION OF GOVERNMENT CORNER

County of Anoka

State of Minnesota

South 1/4 Corner of Sec. 3 Township 31 Range 24

On the 17th day of August, 1960, the described corner was evidenced by an iron pipe

and to perpetuate the location of said corner, at the exact location thereof, a permanent marker was placed consisting of a cast iron monument

AND on the 18th day of March, 2010, said permanent marker was found flush and the ties were updated

Updated reference ties are as shown below.

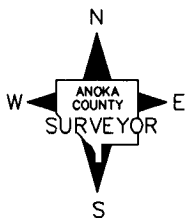
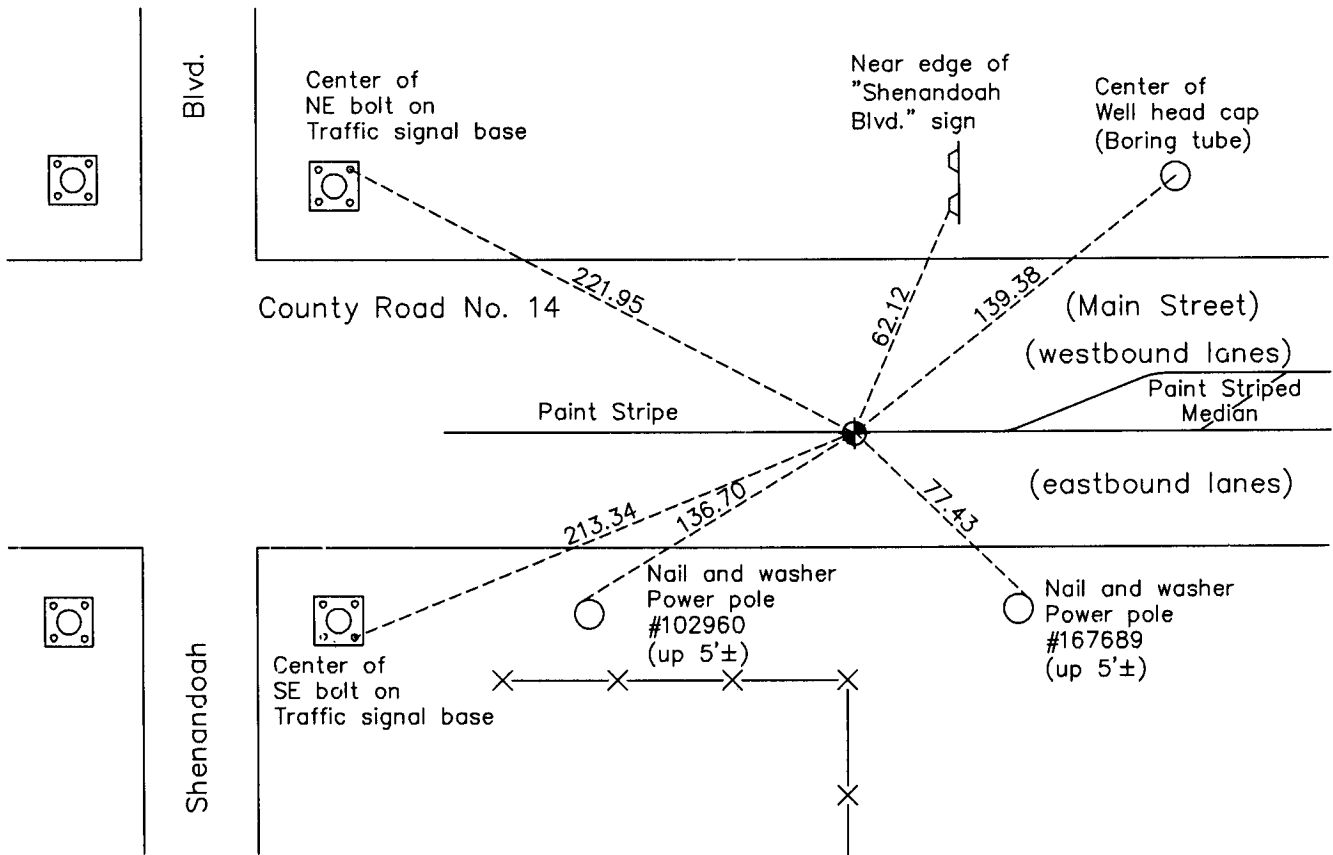

Revision Date
4/26/10

N.A.D. 1983 Coordinates
(1996 Adjustment)

County Project Coordinates	
Northing	<u>159157.6682</u>
Easting	<u>487034.1686</u>
Date	<u>9/14/01</u>

I hereby certify that this United States public land survey monument record is correct and complete to the best of my knowledge and belief.

Larry D. Hoium Date 4/26/10

Larry D. Hoium, Anoka County Surveyor

Minnesota License Number 18165

HISTORY OF GOVERNMENT CORNER

County of Anoka

State of Minnesota

South 1/4 Corner of Sec. 3 Township 31 Range 24

CORNER HISTORY:

July 10, 1946 - H.A. Cartwright found concrete monument and established ties to monument.

August 17, 1960 - Replaced iron pipe found with a cast iron monument set flush with surface. Updated ties.

June 29, 1964 - Found cast iron monument and updated ties.

July 21, 1966 - Found cast iron monument and updated ties.

July 21, 1970 - Found cast iron monument and updated ties.

July 5, 1974 - Found cast iron monument and updated ties.

June 17, 1977 - Found cast iron monument and updated ties.

June 25, 1980 - Found cast iron monument and updated ties.

December 15, 1983 - Found cast iron monument and updated ties.

June 24, 1986 - Found cast iron monument and updated ties.

June 24, 1991 - Found cast iron monument and updated ties.

September 14, 2001 - Found cast iron monument and established NAD 1983 (1996 Adjustment) Anoka County Project Coordinates by Static GPS methods. Updated ties.

March 18, 2010 - Found cast iron monument flush with surface and updated ties.