

CERTIFICATE OF LOCATION OF GOVERNMENT CORNER

County of Anoka

State of Minnesota

Southeast Corner of Sec. 24 Township 32 Range 23

On the 3rd day of May, 1965, the described corner was evidenced by a concrete monument

and to perpetuate the location of said corner, at the exact location thereof, a permanent marker was placed consisting of the same concrete monument

AND on the 1st day of March, 2012, said permanent marker was replaced with a 6' long 2" square steel Telespar monument with a 'County Surveyor' cap and punchmark

Updated reference ties are as shown below.

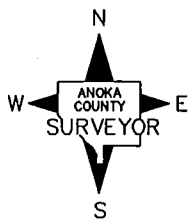
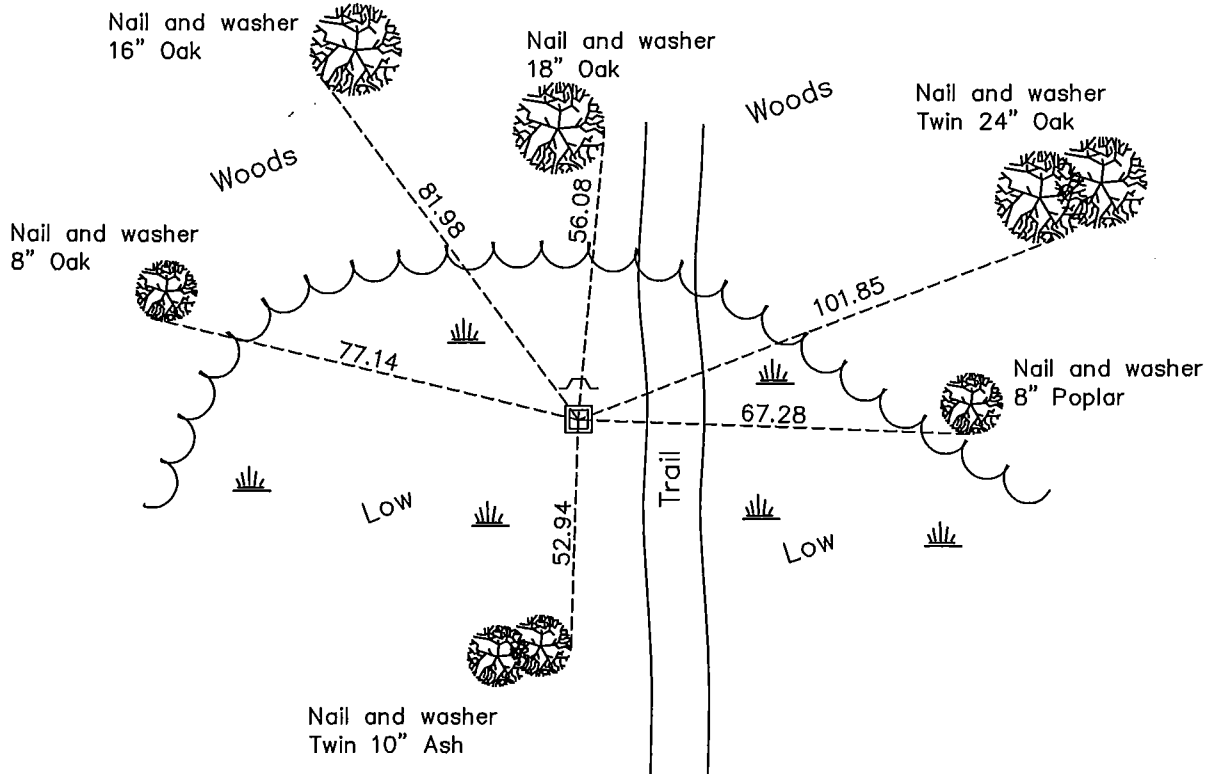

Revision Date
5/10/12

N.A.D. 1983 Coordinates
(1996 Adjustment)

County Project Coordinates	
Northing	<u>174638.4826</u>
Easting	<u>532026.3538</u>
Date	<u>3/04/02</u>

I hereby certify that this United States public land survey monument record is correct and complete to the best of my knowledge and belief.

Larry D. Holium Date 5/10/12

Larry D. Holium, Anoka County Surveyor

Minnesota License Number 18165