

# CERTIFICATE OF LOCATION OF GOVERNMENT CORNER

County of Anoka

State of Minnesota

## North $\frac{1}{4}$ Corner of Sec. 18 Township 31 Range 22

On the 28th day of February, 1963, the described corner was evidenced by an iron pipe

and to perpetuate the location of said corner, at the exact location thereof, a permanent marker was placed consisting of a cast iron monument

AND on the 27th day of August, 2012, said permanent marker was reset after road construction and the ties were updated

Updated reference ties are as shown below.

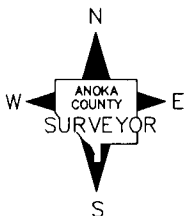
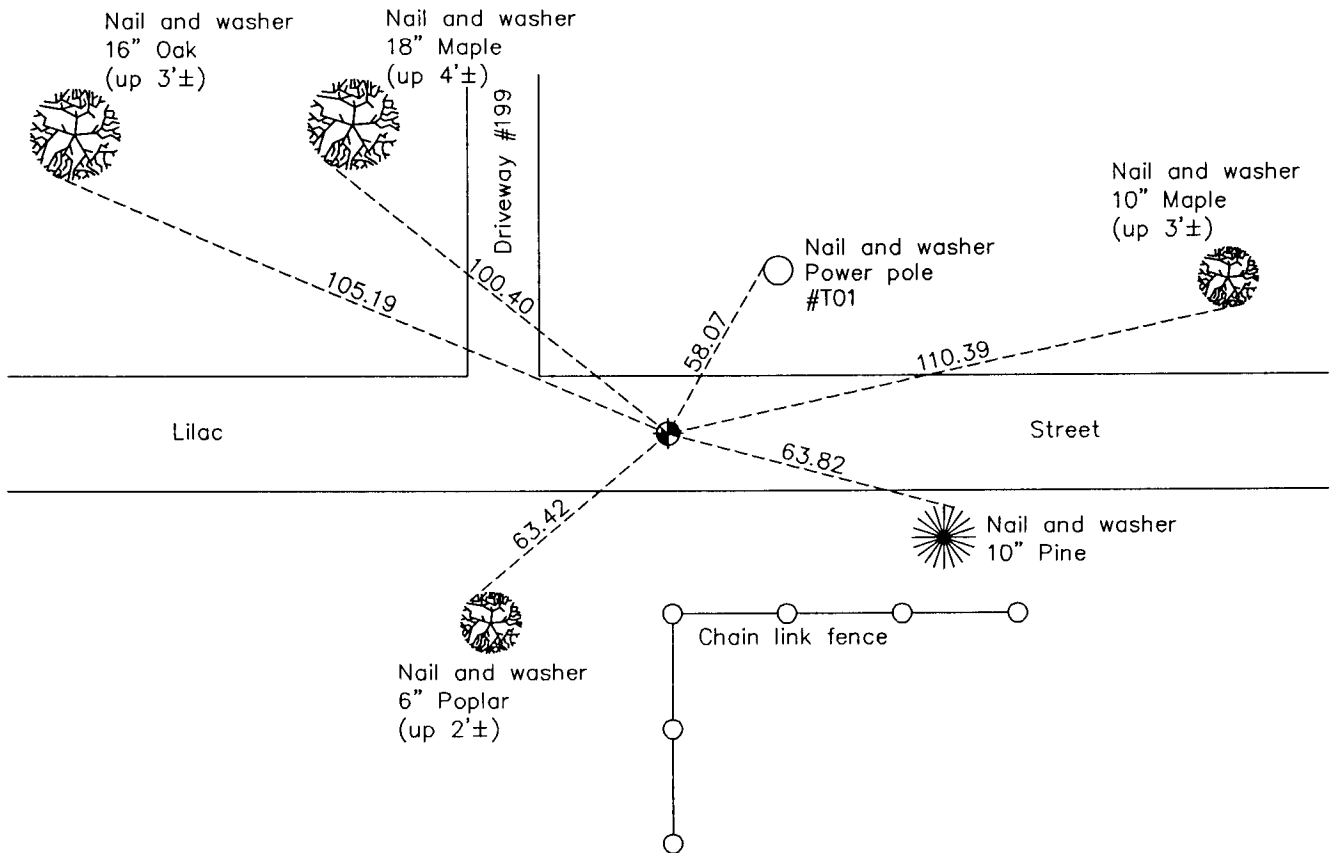

Revision Date  
12/17/12

N.A.D. 1983 Coordinates  
(1996 Adjustment)

County Project Coordinates	
Northing	153535.9976
Easting	534517.3514
Date	1/26/98

I hereby certify that this United States public land survey monument record is correct and complete to the best of my knowledge and belief.

*Larry D. Hoium* Date 12/17/12

Larry D. Hoium, Anoka County Surveyor

Minnesota License Number 18165