

CERTIFICATE OF LOCATION OF GOVERNMENT CORNER

County of Anoka

State of Minnesota

South 1/4 Corner of Sec. 5 Township 33 Range 24

On the 19th day of June, 1961, the described corner was evidenced by a 1/2" pinched iron pipe

and to perpetuate the location of said corner, at the exact location thereof, a permanent marker was placed consisting of a cast iron monument with a sign and post on the north side

AND on the 30th day of December, 2011, said permanent marker was found down 0.5'± and the ties were updated

Updated reference ties are as shown below.

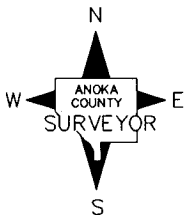
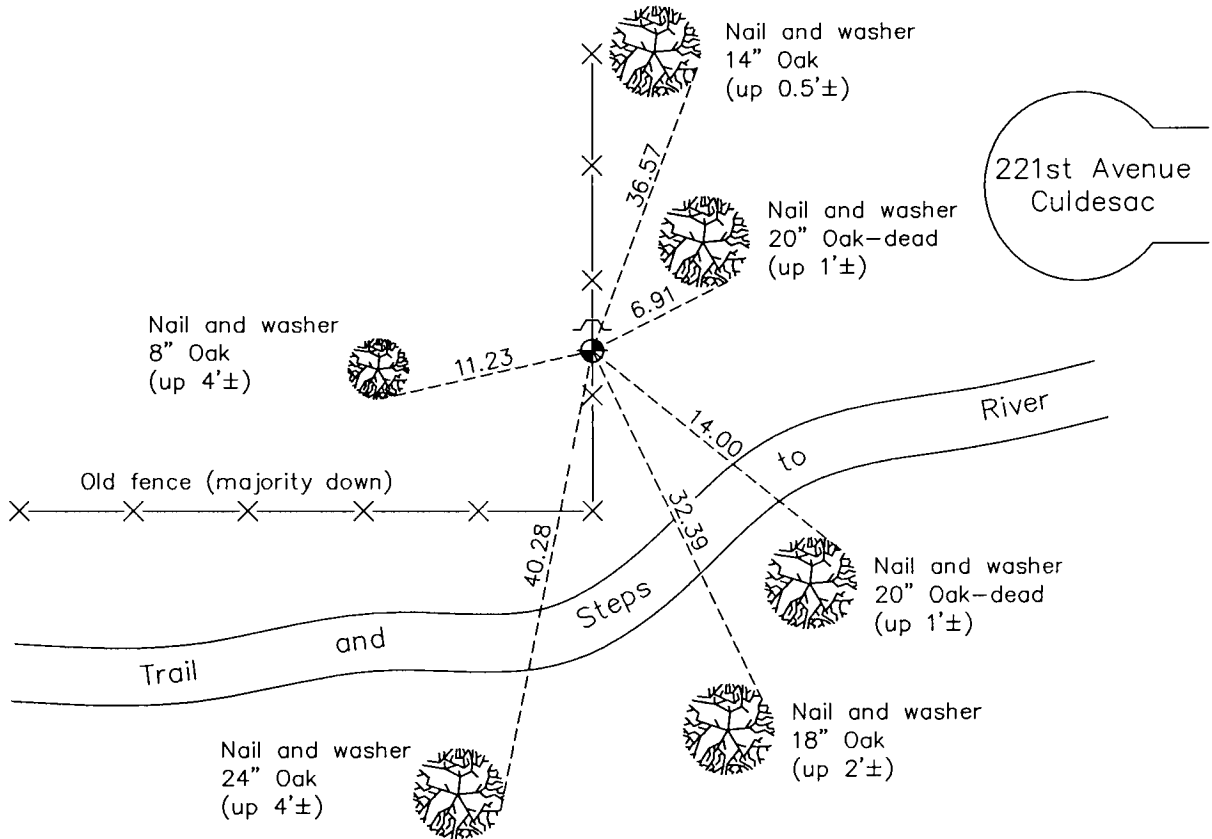

Revision Date
6/05/12

N.A.D. 1983 Coordinates
(1996 Adjustment)

County Project Coordinates	
Northing	<u>222292.4351</u>
Easting	<u>476553.7735</u>
Date	<u>4/27/01</u>

I hereby certify that this United States public land survey monument record is correct and complete to the best of my knowledge and belief.

Larry D. Hoium Date 6/05/12
 Larry D. Hoium, Anoka County Surveyor
 Minnesota License Number 18165