

CERTIFICATE OF LOCATION OF GOVERNMENT CORNER

County of Anoka

State of Minnesota

Northwest Corner of Sec. 8 Township 33 Range 24

On the 19th day of July, 1960, the described corner was evidenced by a concrete monument

and to perpetuate the location of said corner, at the exact location thereof, a permanent marker was placed consisting of a cast iron monument on top of the broken concrete monument with a sign and post on the east side

AND on the 30th day of December, 2011, said permanent marker was found down 0.3'± and the ties were updated

Updated reference ties are as shown below.

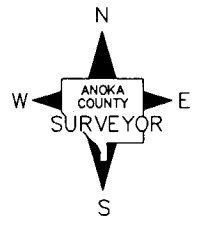
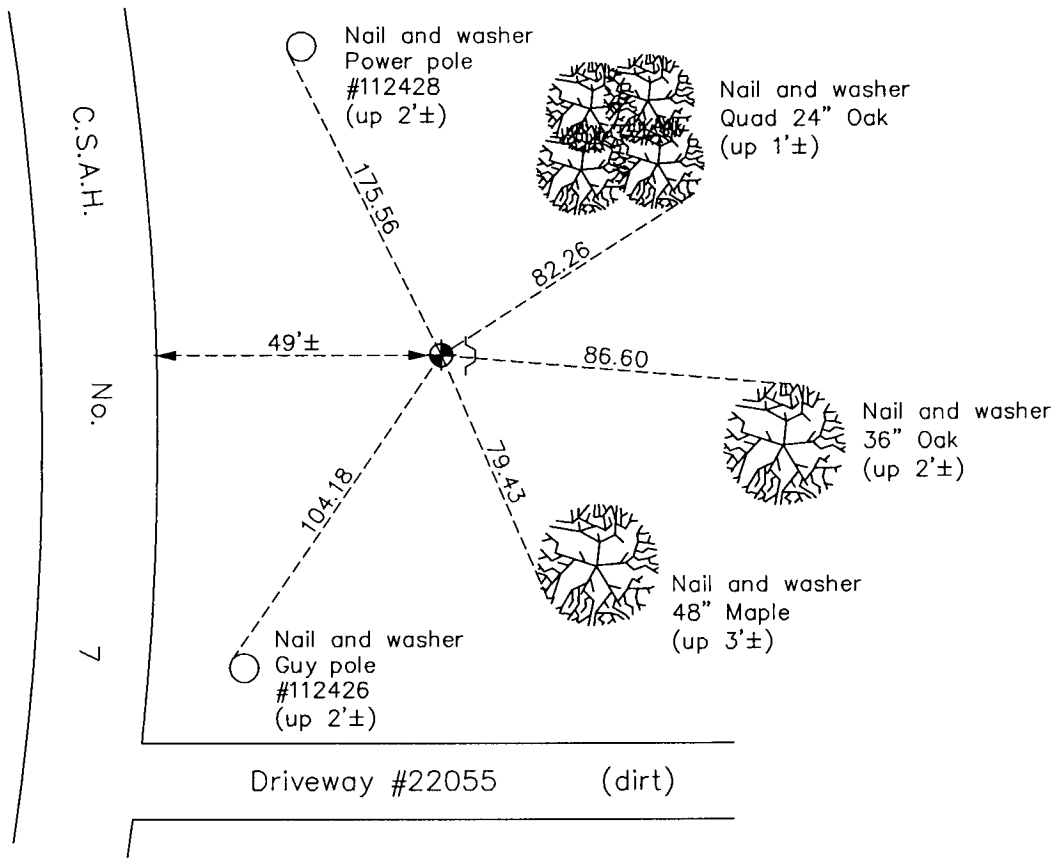

N.A.D. 1983 Coordinates
(1996 Adjustment)

County Project Coordinates	
Northing	<u>222327.3577</u>
Easting	<u>473925.5762</u>
Date	<u>3/29/01</u>

Revision Date
6/06/12

I hereby certify that this United States public land survey monument record is correct and complete to the best of my knowledge and belief.

Larry D. Hoium Date 6/06/12

 Larry D. Hoium, Anoka County Surveyor
 Minnesota License Number 18165