

# CERTIFICATE OF LOCATION OF GOVERNMENT CORNER

County of Anoka

State of Minnesota

## Witness Corner of Sec. 16 Township 33 Range 24

On the 22nd day of September, 1964, the described corner was evidenced by a large rock

and to perpetuate the location of said corner, at the exact location thereof, a permanent marker was placed consisting of a cast iron monument on top of rock

AND on the 20th day of December, 2011, said permanent marker was found down 1'± and the ties were updated

Updated reference ties are as shown below.

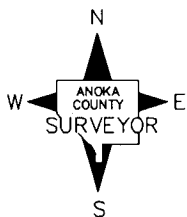
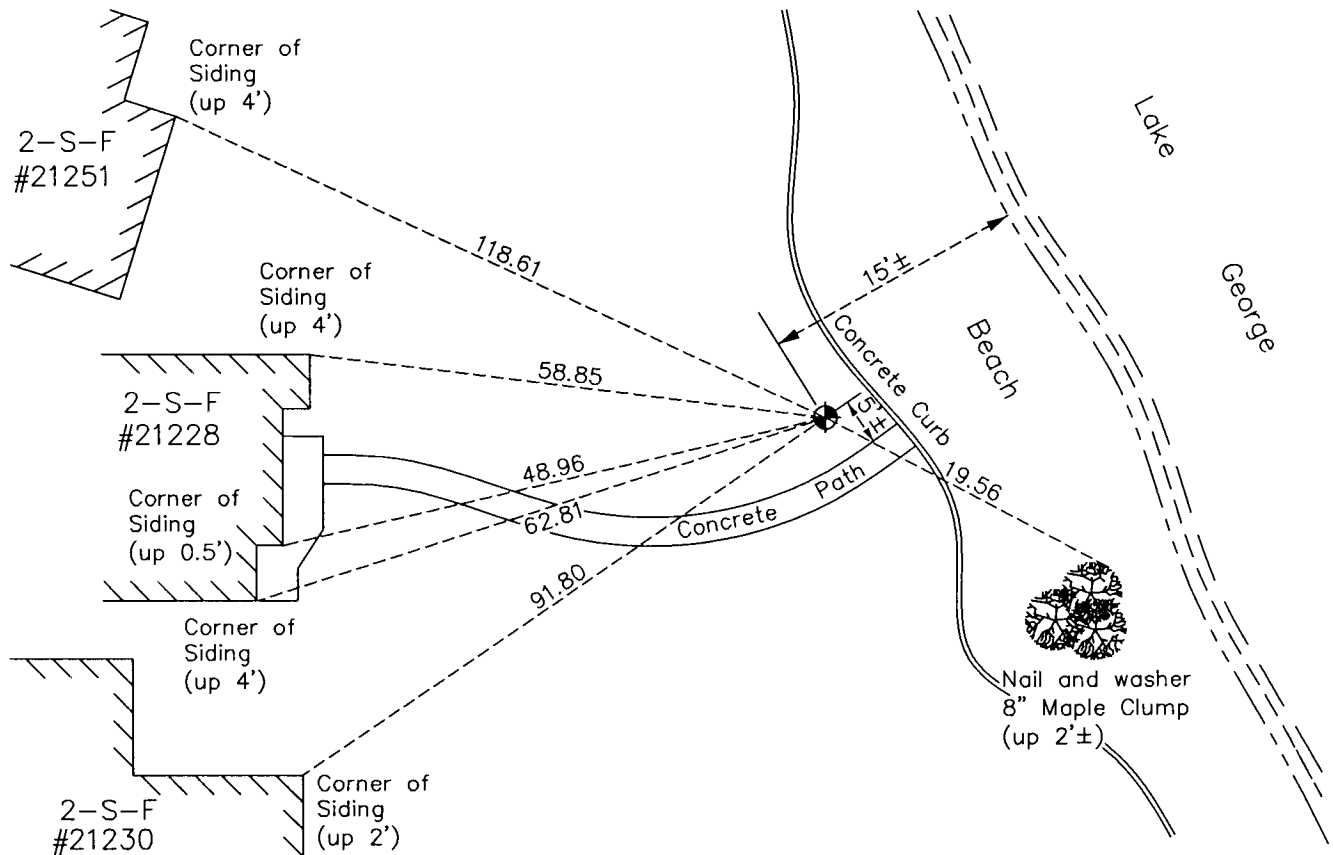

Revision Date  
6/12/12

N.A.D. 1983 Coordinates  
(1996 Adjustment)

County Project Coordinates	
Northing	<u>216581.8711</u>
Easting	<u>479149.8046</u>
Date	<u>6/11/01</u>

I hereby certify that this United States public land survey monument record is correct and complete to the best of my knowledge and belief.

*Larry D. Hoium* Date 6/12/12

\_\_\_\_\_  
Larry D. Hoium, Anoka County Surveyor

Minnesota License Number 18165