

# CERTIFICATE OF LOCATION OF GOVERNMENT CORNER

County of Anoka

State of Minnesota

## East 1/4 Corner of Sec. 13 Township 33 Range 24

On the 31st day of August, 1970, the described corner was evidenced by area resurvey

and to perpetuate the location of said corner, at the exact location thereof, a permanent marker was placed consisting of a cast iron monument with a sign and post on the north side

AND on the 14th day of September, 2011, said permanent marker was found 0.5'± above ground and the ties were updated

Updated reference ties are as shown below.

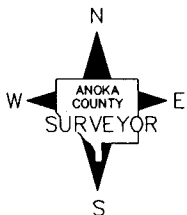
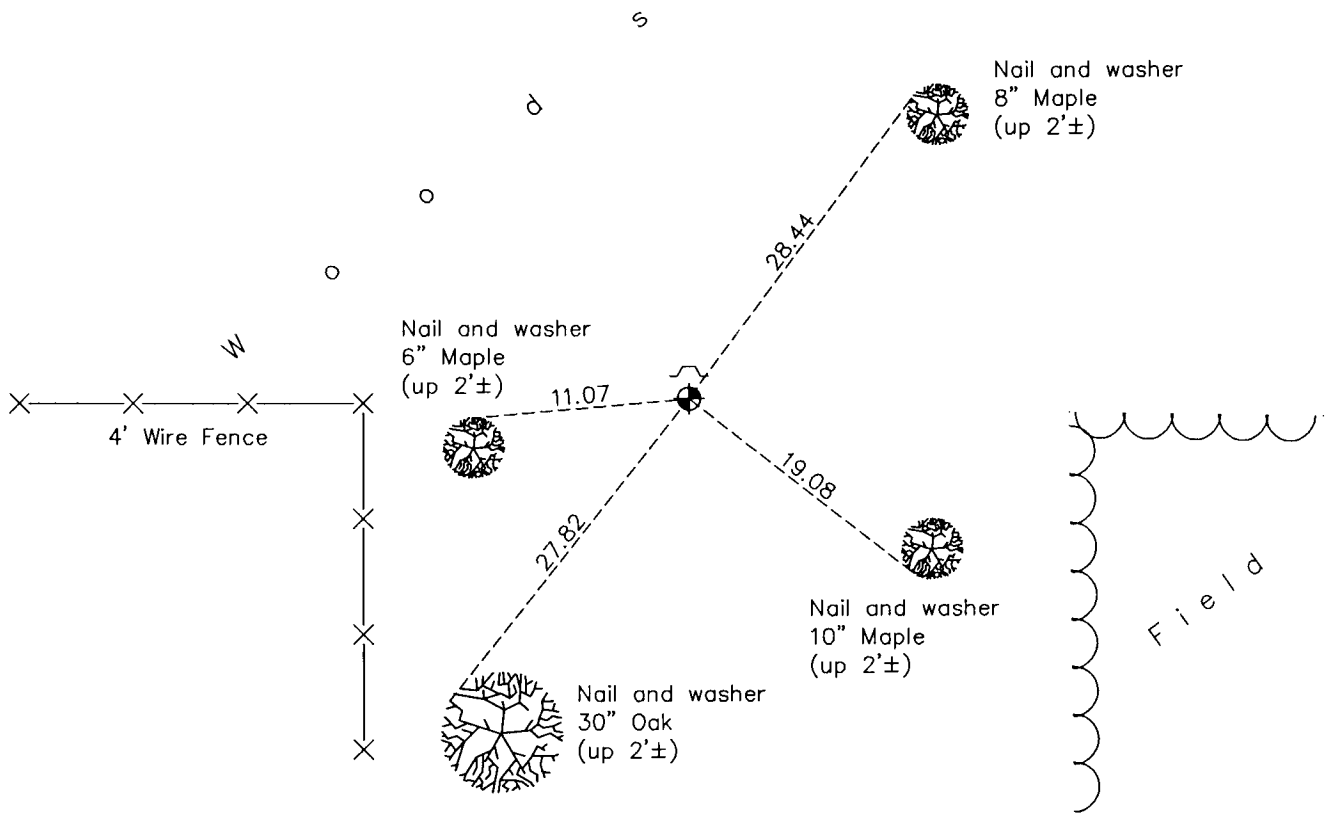

Revision Date  
12/14/11

N.A.D. 1983 Coordinates  
(1996 Adjustment)

County Project Coordinates	
Northing	214339.0348
Easting	500242.0715
Date	5/15/01

I hereby certify that this United States public land survey monument record is correct and complete to the best of my knowledge and belief.

*Larry D. Hoium*      Date 12/14/11

Larry D. Hoium, Anoka County Surveyor  
Minnesota License Number 18165