

CERTIFICATE OF LOCATION OF GOVERNMENT CORNER

County of Anoka

State of Minnesota

West 1/4 Corner of Sec. 19 Township 33 Range 24

On the 22nd day of July, 1960, the described corner was evidenced by a concrete monument

and to perpetuate the location of said corner, at the exact location thereof, a permanent marker was placed consisting of the same concrete monument with a sign and post on the south side

AND on the 23rd day of January, 2012, said permanent marker was found and the ties were updated

Updated reference ties are as shown below.

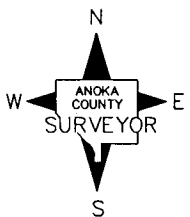
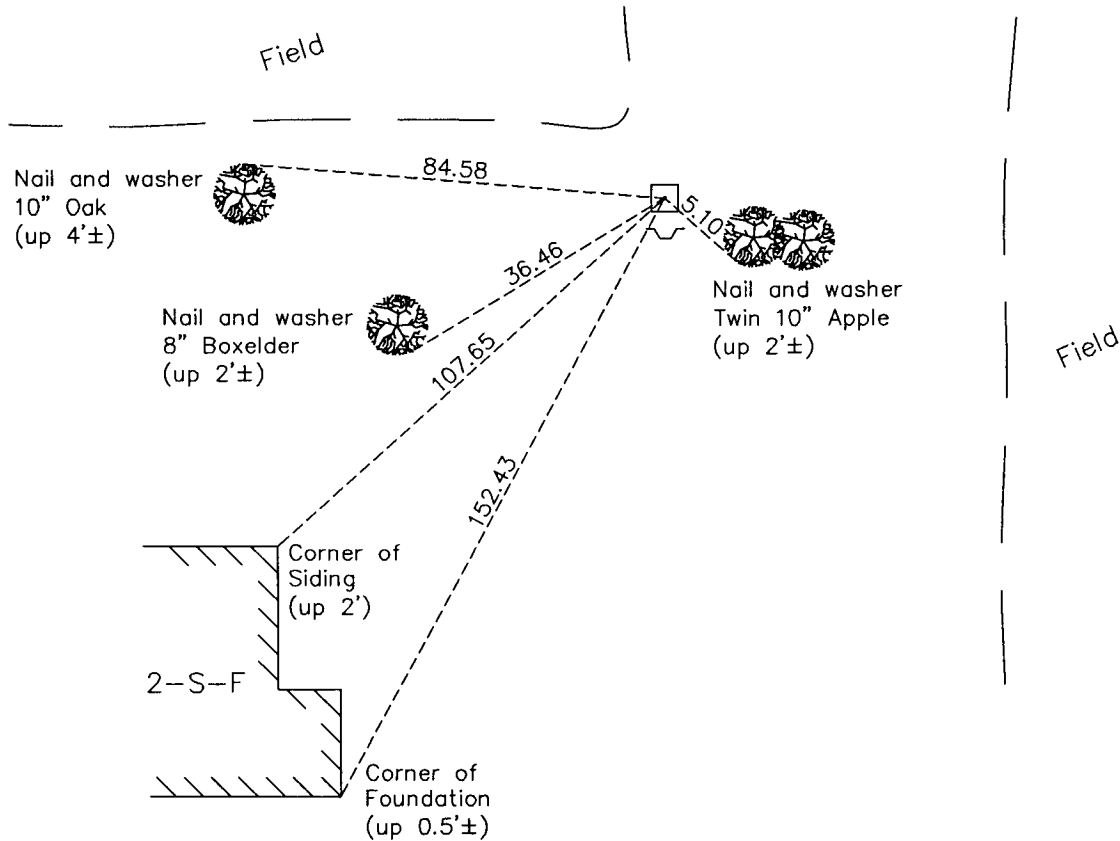

N.A.D. 1983 Coordinates
(1996 Adjustment)

County Project Coordinates	
Northing	<u>209281.8305</u>
Easting	<u>468642.0424</u>
Date	<u>11/07/01</u>

Revision Date
6/14/12

I hereby certify that this United States public land survey monument record is correct and complete to the best of my knowledge and belief.

Larry D. Hoium Date 6/14/12

Larry D. Hoium, Anoka County Surveyor

Minnesota License Number 18165